

SURVEY FOR BERNARD BIERNIER

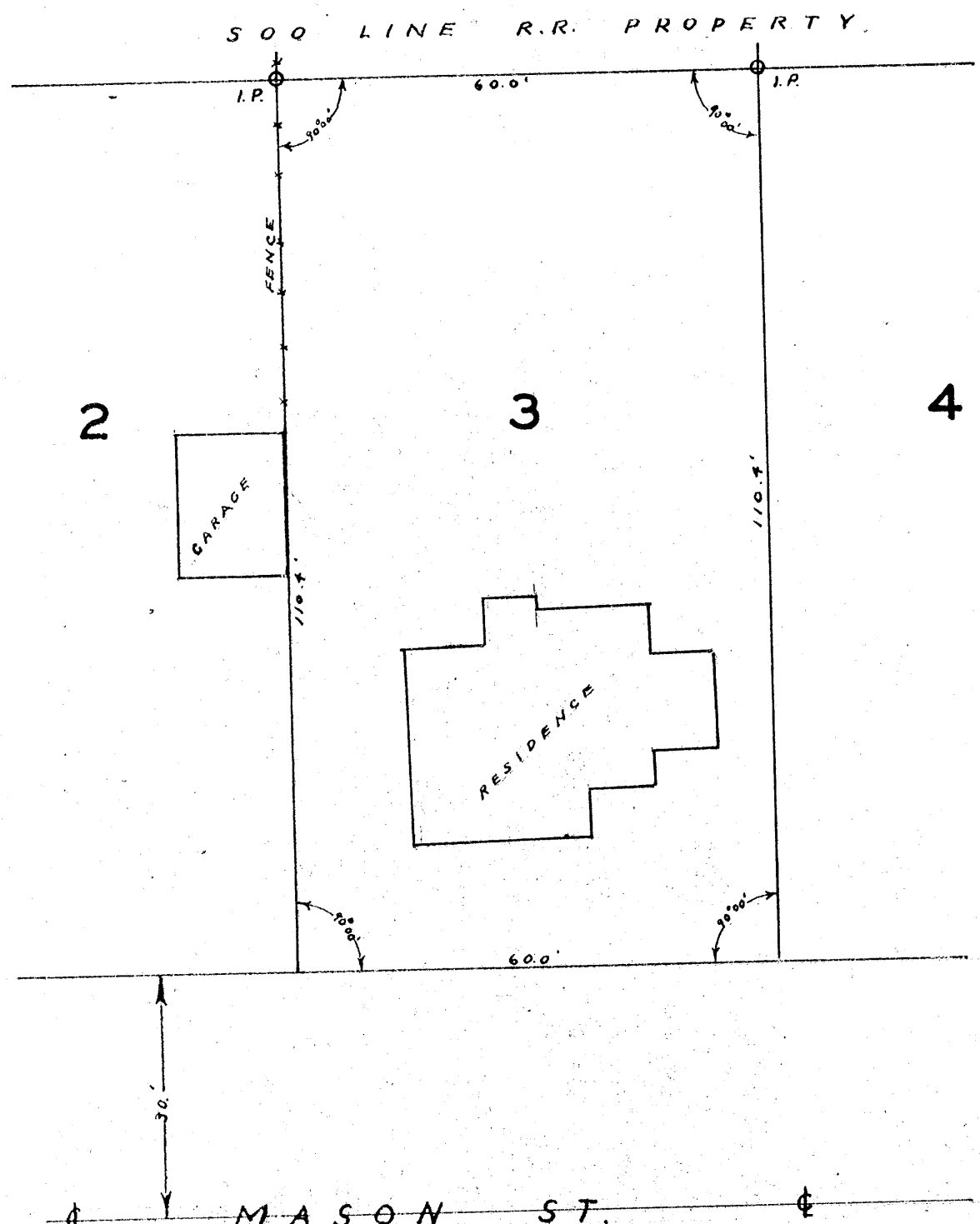

SURVEYOR'S CERTIFICATE

I, SY. M. POSKIE, REGISTERED WISCONSIN LAND SURVEYOR, RHINELANDER, WIS, DO HEREBY CERTIFY THAT I HAVE SURVEYED LOT 3, BLOCK 3, OF S. H. ALBANS ADDITION TO THE CITY OF RHINELANDER, ONEIDA COUNTY, WISCONSIN.

I FURTHER CERTIFY THAT I PERFORMED SAID SURVEY BY ORDER OF BERNARD BIERNIER, RHINELANDER, WIS; AND THAT THE WITHIN MAP IS A CORRECT REPRESENTATION OF THE LOT SURVEYED AND OF BUILDING THEREON.

DATED AT RHINELANDER, WISCONSIN, THIS 3RD DAY OF FEBRUARY 1956.

Sy. M. Poskie
SY. M. POSKIE

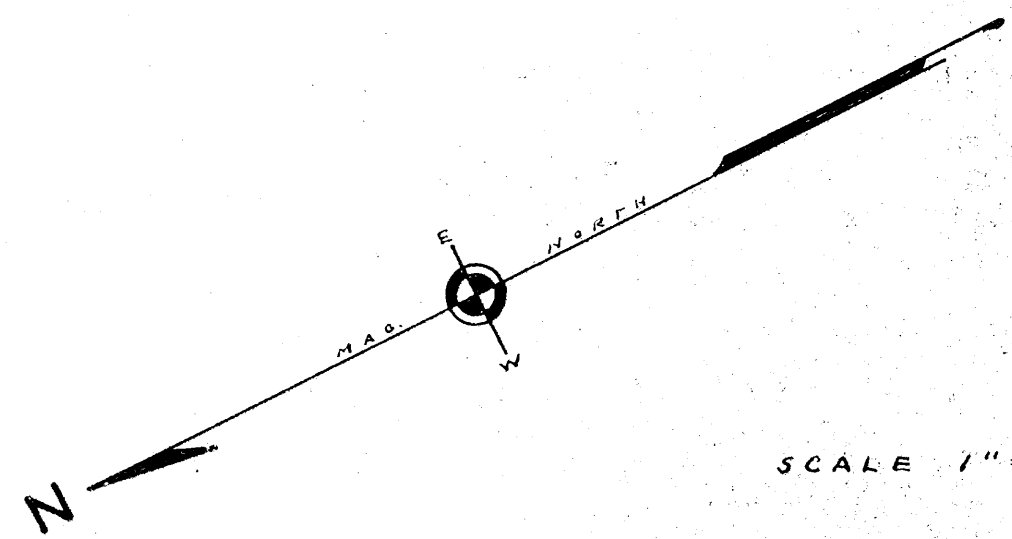

SCALE 1" = 20'

RECEIVED & FILED # 4509
 Oneida County Surveyor's Office
 Date: JUL 25 1960
 By: *RP*
 OCS Area # 0