

Cur N. Sec. line 51.69' - Ave. Var. 2°11'E
 2630.9' W. to 1/4 - V. 0°38'E

1697.1
 1365.8
 3062.9' E 1/4 to MC

WP 45.27 E 49'
 W. 1/4 587 W. 11.6'

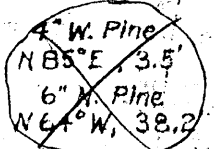

Magn. V. = 589-09 W ±
 " " checks 1° E ±

Meander Corner

16" N. Pine North, 2.4'
 14" N. Pine S. 16° W, 33.6'

Meander Corner
 S 88°-55' W 307.8'
 West 1/4 Cor in lake
 N 88°-51' W 2164.8'

N 88°-51' W

1697.1'

old fence

N 88°-51' W

1427.5'

61.7'

1365.8'

90-34

50°-35' W

200.0'

92-36

50°-35' W

400.0'

HIGHWAY

STATE

47

90-34

50°-35' W

400.0'

HIGHWAY

STATE

47

90-34

50°-35' W

400.0'

HIGHWAY

STATE

47

90-34

50°-35' W

400.0'

HIGHWAY

STATE

47

90-34

50°-35' W

400.0'

HIGHWAY

STATE

47

90-34

50°-35' W

400.0'

HIGHWAY

STATE

47

90-34

50°-35' W

400.0'

HIGHWAY

STATE

47

90-34

50°-35' W

400.0'

HIGHWAY

STATE

47

90-34

50°-35' W

400.0'

HIGHWAY

STATE

47

90-34

50°-35' W

400.0'

HIGHWAY

STATE

47

90-34

50°-35' W

400.0'

HIGHWAY

STATE

47

90-34

50°-35' W

400.0'

HIGHWAY

STATE

47

90-34

50°-35' W

400.0'

HIGHWAY

STATE

47

90-34

50°-35' W

400.0'

HIGHWAY

STATE

47

90-34

50°-35' W

400.0'

HIGHWAY

STATE

47

90-34

50°-35' W

400.0'

HIGHWAY

STATE

47

90-34

50°-35' W

400.0'

HIGHWAY

STATE

47

90-34

50°-35' W

400.0'

HIGHWAY

STATE

47

90-34

50°-35' W

400.0'

HIGHWAY

STATE

47

90-34

50°-35' W

400.0'

HIGHWAY

STATE

47

90-34

50°-35' W

400.0'

HIGHWAY

STATE

47

90-34

50°-35' W

400.0'

HIGHWAY

STATE

47

90-34

50°-35' W

400.0'

HIGHWAY

STATE

47

90-34

50°-35' W

400.0'

HIGHWAY

STATE

47

90-34

50°-35' W

400.0'

HIGHWAY

STATE

47

90-34

50°-35' W

400.0'

HIGHWAY

STATE

47

90-34

50°-35' W

400.0'

HIGHWAY

STATE

47

90-34

50°-35' W

400.0'

HIGHWAY

STATE

47

90-34

50°-35' W

400.0'

HIGHWAY

STATE

47

90-34

50°-35' W

400.0'

HIGHWAY

STATE

47

90-34

50°-35' W

400.0'

HIGHWAY

STATE

47

90-34

50°-35' W

400.0'

HIGHWAY

STATE

47

90-34

50°-35' W

400.0'

HIGHWAY

STATE

47

90-34

50°-35' W

400.0'

HIGHWAY

STATE

47

90-34

50°-35' W

400.0'

HIGHWAY

STATE

47

90-34

50°-35' W

400.0'

HIGHWAY

STATE

47

90-34

50°-35' W

400.0'

HIGHWAY

STATE

47

90-34

50°-35' W

400.0'

HIGHWAY

STATE

47

90-34

50°-35' W

400.0'

HIGHWAY

STATE

47

90-34

50°-35' W

400.0'

HIGHWAY

STATE

47

90-34

50°-35' W

400.0'

HIGHWAY

STATE

47

90-34

50°-35' W

400.0'

HIGHWAY

STATE

47

90-34

50°-35' W

400.0'

HIGHWAY

STATE

47

90-34

50°-35' W

400.0'

HIGHWAY

STATE

47

90-34

50°-35' W

400.0'

HIGHWAY