

SURVEY FOR WILLIAM A. LAMBELE

Part of Gov't. Lot 8, Section 25, T.37N., R.8E.
ONEIDA COUNTY, WISCONSIN

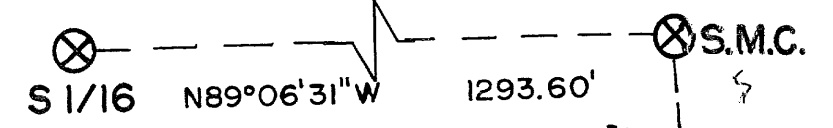

MAP # A 697
 DATE FILED MAY 02 1994
 BY [Signature]
 DESCRIPTION FILED
 ONEIDA CO. SURVEYOR'S OFFICE



VOL. 633, P. 648

N89°15'53"W
512.92'

P.O.B.

249.34'
S2°22'21"E

RIVER

3.071 Acres

VOL. 554, P. 235

N84°29'46"W
217.60'

S00°47'35"W
110.65'

South
80.00'

154.30'
N13°11'24"E

220.53'
N56°52'06"E

WISCONSIN

522.32'
S78°06'50"E

VOL. 514, P. 212

LEGEND

- ⊗ . Controlling Corners
- . Found Iron Pipes from Previous Surveys
- . Set Iron Pipes this Survey

SCALE: 1" = 50'
Bearings: Assumed



SURVEYORS AFFIDAVIT:

I, Milo E. Stefan, R.L.S. #1558, a licensed land surveyor in the State of Wisconsin, and at the request of William A. Lambele, have surveyed a part of the unrecorded plat located in Government Lot 8, Section 25, Township 37 North, Range 8 East of the 4th Principal Meridian and have marked the corners of the William A. Lambele property. This plat map is a correct representation of this parcel surveyed and marked to the best of my abilities.

Milo E. Stefan
 Milo E. Stefan, R.L.S. #1558

4/23/1994
 Date

STEFAN SURVEYORS

By: *MES*

Date: *4/23/94*