

1-1/2" iron pipe found

S85°31'32"E
3747.29'

MAP # **A0850**
 DATE FILED **NOV 06 1998**
 BY *[Signature]*
 DESCRIPTION FILED
 ONEIDA CO. SURVEYOR'S OFFICE

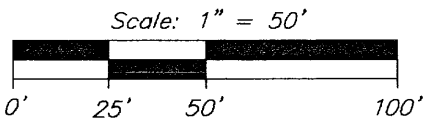

- = 3/4" iron pipe found
- ▲ = steel right-of-way post found
- = 3/4" iron pipe set
- () = previously recorded

Vol. 557

0.44 acres

S87°57'07"E
227.37'

p. 57

(N88°15'W, 200.13')
N87°57'07"W
200.21'

N5°45'25"E
193.56'

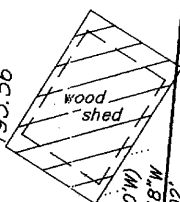

Vol. 307 D,
kennel

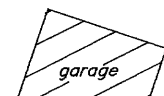

0.73 acres

p. 58

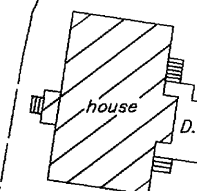

vent
vent

3/4" iron pipe:
N5°16'42"E, 1.22'
3/4" iron pipe:
S6°15'00"W, 1.29'
Tan. Brg. =
N84°13'08"W

Delta = 2°43'12"
Radius = 1859.88'

Vol. 1 SM,
-1-

p. 289

Bearings True

County

Highway

"D"

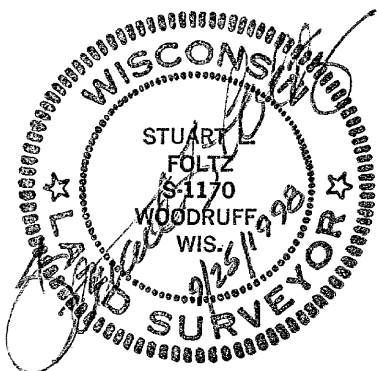

Part of
GOV'T. LOT 2
SECTION 20, T39N, R9E

Town of Sugar Camp
 Oneida County, Wisconsin

NOTE: All iron pipe diameters shown hereon are nominal dimensions.

I hereby certify to the present owner(s) and/or purchaser(s) of the property included in this survey, and to those who mortgage or guarantee title for the present owner(s) or purchaser(s) within one year from the date hereof, that this survey was performed in accordance with acceptable professional standards; that the survey data shown hereon is, to the best of my knowledge, information and belief, a true and accurate representation thereof; that any legal descriptions conforming to this survey have been provided on separate sheets; and that this survey was performed by order of William Hummel, Jr.

NOTE: 1) This survey is based on title information contained in Chicago Title Insurance Co. ALTA Commitment No. ON 2481B, effective June 2, 1998, issued by Oneida Title & Abstract, Inc. of Rhinelander, WI.
 2) The 0.44 acre parcel shown hereon does not meet the minimum requirements for a buildable parcel in Oneida County and must be conveyed to an adjoining parcel only.

Foltz and Associates, Inc.

Surveyors	Architects	Engineers
8612 Highway 51 North, Minocqua, Wisconsin 54548		
(715) 356-9485		
		fax (715) 356-1841

C. Winkler