

REVISIONS

C-16796

RECEIVED & FILED #51157
Oneida County Surveyor's Office
Date.....
By.....
OCS Area #.....

DATE: 1-4-83
SCALE: 1" = 100'
C-16796

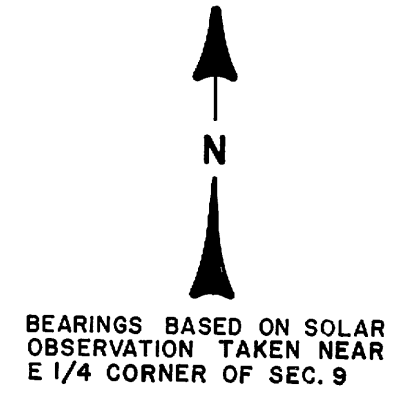

I, Elton A. Petersen, Registered Land Surveyor, hereby certify:

That I have surveyed and mapped a parcel of Land being a part of the Northeast one-quarter of the Southeast one-quarter (NE $\frac{1}{4}$ - SE $\frac{1}{4}$) of Section Nine (9) Township Thirty-six (36) North, Range Nine (9) East of the Fourth Principal Meridian, Town of Pelican, Oneida County, Wisconsin described as follows:

Beginning at a 4" x 4" x 36" concrete monument set on the East-West one-quarter line of Section 9, Township 36 North, Range 9 East, said monument being North 89°37'18" West (Rec. as North 89°35' West) 967.36 feet from the East quarter corner of said Section 9. Thence South 0°52'58" East parallel with the west line of the Northeast quarter of the Southeast quarter of said Section 9, a distance of 660.00 feet to a 4" x 4" x 36" concrete monument set. Thence North 89°37'18" West parallel with said quarter line 616.98 feet to a 4" x 4" x 36" concrete monument set in the East right-of-way line of Faust Lake Road. Thence continuing North 89°37'18" West 43.02 feet to a No. 5 rebar set on the west line of said Northeast one-quarter of the Southeast one-quarter. Thence North 0°52'58" West along the said West line, 415.00 feet to a railroad spike set. Thence South 89°37'18" East parallel with the said quarter line 39.86 feet to a point on the East right-of-way line of Faust Lake Road, said point witnessed by a 4" x 4" x 36" concrete monument set 1.00 feet South. Thence continuing South 89°37'18" East and parallel with said quarter line, 165.14 feet to a 4" x 4" x 36" concrete monument set. Thence North 0°52'58" West parallel with said West line 245.00 feet to a 4" x 4" x 36" concrete monument set on the East-West quarter line of said Section 9, thence South 89°37'18" East along said East-West quarter line 455.00 feet to the place of beginning.

Containing 8.84 acres.

Subject to use by the public for road purposes, 0.39 acres along the Westerly side of the described parcel lying within the right-of-way of Faust Lake Road.

Reserving unto the grantor, an easement for ingress and egress across the Southerly 33.00 feet.

That I have surveyed and mapped said land by order of the Wisconsin Public Service Corporation; that I have fully complied with all the requirements of the related sections of the Wisconsin Statutes and the Wisconsin Administrative Code in surveying and mapping the same; that the survey and map is correct to the best of my knowledge and belief.

Dated: January 7, 1983

Elton A. Petersen
Elton A. Petersen S-1304

DRAWN BY: T.R.F.	WISCONSIN PUBLIC SERVICE CORPORATION.
TRACED BY:	HODAG SUBSTATION SITE
CHECKED BY: <i>EAP</i>	PART OF THE NE 1/4-SE 1/4, SEC. 9, T.36N.-R.9E.
APPROVED BY:	TOWN OF PELICAN, COUNTY OF ONEIDA, STATE OF WISCONSIN

SW-NE
KOFFARDS
SUBDIVISION
VOL. 8 PAGE 14

SE-NE
UNPLATTED LANDS

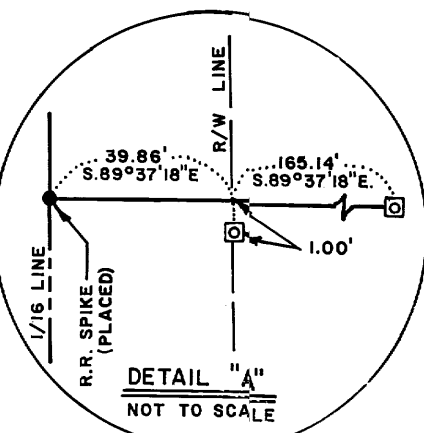

UNPLATTED LANDS

NW-SE

NE-SE

UNPLATTED LANDS

1/16 CORNER
2" x 30" IRON PIPE
(PLACED ACCORDING
TO DATA SUPPLIED
BY GENISOT &
ASSOC.)

LEGEND

- 2" IRON PIPE - FOUND, UNLESS OTHERWISE NOTED
- ◻ 4" x 4" x 36" CONC. MON./AL. CAP - PLACED, UNLESS OTHERWISE NOTED

REFERENCE:
DRAWING SHOWING SUBDIVISION OF THE SE 1/4 OF SECTION 9,
T.36N.-R.9E., BY GENISOT & ASSOCIATES, INC.

PLAT OF KOFFARDS SUBDIVISION, ONEIDA CO. RECORDS

