

TOWNSHIP NO. 36 NORTH, RANGE NO. 8 EAST, FOURTH PRINCIPAL MERIDIAN, WISCONSIN.

DEPENDENT RESURVEY AND EXTENSION SURVEY, SECTIONS 16 AND 21.

B 1745

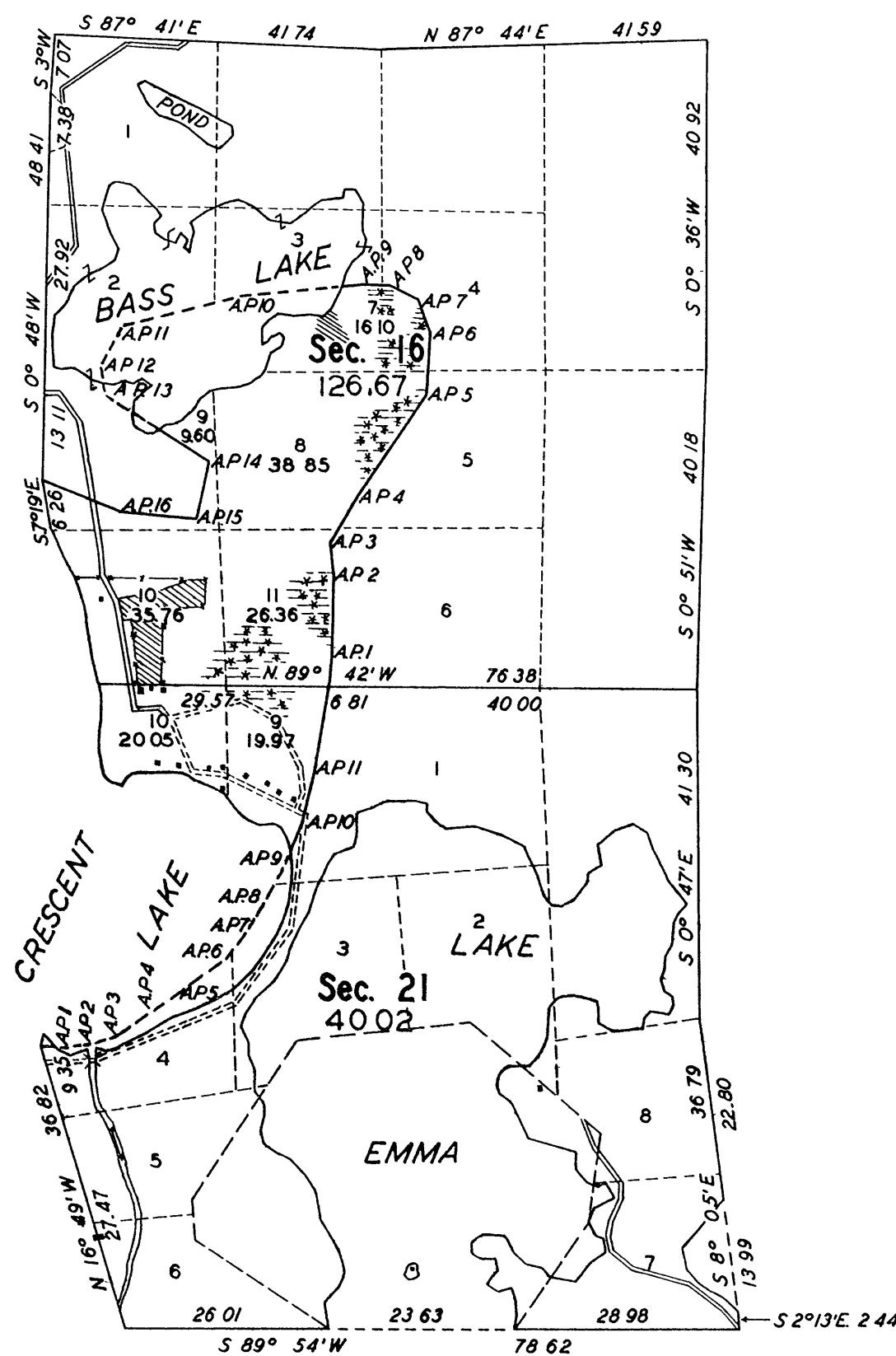

MEMORANDUM

THIS PLAT DELINEATES A RETRACEMENT AND REESTABLISHMENT OF THE LINES DEFINING LANDS IN SECS 16 AND 21, T 36 N. R. 8 E., AS SHOWN UPON THE TOWNSHIP PLAT APPROVED MARCH 18 1864, IN THEIR TRUE ORIGINAL POSITIONS ACCORDING TO THE BEST AVAILABLE EVIDENCE OF THE POSITION OF THE ORIGINAL CORNERS, AND AN EXTENSION SURVEY INCLUDING LANDS IN SECS 16 AND 21 WHICH WERE ERRONEOUSLY OMITTED FROM THE ORIGINAL SURVEY AND NOT SHOWN ON SAID PLAT

THE POSITION OF THE ORIGINAL RECORD MEANDER COURSES OF CRESENT LAKE IN SECS 16 AND 21 IS SHOWN BY AN IRREGULAR LINE WITH NUMBERED ANGLE POINTS THE MEANDER COURSES AS THUS ORIGINALLY REPORTED WERE GROSSLY IN ERROR, AND WITH THE EXCEPTION OF THE COURSES FALLING IN THE WATER HAVE THEREFORE BEEN MARKED AS A FIXED BOUNDARY, WITH THE DIRECTIONS AND LENGTHS OF THE SEVERAL COURSES ADJUSTED TO THE RECORD OF THE ORIGINAL SURVEY

THE SURVEY WAS EXECUTED PURSUANT TO AUTHORITY CONTAINED IN GENERAL LAND OFFICE LETTER 1754153 "E" DATED MAY 9, 1939, WHICH BEAR DEPARTMENTAL APPROVAL UNDER DATE OF MAY 25, 1939

THE VIRGIN TIMBER ON THE UPLAND IN SEC 16 HAS BEEN CUT AND A GROWTH OF YOUNG POPLAR, BIRCH, OAK, MAPLE, AND PINE HAS TAKEN ITS PLACE MOST OF THE VIRGIN TIMBER IN SEC 21 IS STILL STANDING AND CONSISTS OF HEMLOCK, BIRCH, PINE, MAPLE, POPLAR, AND OAK. THE TIMBER FOUND IN THE SWAMPS IS MOSTLY SPRUCE, TAMARACK, BALSAM, AND SOME CEDAR

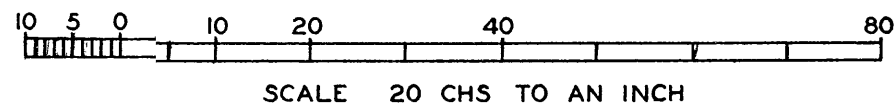

AREA SURVEYED 166.69 ACRES
AREA RESURVEYED 892.40 ACRES

LINES DESIGNATED	BY WHOM SURVEYED	GROUP		MILEAGE		WHEN SURVEYED	
		NO	DATE	MLS	CHS	BEGUN	COMPLETED
EXTERIOR	HAL D CRAIG, SURVEYOR LESTER S. MANN, PUBLIC LAND SUR	47	JULY 26, 1939	12	22 82	SEPT 18, 1939	OCTOBER 14, 1939
SUBDIVISIONAL				6	50 54		
MEANDERS				2	47 77		
MISCELLANEOUS							

OFFICE OF THE SUPERVISOR OF SURVEYS
DENVER, COLORADO, JAN. 29, 1940

THE ABOVE PLAT OF SECTIONS 16 AND 21, TOWNSHIP NO. 36 NORTH, RANGE NO. 8 EAST, OF THE FOURTH PRINCIPAL MERIDIAN, WISCONSIN IS STRICTLY CONFORMABLE TO THE FIELD NOTES OF THE SURVEY THEREOF WHICH HAVE BEEN EXAMINED AND APPROVED.

David L. Johnson
SUPERVISOR OF SURVEYS

UNITED STATES
DEPARTMENT OF THE INTERIOR
GENERAL LAND OFFICE

WASHINGTON, D.C., MAY 18, 1940

THE SURVEY REPRESENTED BY THIS PLAT HAVING BEEN CORRECTLY EXECUTED IN ACCORDANCE WITH THE REQUIREMENTS OF THE LAW AND THE REGULATIONS OF THIS OFFICE, IS HEREBY ACCEPTED

Earl David Wolf
ACTING ASSISTANT COMMISSIONER