

"PICNIC ISLAND"

as shown on COUNTRY CLUB MANOR PLAT
SECTION 31 TOWNSHIP 37 NORTH RANGE 9 EAST
ONEIDA COUNTY WISCONSIN

BASS
LAKE

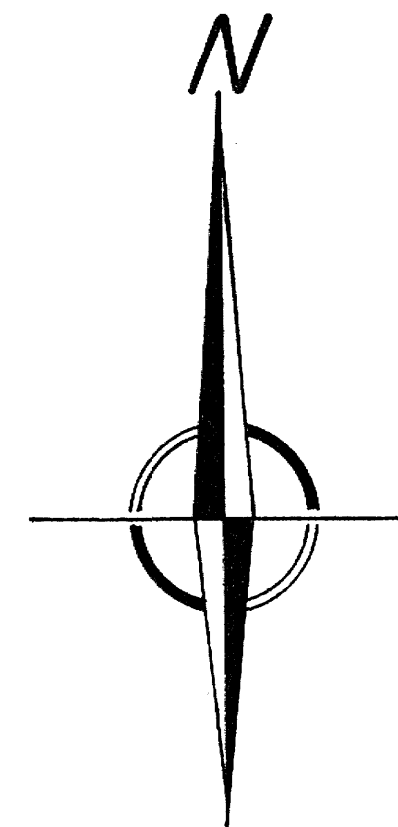
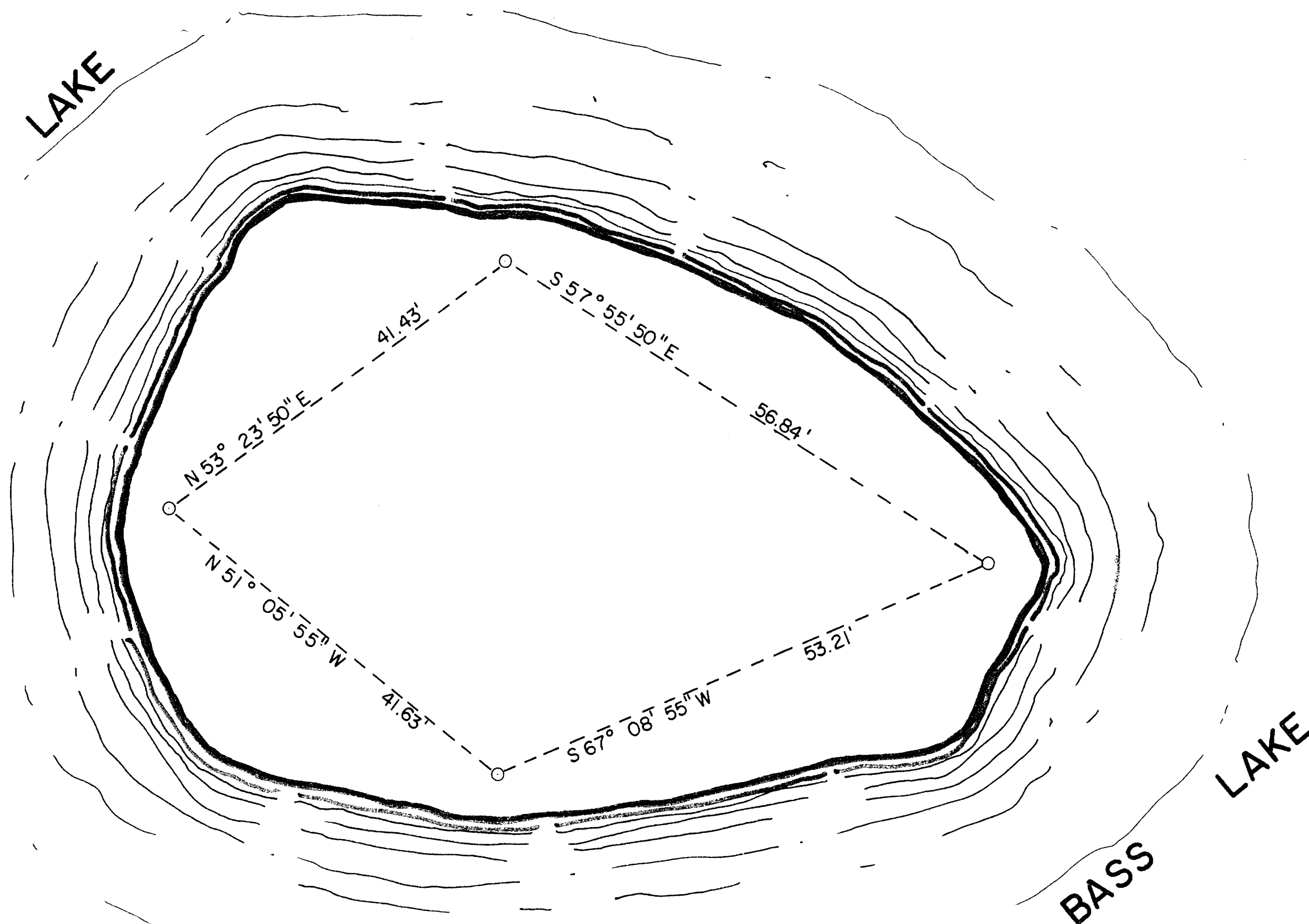

SURVEYORS CERTIFICATE

I HEREBY CERTIFY THAT I HAVE SURVEYED THE ABOVE PARCEL OF LAND UNDER THE DIRECTION OF MR. JOHN SAARI, AND THAT THE ABOVE MAP IS A TRUE AND CORRECT REPRESENTATION OF THE LANDS SURVEYED TO THE BEST OF MY BELIEF AND KNOWLEDGE.

William G. Immich
WILLIAM IMMICH

MARCH 27, 1984
DATE

○ SET 1"X 24" IRON PIPE

RECEIVED & FILED # B217
Oneida County Surveyor's Office
Date JAN 28 1988
By M.A.R.
OCS Area #

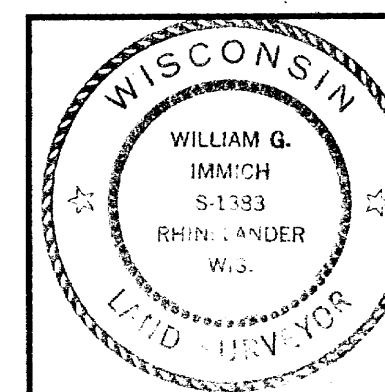

NORTHWOODS UNITED
WAY
Rhinelander Wisconsin

SCALE 1" = 10' DATE 3/27/84 DWN. BY WI

DWG. NO. 7486 GENISOT AND ASSOCIATES, INC.
RHINELANDER, WIS.