

B2389

RECEIVED & FILED #
Oneida County Surveyor's Office
Date	MAR 04 1992
By	<i>[Signature]</i>
OCS Area #

**LOCATED IN GOV'T LOT 7, SECTION 22, T 36 N, R 9 E,
TOWN OF PELICAN, ONEIDA COUNTY, WISCONSIN**

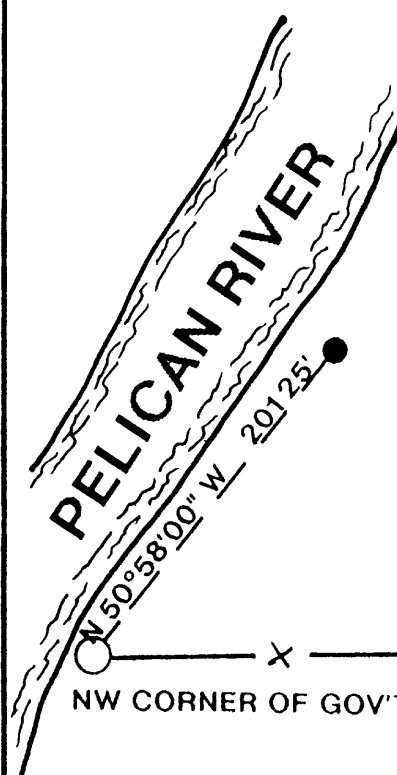

OLD BARBED WIRE FENCE ON LINE

S 00°14'15" W 2144.32'
(2142.46')

SW CORNER OF GOV'T LOT 7

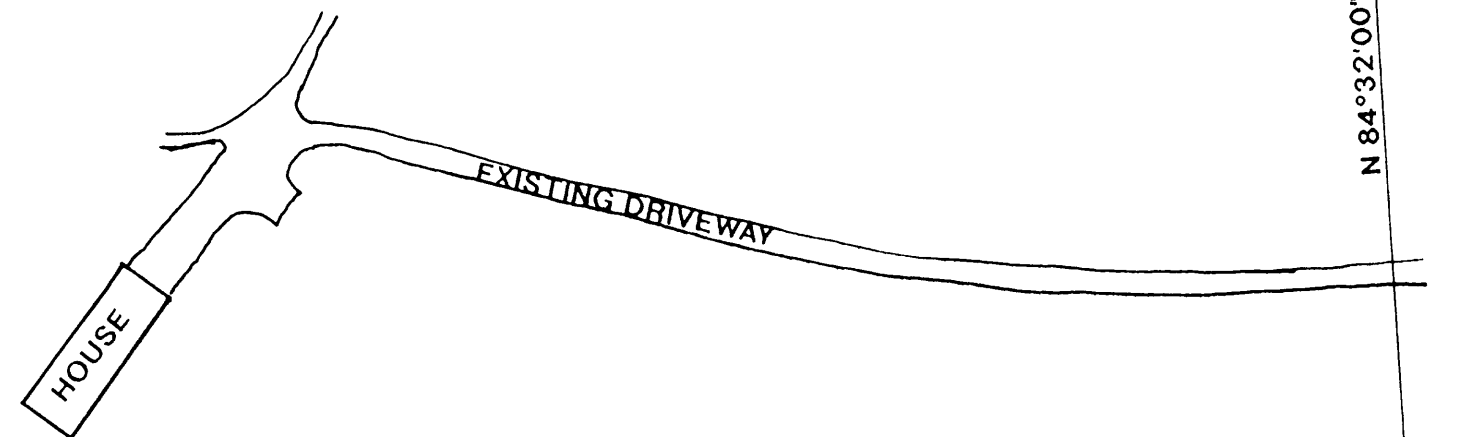

LEGEND:

- FOUND 1" IRON PIPE
- FOUND 1" CAPPED RIPCO MONUMENT
- ⊙ FOUND 2" RIPCO MONUMENT
- () RECORDED AS

I, WILLIAM E. BANDOW, HEREBY CERTIFY THAT I HAVE SURVEYED THE ABOVE LINE UNDER THE DIRECTION OF LUCY NEFSTEAD AND THAT THE ABOVE MAP IS A TRUE AND CORRECT REPRESENTATION OF THE LANDS SURVEYED TO THE BEST OF MY KNOWLEDGE AND BELIEF THAT I HAVE COMPLIED WITH THE PROVISIONS OF AE 7 OF THE WISCONSIN ADMINISTRATIVE CODE

William E. Bandow 2-5-92
WILLIAM E. BANDOW DATE

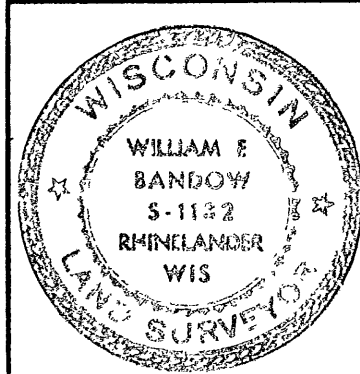

SURVEY FOR
LUCY NEFSTEAD
2464 BERGMAN ROAD
RHINELANDER, WISCONSIN

SCALE 1" = 100' DATE 2/5/92 DWN BY RB
DWG. NO. **9126** GENISOT AND ASSOCIATES, INC.
RHINELANDER, WIS.

B2389

B2389

B2389