

MAP #	B 2 7 9 3
DATE FILED	SEP 16 1993
BY	GP
DESCRIPTION FILED	
ONEIDA CO	SURVEYOR'S OFFICE

N

BEARINGS REFERENCED TO THE WEST LINE SECTION 17 ASSUMED TO BEAR N 01°17'37" W



# LINE BETWEEN SECTIONS 17 & 18 T36N R8E TOWN OF CRESCENT, ONEIDA CO. WI.

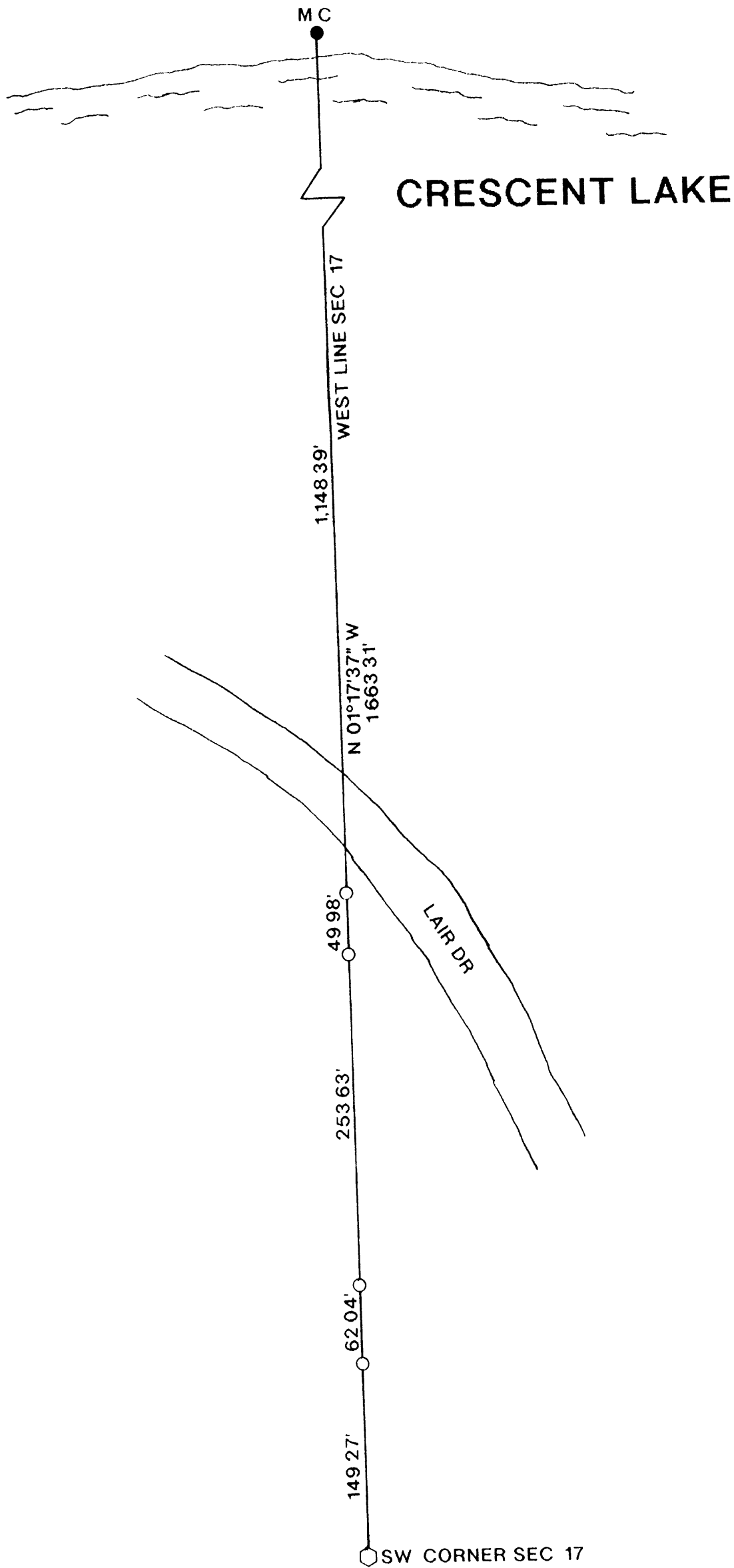

## LEGEND:

- SET 1"X 24" IRON PIPE
- FOUND 1 1/2" IRON PIPE
- FOUND MONUMENT

I, WILLIAM E. BANDOW, HEREBY CERTIFY THAT I HAVE SURVEYED THE ABOVE LINE UNDER THE DIRECTION OF CATHY SOMMER AND THAT THE ABOVE LINE IS A TRUE AND CORRECT REPRESENTATION OF THE LINE SURVEYED TO THE BEST OF MY KNOWLEDGE AND BELIEF. THAT I HAVE COMPLIED WITH THE PROVISIONS OF AE 7 OF THE WISCONSIN ADMINISTRATIVE CODE

*William E. Bandow* 9-13-93  
WILLIAM E. BANDOW DATE

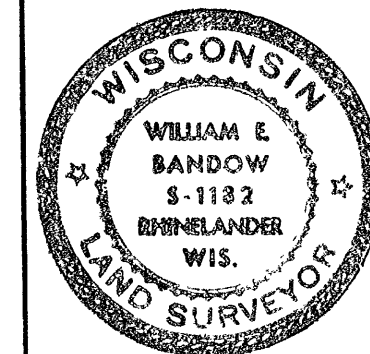

SURVEY FOR  
**CATHY SOMMER**

SCALE 1"= 100'	DATE 8/27/93	DWN BY JB
DWG NO. <b>9259</b>	<b>GENISOT AND ASSOCIATES, INC.</b> RHINELANDER, WIS	