

MAP # B3660
DATE FILED JUL 03 1997
BY
DESCRIPTION FILED
ONEIDA CO. SURVEYOR'S OFFICE

Minocqua

Lake

Bearings Assumed

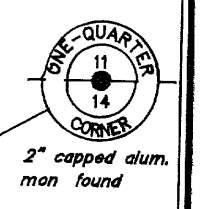
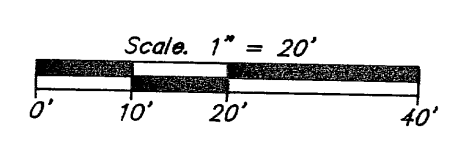

Vol. 662 Rec.

Vol. 662 Rec.

Vol. 274 D.

P. 315

P. 333

P. 331

0.33 Acres

Shore

Drive

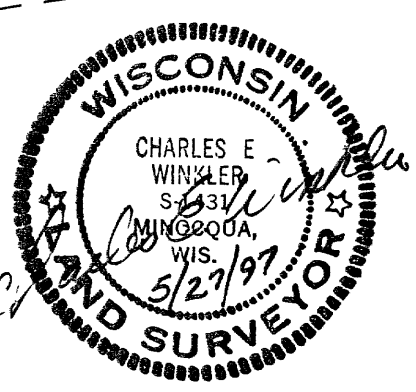

Part of
HENRY C. PAYNE TRUSTEE'S SECOND ADDITION
TO MINOCQUA

in
GOV'T. LOT 4
SECTION 14, T39N, R6E

Town of Minocqua
Oneida County, Wisconsin

I hereby certify to the present owner(s) and/or purchaser(s) of the property included in this survey, and to those who mortgage or guarantee title for the present owner(s) or purchaser(s) within one year from the date hereof, that this survey was performed in accordance with acceptable professional standards, that the survey data shown hereon is, to the best of my knowledge, information and belief, a true and accurate representation thereof; that any legal descriptions conforming to this survey have been provided on separate sheets, and that this survey was performed by order of Robert C. Saundras and Mary Saundras

- = 2" iron pipe found
- = 1" iron rod found
- = 1" iron pipe found
- () = previously recorded

Foltz and Associates, Inc.
Surveyors Architects Engineers
8812 Highway 51 North, Minocqua, Wisconsin 54548
(715) 356-9485 fax (715) 356-1841
C. Winkler 4-14-396

B3660

B3660

B3660