

MAGNETIC NORTH

NE COR BLOCK 7

MAP # B3712  
DATE FILED SEP 17 1997  
BY *JB*  
DESCRIPTION FILED  
ONEIDA CO. SURVEYOR'S OFFICE

# Survey of Lot Line 9&10 of Block 7 of The Village of Woodboro,

Located in part of the S ½, sec. 13,  
T.36N., R.7E., Oneida County, WI.

I, Todd Loftus, Registered Land Surveyor, hereby certify that I have surveyed the property shown hereon. That this map represents an accurate survey of said property to the best of my knowledge & belief. That I have performed this survey by order of Tom Montague and that I have complied with the applicable requirements of the Wisconsin Administrative Code Chapter E.7.

Description required for above parcel is on separate sheet.

DATE **6/6/97**

SIGNED *Todd P. Smith*

LOFIUS SURVEYING

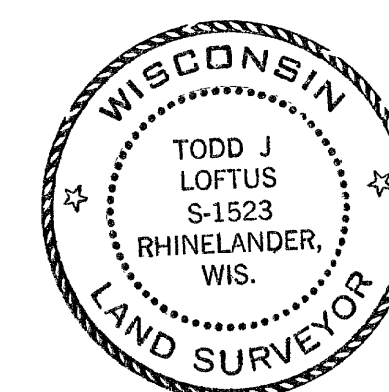

### LEGEND

- 1" IRON PIPE FOUND
- 1 1/2" IRON PIPE SET
- FOUND ROTTED OUT IRON PIPE & PERPETUATED WITH A SET 1 1/2" IRON PIPE

( INFORMATION OF RECORD )

SCALE

1" = 30'

