

SURVEY OF THE EAST LINE OF LOT 1, C.S.M. NO. 1116, LOCATED IN THE SE 1/4 - NE 1/4, SECTION 32, T37N, R9E, CITY OF RHINELANDER, ONEIDA COUNTY, WISCONSIN

BEARINGS REFERENCED TO THE WEST LINE OF LOT 2, C.S.M. NO. 1116, ASSUMED TO BEAR N01°39'50"W

N

N STEVENS STREET
S.T.H. "17"

50'

(N87°51'10"E) (235.54')
N87°51'10"E 235.54'

1" I.P. BEARS S53°42'18"W 0.49'

R/W LINE

JUNIPER DRIVE

(N01°39'50"W)
N01°39'50"W
179.92'
(180.00')

-2-

CERTIFIED SURVEY MAP NO. 1116

-1-

(180.00')
S02°19'55"E
(180.00')
S02°19'55"E

S87°52'27"W 237.64'
(S87°51'10"W) (237.64')

I, KEVIN P. BIXBY, HEREBY CERTIFY THAT I HAVE SURVEYED THE ABOVE LINE UNDER THE DIRECTION OF GERRY RIOPEL AND THAT THE ABOVE MAP IS A TRUE AND CORRECT REPRESENTATION OF THE LINE SURVEYED TO THE BEST OF MY KNOWLEDGE AND BELIEF. THAT I HAVE COMPLIED WITH THE PROVISIONS OF AE 7 OF THE WISCONSIN ADMINISTRATIVE CODE

KEVIN P. BIXBY

DATE

LEGEND

- FOUND 1" IRON PIPE
- △ SET RAILROAD SPIKE
- () RECORDED AS

MAP # B3880
DATE FILED MAR 31 1998
BY *JB*
DESCRIPTION FILED
ONEIDA CO. SURVEYOR'S OFFICE

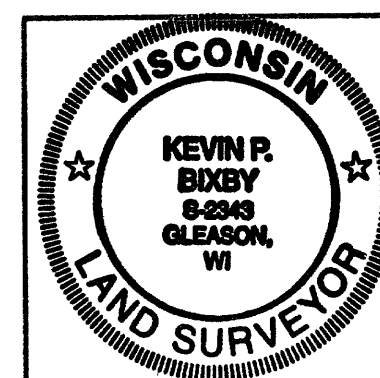

SURVEY FOR

GERRY RIOPEL

SCALE 1"=20' DATE 03/10/98 DWN BY K.B.

DWG. NO. 9832 GENISOT AND ASSOCIATES, INC.
RHINELANDER, WIS