

# SURVEY OF THE EAST LINE OF LOT 1, C.S.M. NO. 1116, LOCATED IN THE SE 1/4 - NE 1/4, SECTION 32, T37N, R9E, CITY OF RHINELANDER, ONEIDA COUNTY, WISCONSIN

MAP # B3904  
DATE FILED MAY 22 1998  
BY  
DESCRIPTION FILED  
ONEIDA CO. SURVEYOR'S OFFICE

BEARINGS REFERENCED TO THE WEST LINE OF LOT 2, C.S.M. NO. 1116, ASSUMED TO BEAR N01°39'50"W

N

N STEVENS STREET  
S.T.H. "17"

(N87°51'10"E) (235.54')  
N87°51'10"E 235.54'

1" IP BEARS S53°42'18"W 0.49'

R/W LINE

JUNIPER DRIVE

(N01°39'50"W)  
N01°39'50"W  
179.92  
(180.00')

-2-

CERTIFIED SURVEY MAP NO. 1116

-1-

(180.00')  
180.00'  
S02°19'55"E  
(S02°19'55"E)

S87°52'27"W 237.64'  
(S87°51'10"W) (237.64')

I, KEVIN P. BIXBY, HEREBY CERTIFY THAT I HAVE SURVEYED THE ABOVE LINE UNDER THE DIRECTION OF GERRY RIOPEL AND THAT THE ABOVE MAP IS A TRUE AND CORRECT REPRESENTATION OF THE LINE SURVEYED TO THE BEST OF MY KNOWLEDGE AND BELIEF THAT I HAVE COMPLIED WITH THE PROVISIONS OF AE 7 OF THE WISCONSIN ADMINISTRATIVE CODE

*Kevin P. Bixby*  
KEVIN P. BIXBY

05/19/98  
DATE

## LEGEND

- FOUND 1" IRON PIPE
- △ SET RAILROAD SPIKE
- ( ) RECORDED AS

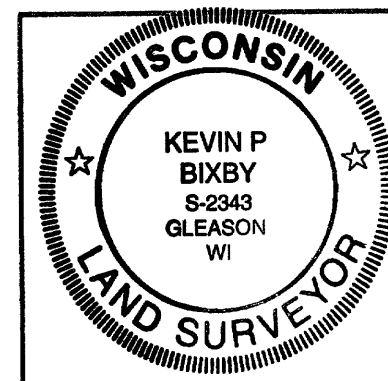

SURVEY FOR  
**GERRY RIOPEL**

SCALE 1"=20' DATE 03/10/98 DWN BY KB  
DWG NO 9832  
GENISOT AND ASSOCIATES, INC.  
RHINELANDER, WIS