

Part of
GOV'T. LOT 4
SECTION 3, T39N, R5E
Minocqua Township
Oneida County, Wisconsin

SURVEYOR'S CERTIFICATE
I, James D. Rein, Registered Land Surveyor No. S-1234, hereby certify that I have surveyed the property shown hereon, that this map represents an accurate survey of said property to the best of my knowledge and belief, that I have performed this survey by order of Ed Sitkiewicz; and that I have complied with the requirements of Wisconsin Administrative Code A-E 7.

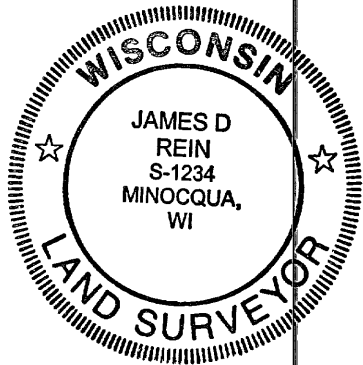

WILDERNESS SURVEYING, INC.

[Signature]
Registered Land Surveyor # S-1234
Dated this 2nd day of January, 2001

Bearing base assumed,
referenced to the east line of
Gov't Lot 4 bearing
N00°13'56" W

-Parcel 1- (Map No. 00-227)

A parcel of land in Government Lot 4, Section 3, Township 39 North, Range 5 East Minocqua Township, Oneida County, Wisconsin, being part of "Parcel 1" as described in Volume 359 of Deeds, on page 108 and as shown on Map No. 00-227 by Wilderness Surveying, Inc., dated January 2, 2001, more particularly described as follows:

Commencing at the south quarter corner of Section 3, marked by a brass capped concrete monument thence North 00 degrees 13 minutes 56 seconds West for a distance of 766.33 feet, along the east line of Government Lot 4, to the place of beginning, marked by an iron pipe.

Thence continuing North 00 degrees 13 minutes 56 seconds West for a distance of 568.92 feet to along the east line of Government Lot 4 to an iron pipe on the southeasterly right of way line of Back Bay Road, thence along said southeasterly right of way line along a curve to the right, having a radius of 917.24 feet and an arc length of 151.76 feet, being subtended by a chord of South 35 degrees 41 minutes 21 seconds West for a distance of 151.59 feet to an iron pipe, thence continuing along said southeasterly right of way line South 40 degrees 25 minutes 45 seconds West for a distance of 358.20 feet to wood right of way post, thence continuing along said right of way line South 47 degrees 36 minutes 12 seconds East for a distance of 12.00 feet to a wood right of way post, thence continuing along said right of way line South 41 degrees 24 minutes 54 seconds West for a distance of 149.81 feet to an intersection with the easterly right of way line of State Highway "70", marked by an iron pipe, thence along said easterly right of way line of State Highway "70", South 00 degrees 31 minutes 56 seconds West for a distance of 65.60 feet to an iron pipe, thence continuing along said easterly right of way line South 40 degrees 21 minutes 01 seconds East for a distance of 25.22 feet to an iron pipe, thence North 85 degrees 22 minutes 50 seconds East for a distance of 398.87 feet to the place of beginning.

Together with and subject to covenants, easements, and restrictions of record

Said property contains 3.06 acres

MAP #	B4682
DATE FILED	JAN 2 4 2001
BY	J.S.R.
DESCRIPTION FILED	
ONEIDA CO. SURVEYOR'S OFFICE	

Brass capped concrete monument found in place

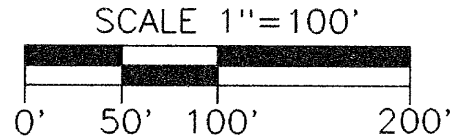
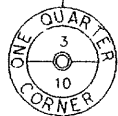

- LEGEND**
- ⊗ = Wood right of way post found in place
 - ⊕ = 1" dia. iron pipe found in place
 - = Iron pipe set 3/4" dia x 24" long
 - = Corner position not monumented by this survey
 - Other corner monuments are as noted

WILDERNESS SURVEYING, INC. Post Office Box 1111 - 8793 Earls Court Minocqua, Wisconsin 54548-1111 Telephone (715) 356-5100	
Map Number 00-227 File Number 14-3-395 Drafted by M Oestreich	Revisions