

Part of the
SE 1/4 of the SE 1/4
SECTION 22, T38N, R6E

Hazelhurst Township
Oneida County, Wisconsin

SURVEYOR'S CERTIFICATE

I, James D. Rein, Registered Land Surveyor No. S-1234, hereby certify that I have surveyed the property shown hereon, that this map represents an accurate survey of said property to the best of my knowledge and belief, that I have performed this survey by order of Gene Johnson, and that I have complied with the requirements of Wisconsin Administrative Code A-E 7.



WILDERNESS
SURVEYING,
INC.

James D. Rein
Registered Land Surveyor # S-1234
Dated this 5th day of March, 1999

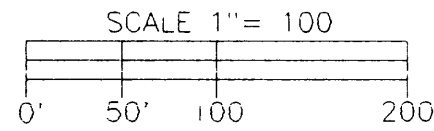

Capped 2" dia. aluminum
rod found in place



LEGEND

○ = iron pipe set 3/4" dia. x 24" long
Other corner monuments are as noted

SE 1/16 CORNER
1 1/4" dia. iron
pipe found in place

S 1/16 CORNER
Corner position not
monumented by this survey

Bearing base assumed
referenced to the east line
of the SE 1/4 bearing
N01°19'06" E

Vol 734, Pg 83

Vol 434, Pg 390

2.00 Acres

2.00 ACRES PARCEL (Map No. 99-26)

A parcel of land in the Southeast Quarter of the Southeast Quarter, Section 22, Township 38 North, Range 6 East, Hazelhurst Township, Oneida County, Wisconsin, being the 2.00 Acres parcel shown on Map No. 99-26 by Wilderness Surveying, Inc., dated March 5th, 1999, more particularly described as follows:

Commencing at the southeast corner of the Southeast Quarter of the Southeast Quarter, being the corner common to Sections 22, 23, 26 and 27, marked by a capped aluminum rod, thence North 01 degrees 19 minutes 06 seconds East for a distance of 586.51 feet along the east line of the Southeast Quarter of the Southeast Quarter to the place of beginning, marked by an iron pipe on the northerly right of way line of South Blue Lake Road;

Thence continuing North 01 degrees 19 minutes 06 seconds East for a distance of 387.09 feet along the east line of the Southeast Quarter of the Southeast Quarter to an iron pipe on the southerly line of that parcel of land described in Volume 734, on page 83, thence South 89 degrees 47 minutes 03 seconds West for a distance of 406.03 feet along the southerly line of said parcel of land described in Volume 734, on page 83, to an iron pipe on the northerly right of way line of South Blue Lake Road; thence along the northerly right of way line of South Blue Lake Road along a curve to the right, having a radius of 948.32 feet and an arc length of 118.26 feet, being subtended by a chord of South 42 degrees 28 minutes 52 seconds East for a distance of 118.18 feet to an iron pipe, thence continuing along said northerly right of way line South 38 degrees 54 minutes 31 seconds East for a distance of 125.71 feet to an iron pipe, thence continuing along said northerly right of way line along a curve to the left, having a radius of 813.12 feet and an arc length of 301.48 feet, being subtended by a chord of South 49 degrees 31 minutes 49 seconds East for a distance of 299.75 feet to an iron pipe, thence continuing along said northerly right of way line South 60 degrees 09 minutes 07 seconds East for a distance of 11.90 feet to the place of beginning.

Together with and subject to covenants, easements and restrictions of record.

Said property contains 2.00 acres.

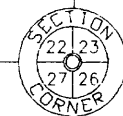

Capped 1" dia. aluminum
rod found in place

MAP # B4723
DATE FILED MAR 27 2001
BY jsp
DESCRIPTION: ILL
ONEIDA CO. SURVEYOR'S OFFICE

WILDERNESS SURVEYING, INC.
Post Office Box 1111 - 8793 Earls Court
Minocqua, Wisconsin 54548-1111
Telephone: (715) 356-5100

Map Number 99-26
File Number 16-22-386
Drafted by M. Oestreich

Revisions