

B4820

B4820

PART OF THE NE 1/4 SE 1/4,
SEC. 8, T. 37 N., R. 10 E.,
ONEIDA COUNTY, WI.

MAP # B4820
DATE FILED AUG 31 2001
BY JLO
DESCRIPTION FILED
ONEIDA CO. SURVEYOR'S OFFICE



I, Todd Loftus, Registered Land Surveyor, hereby certify that I have surveyed the property shown hereon. That this map represents an accurate survey of said property to the best of my knowledge & belief. That I have performed this survey by order of Jack Bartelme and that I have complied with the applicable requirements of the Wisconsin Administrative Code A.T. 7.

Description required for above parcel is on separate sheet

DATE May 23, 2001

SIGNED Todd Loftus

LOFTUS SURVEYING

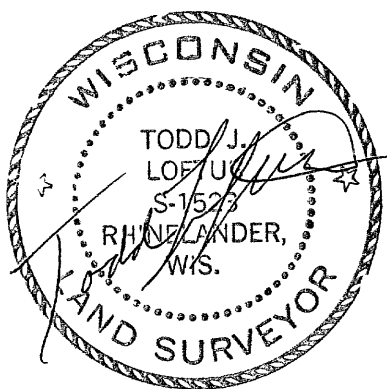

LEGEND

- ⊙ SUBDIVISIONAL MONUMENT OF RECORD
- △ FOUND IRON SPIKE
- FOUND IRON PIPE
- SET 3/4" RE-BAR
- (0.00) BEARING & DISTANCE OF RECORD

SCALE

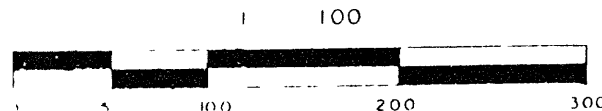

NORTH IS REFERENCED TO THE EAST LINE OF THE SE 1/4, BEING AN ASSUMED BEARING OF N 1° 53' 37" E

1249B4

B4820