

TOP SECRET
NOV 9 5 2001
EX-111
DEFINITION FILE
SERIAL NO. SURVEYOR'S OFFICE

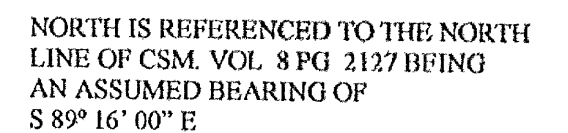

DATE Sept 10, 2001



REVISION - CHANGED COMMON BOUNDARY LINE
BETWEEN THE ABOVE TWO PARCELS
O RE-BAR 3/4" SET AUG 25, 2001

1" = 30'

A horizontal scale bar with alternating black and white segments. Below the bar are numerical markings at 0, 10, 20, 30, and 60. The segments represent 10-foot intervals, with the final segment from 30 to 60 being a single solid black block.

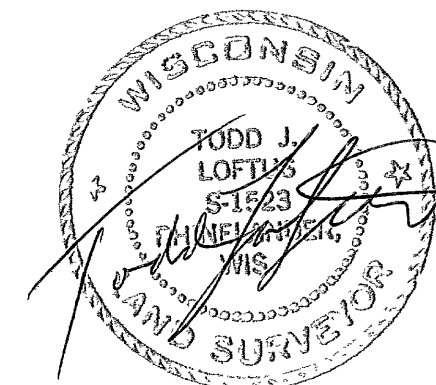

1251B4