

34333

34333

# A Parcel of Land Located in Part of Gov't. Lot 4, Sec. 10, T. 38 N., R. 10 E., Oneida County, Wi.

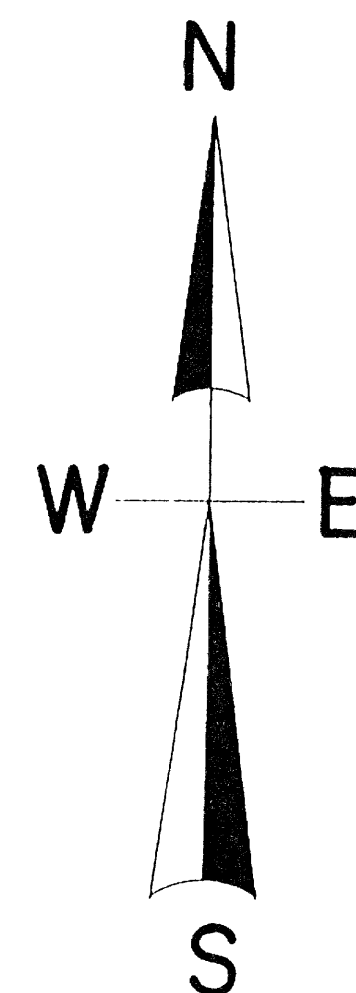
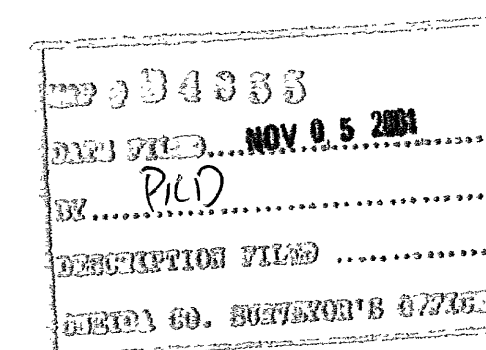

No effluent System or Human Dwelling can  
Be Built on the Parcel as Shown.

MAGNETIC NORTH

1/4 COR.  
2" RIPCO MON

SEC. LINE  
WEST LINE GOVT LOT 4

155.65'

155.65'

240.56'

240.56'

155.65'

155.65'

155.65'

155.65'

155.65'

155.65'

1/16 COR.  
1" RIPCO MON

CENTER LINE OF EASEMENT ROAD  
N 55° 18' 50" E 266.63'

N 83° 02' 40" E 162.10'

S 50° 26' 50" W 25.12'

RIGHT OF WAY EASEMENT ROAD  
S 68° 24' 07" E 224.38'

31,096 SQ FT

N 0° 00' 00" E 150.00'

S 87° 38' 50" W 167.56'

N 86° 00' 00" W 32.03'

N 50° 01' 10" W 117.95'

S 25° 30' 00" W 72.56'

The parcel as shown has 150' of lake frontage



THUNDER  
LAKE

## LEGEND

- ⊙ STAMPED SUBDIVISIONAL MONUMENT OF RECORD
- UNSTAMPED 1" RIPCO MONUMENT FOUND
- 3/4 RE-BAR SET
- IRON SPIKE SET
- (0 0) BEARING & DISTANCE OF RECORD

## SCALE

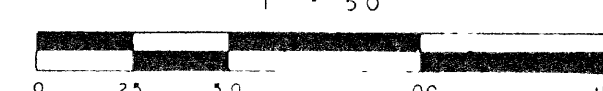

I, Todd Loftus, Registered Land Surveyor, hereby certify that I have surveyed the property shown hereon. That this map represents an accurate survey of said property to the best of my knowledge & belief. That I have performed this survey by order of James Beck and that I have complied with the applicable requirements of the Wisconsin Administrative Code A.E. 7.

Description required for above parcel is on separate sheet

DATE Sept 3, 2001

SIGNED Todd Loftus

LOFTUS SURVEYING

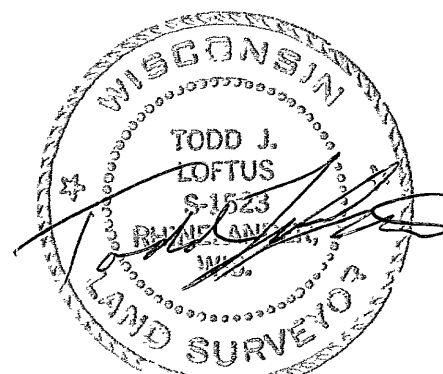

# 1259B4

34333