

D1870

MAP #	34370
DATE FILED	NOV 9 5 2001
DESCRIPTION FILED	
ONEIDA CO. SURVEYOR'S OFFICE	

34370

**LOCATED IN
GOV'T LOTS 6 & 9,
SECTION 19, T 36 N, R 8 E,
TOWN OF CRESCENT,
ONEIDA COUNTY, WISCONSIN
PARCEL "B" LOCATED IN
GOV'T. LOT 6, SECTION 24,
T36N, R7E,
TOWN OF WOODBORO**

LEGEND:

- ⊗ FOUND 1" IRON PIPE
- SET 1" X 24" IRON PIPE
- FOUND 1-1/4" IRON PIPE
- FOUND 1" CAPPED G.L.O. MONUMENT
- ⊙ FOUND CONCRETE G.L.O. BRASS CAPPED MONUMENT
- () RECORDED AS
- △ SET 1" X 24" IRON PIPE 8/6/01
- ▲ SET R/R SPIKE 8/6/01
- SET 1" X 24" IRON PIPE ON 8/21/01
- △ 6" SPIKE TO BE REPLACED WITH A 1" X 21" IRON PIPE AFTER LANDSCAPING IS COMPLETE

I, RUSSELL F. BROWN, HEREBY CERTIFY THAT I HAVE SURVEYED THE ABOVE PARCEL OF LAND UNDER THE DIRECTION OF MR. DALE KRAMER AND THAT THE ABOVE MAP IS A TRUE AND CORRECT REPRESENTATION OF THE LANDS SURVEYED TO THE BEST OF MY KNOWLEDGE AND BELIEF THAT I HAVE PROVIDED A DESCRIPTION OF THE PARCEL ON A SEPARATE SHEET THAT I HAVE COMPLIED WITH THE PROVISIONS OF AE 7 OF THE WISCONSIN ADMINISTRATIVE CODE

Russell F. Brown 8/6/01
RUSSELL F. BROWN R.L.S. 2148 DATE

NOTE
PARCEL "A" TO BE ATTACHED TO LANDS TO THE WEST AND NOT SOLD SEPARATE UNLESS APPROVED BY ONEIDA COUNTY ZONING
PARCEL "B" TO BE ATTACHED TO THE LANDS TO THE EAST AND NOT SOLD SEPARATE UNLESS APPROVED BY ONEIDA COUNTY ZONING
THIS MAP IS A SURVEY OF PARCELS "A" AND "B" ONLY

REVISED TO SHOW PARCEL "B" 8/22/01 RB

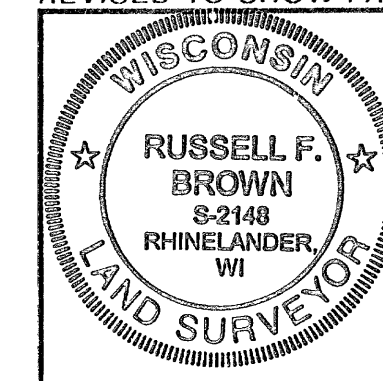

SURVEY FOR
DALE KRAMER

SCALE	1" = 100'	DATE	8/6/01	DWN BY	RB
DWG NO	10317	GENISOT AND ASSOCIATES, INC. RHINELANDER, WIS			

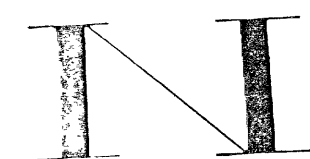

BEARINGS REFERENCED TO THE WEST LINE OF
SECTION 19, T36N, R8E, ASSUMED TO BEAR N 1°44'23" E

SQUASH
LAKE

PARCEL "B"
SEE DETAIL "A"

PARCEL "A"
1.434 SQ. FT.
0.03 ACRES

ROUND LAKE

30.79 ACRES
AREA INCLUDES ROUND LAKE

BITUMINOUS PAVEMENT ENCROACHMENT

60' WIDE PRIVATE ROAD

LONG LAKE

DETAIL "A"

SQUASH LAKE

1000'

1000'

1000'

1000'

1000'

1000'

1000'

1000'

1000'

1000'

1000'

1000'

1000'

1000'

1000'

1000'

1000'

1000'

1000'

1000'

1000'

1000'

1000'

1000'

1000'

1000'

1000'

1000'

1000'