

B5070

B5070

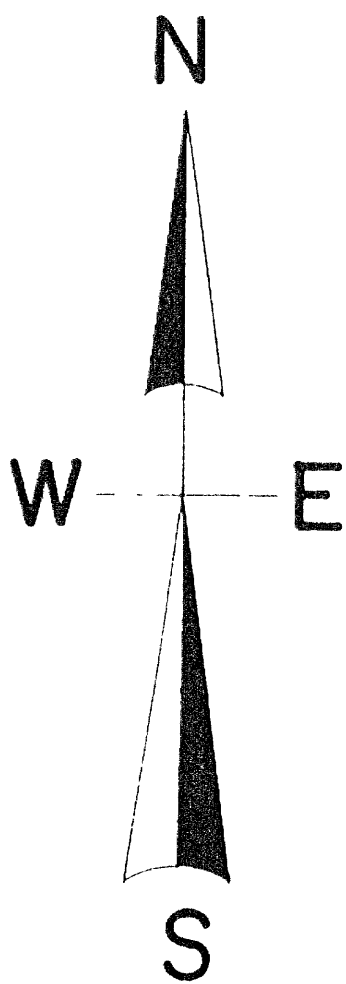

NORTH IS REFERENCED TO THE WEST  
LINE OF BLOCK 4 BEING AN ASSUMED BEARING  
OF N 2° 00' 32" E

LEGEND

- FOUND 2" IRON PIPE
- FOUND 1" IRON PIPE
- FOUND 3/4" RE-BAR
- △ SET 3/4" RE-BAR
- (0 0') DISTANCE OF RECORD

SCALE

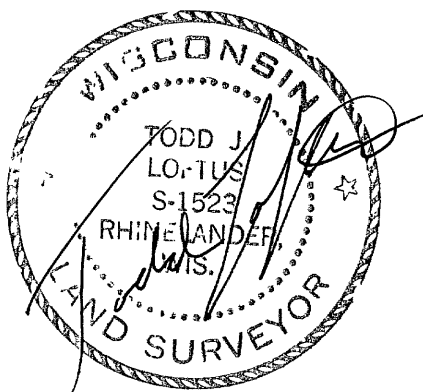
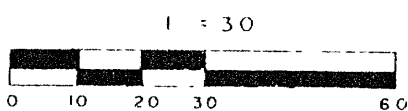

DATE 6/4/25/2002

SIGNED *Todd Loftus*

LOFTUS SURVEYING

HEMLOCK STREET

60'

PART OF LOT 3, BLOCK 4, HILLSIDE  
ADDITION TO THE CITY OF  
RHINELANDER, ACCORDING TO THE  
RECORDED PLAT THEREOF.  
LOCATED IN PART OF SECTION 6, TOWNSHIP 36  
NORTH, RANGE 9 EAST, ONEIDA COUNTY, WI.

VOL 913  
PG. 739

LOT 3

BIRCH STREET

MAP #B5070  
DATE FILED AUG 30 2002  
BY *J.L.*  
DESCRIPTION FILED  
ONEIDA CO. SURVEYOR'S OFFICE

I, Todd Loftus, Registered Land Surveyor, hereby certify that I have surveyed the property shown hereon. That this map represents an accurate survey of said property to the best of my knowledge & belief. That I have performed this survey by order of *Elton Maloney* and that I have complied with the applicable requirements of the Wisconsin Statutes.

1276B4

B5070