

B5083

B5083

Part of
GOV'T. LOT 3
SECTION 10, T38N, R6E

Hazelhurst Township
Oneida County, Wisconsin
SURVEYOR'S CERTIFICATE

I, James D. Rein, Registered Land Surveyor No S-1234, hereby certify that I have surveyed the property shown hereon, that this map represents an accurate survey of said property to the best of my knowledge and belief, that I have performed this survey by order of Barb Zawatoski, and that I have complied with the requirements of Wisconsin Administrative Code A-E 7

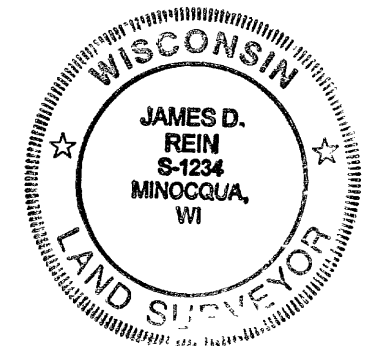

WILDERNESS SURVEYING, INC.
[Signature]
Registered Land Surveyor # S-1234
Dated this 23rd day of August 2002

Bearings Oneida County Gnd, based on GPS survey data, and referenced to the west line of Gov't Lot 3, bearing S11°43'47"E

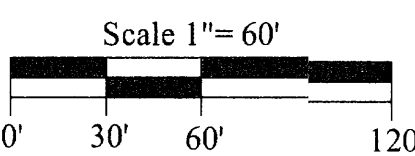
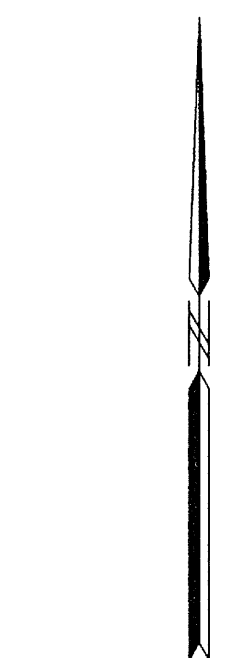

- Legend**
- = 3" x 0.25" iron bar found in place
 - ⊗ = 2.4" dia iron pipe found in place
 - ⊕ = 1.3" dia iron pipe found in place
 - ⊙ = 1.0" dia iron pipe found in place
 - ⊘ = 0.75" dia iron rod found in place
 - = Steel R/W post found in place
- Pipe sizes are outside diameter dimension
Other corner monuments are as noted

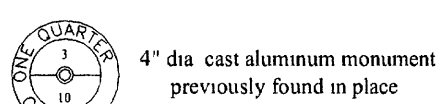

4" dia cast aluminum monument previously found in place

CE 1/16 Corner
Corner position not monumented by this survey

-2-
Vol. 3 S. Maps, Pages 823 & 823A

Vol. 862, Pg. 017

Note: 1.0" dia iron pipe bears N47°01'E 2.42
1.3" dia iron pipe bears S54°34'W 1.09

ZAWATOWSKI (Map No 02-163)

A parcel of land in Government Lot 3 Section 10, Township 38 North Range 6 East Hazelhurst Township Oneida County Wisconsin being the ZAWATOWSKI parcel shown on Map No 02-163 by Wilderness Surveying Inc dated August 23 2002 more particularly described as follows

Commencing at the north quarter corner of Section 10 marked by a cast aluminum monument thence South 27 degrees 13 minutes 40 seconds East for a distance of 3056.54 feet to the Center-East Sixteenth Corner thence South 11 degrees 43 minutes 47 seconds East for a distance of 1385.78 feet to the Southeast Sixteenth Corner marked by an iron pipe thence South 89 degrees 12 minutes 35 seconds East for a distance of 131.60 feet to the westerly most corner of that parcel of land described in Volume 862 on page 017 marked by an iron pipe thence North 48 degrees 44 minutes 47 seconds East for a distance of 301.69 feet along the northerly line of said parcel of land described in Volume 862 on page 017 to the place of beginning marked by an iron bar at that corner common with Lot 2 of Oneida County Certified Survey Map No 823

Thence North 49 degrees 20 minutes 03 seconds East for a distance of 246.60 feet along the northerly line of said parcel of land described in Volume 862 on page 017 to a steel right of post on the westerly right of way line of U.S. Highway 51 thence along said right of way line North 50 degrees 15 minutes 01 seconds East for a distance of 36.45 feet to an iron rod thence continuing along said right of way line North 40 degrees 53 minutes 19 seconds West for a distance of 300.52 feet to an iron rod, thence continuing along said right of way line South 44 degrees 41 minutes 14 seconds West for a distance of 36.72 feet to an iron pipe at that corner common with Lot 2 of Oneida County Certified Survey Map No 823 thence along the southeasterly line of said Lot 2 South 44 degrees 56 minutes 39 seconds West for a distance of 241.37 feet to an iron pipe, thence continuing along the easterly line of said Lot 2 South 39 degrees 43 minutes 00 seconds East for a distance of 278.53 feet to the place of beginning

Together with and subject to covenants easements and restrictions of record
Said property contains 1.86 acres

MAP #	B5083
DATE FILED	SEP 13 2002
BY	[Signature]
DESCRIPTION FILED	
ONEIDA CO. SURVEYOR'S OFFICE	

WILDERNESS SURVEYING, INC.
Post Office Box 1111 - 8793 Earls Court
Minocqua, Wisconsin 54548-1111
Telephone (715) 356-5100

Map Number 02-163	Revisions
File Number 9-10-386	
Drafted by M. Oestreich	

B5083

B5083