

B5109

B5109

LOTS 18 & 19
of the unrecorded plat of
**MUSKELLUNGE LAKE
HIGHLANDS**
Being part of
GOV'T. LOT 6
SECTION 10, T38N, R8E
Town of Newbold
Oneida County, Wisconsin

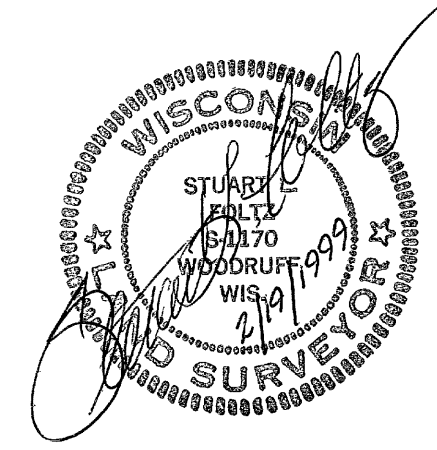

Revised 9/13/2002, to show lot 18

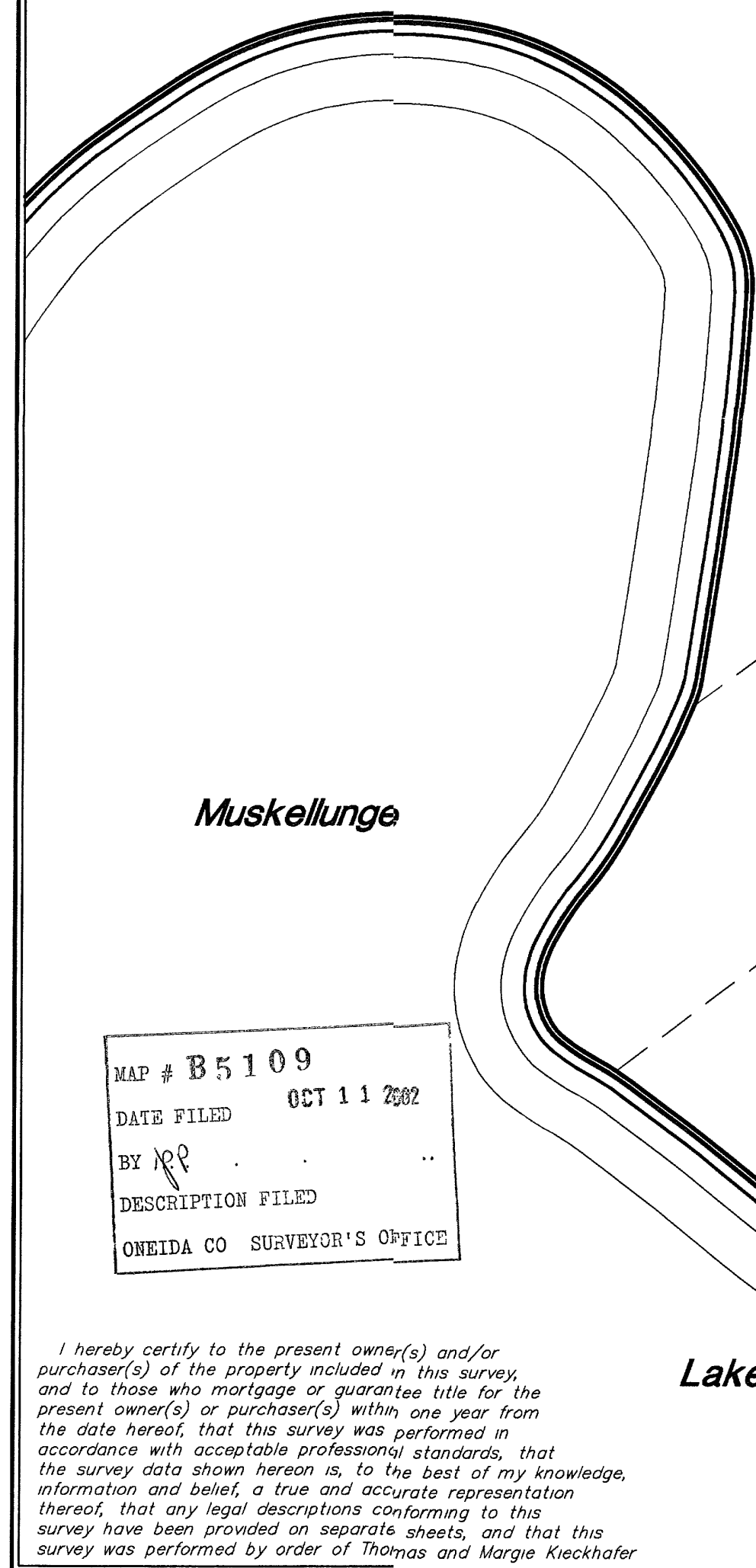

MAP # B5109
DATE FILED OCT 11 2002
BY [Signature]
DESCRIPTION FILED
ONEIDA CO SURVEYOR'S OFFICE

I hereby certify to the present owner(s) and/or purchaser(s) of the property included in this survey, and to those who mortgage or guarantee title for the present owner(s) or purchaser(s) within one year from the date hereof, that this survey was performed in accordance with acceptable professional standards, that the survey data shown hereon is, to the best of my knowledge, information and belief, a true and accurate representation thereof, that any legal descriptions conforming to this survey have been provided on separate sheets, and that this survey was performed by order of Thomas and Margie Kieckhafer

The survey of lot 19 is based on title information contained in Chicago Title Insurance Company ALTA Commitment No. ON 25855, effective Feb. 2, 1999, issued by Oneida Title & Abstract, Inc. of Rhinelander Wisconsin

The survey of lot 18 is based on title information contained in Chicago Title Insurance Company ALTA Commitment No. ON 30340, effective Sept. 3, 2002, issued by Oneida Title & Abstract, Inc. of Rhinelander Wisconsin

- = 2-1/4" iron pipe found
- ⊙ = 2" iron pipe found
- ⊖ = 1-1/4" iron pipe found
- ⊗ = 1" iron pipe found
- = 3/4" iron pipe set per Northwoods Surveyors' field notes dated 6/13/1967
- ⊗ = 1" iron pipe found (tipped) reset on line
- ⊙ = 3/4" iron pipe set, per 9/13/2002 revision
- () = previously recorded

NOTE All iron pipe diameters shown hereon are nominal dimensions

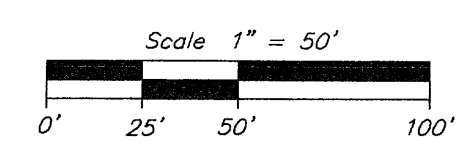

Foltz and Associates, Inc.

Surveyors	Architects	Engineers
8612 Highway 51 North, Minocqua, Wisconsin 54548		
(715) 356-9485		fax (715) 356-1841

C. Winkler 3&4-10-388

B5109

B5109