

B5245

B5245

S.1/2, NESE.1/4, SEC. 21,
T. 35 N., R. 10 E.,
ENTERPRISE TOWNSHIP,
ONEIDA COUNTY, WI.



- LEGEND
- SUBDIVISIONAL MONUMENT OF RECORD
 - SUBDIVISIONAL MONUMENT SET
 - 3/4 RE-BAR SET
 - ▲ COMPUTED POSITION

SCALE

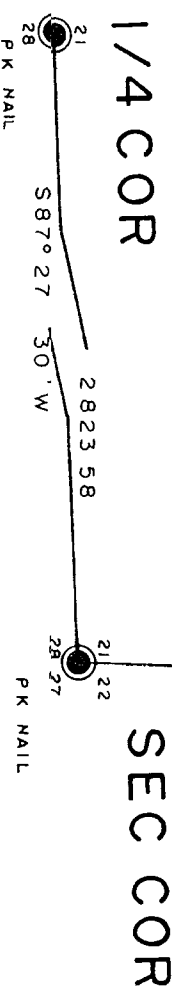

I, Todd Loftus, Registered Land Surveyor, hereby certify that I have surveyed the property shown hereon. That this map represents an accurate survey of said property to the best of my knowledge & belief. That I have performed this survey by order of *John Brown* and that I have complied with the applicable requirements of the Wisconsin Administrative Code A E 7.

Description required for above parcel is on separate sheet

DATE *April 7, 2003*

SIGNED

Todd Loftus

LOFTUS SURVEYING

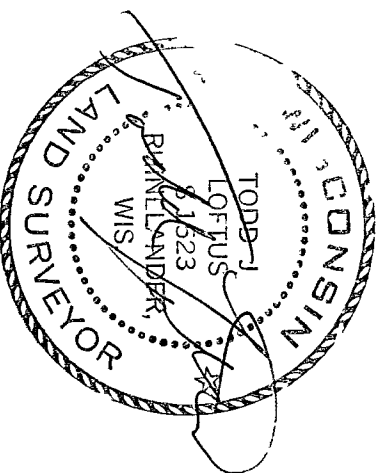

MAP # **B5245**
DATE FILED *APR 30 2003*
BY
DESCRIPTION FILED
ONEIDA CO SURVEYOR'S OFFICE

1314B5

B5245

NORTH IS REFERENCED TO
THE E-W 1/4 LINE BEING AN
ASSUMED BEARING OF
N 89° 31' 38\"/>