

B5325

B5325

Bearings Grid North,
Wisconsin Coordinate System,
North Zone, based on
solar observation.

Part of the
**NW 1/4 of the NE 1/4
SECTION 11, T39N, R6E**

Minocqua Township
Oneida County, Wisconsin

SURVEYOR'S CERTIFICATE

I, James L. Rein, Registered Land Surveyor No. S-2335, hereby certify that I have surveyed the property shown hereon; that this map represents an accurate survey of said property to the best of my knowledge and belief; that I have performed this survey by order of Jim Tait; and that I have complied with the requirements of Wisconsin Administrative Code A-E 7.

**WILDERNESS
SURVEYING,
INC.**



James L. Rein
Registered Land Surveyor # S-2335
Dated this 28th day of August, 2003.

Tait Parcel (Map No. 03-185)

That parcel of land previously described in Volume 617, on page 353, located in the Northwest Quarter of the Northeast Quarter, Section 11, Township 39 North, Range 6 East, Minocqua Township, Oneida County, Wisconsin, being the "Tait" parcel shown on Map No. 03-185 by Wilderness Surveying, Inc., dated August 28, 2003, more particularly described as follows:

Commencing at the northwest corner of the Northwest Quarter of the Northeast Quarter, being the quarter corner common to Section 2 and Section 11, marked by an iron spindle in the pavement of Town Line Road; thence North 89 degrees 29 minutes 47 seconds East for a distance of 150.00 feet along the north line of the Northwest Quarter of the Northeast Quarter; thence South 02 degrees 12 minutes 14 seconds East for a distance of 24.76 feet to the place of beginning, marked by an iron pipe on the southerly right of way line of Town Line Road.

Thence along said southerly right of way line of Town Line Road North 89 degrees 29 minutes 47 seconds East for a distance of 145.38 feet to an iron pipe; thence South 00 degrees 18 minutes 50 seconds East for a distance of 266.53 feet to an iron pipe; thence North 89 degrees 53 minutes 36 seconds West for a distance of 136.64 feet to an iron pipe; thence North 02 degrees 12 minutes 14 seconds West for a distance of 265.19 feet to the place of beginning.

Together with and subject to covenants, easements, and restrictions of record.

Said property contains 0.86 acres.

0.5" dia. x 5" long,
iron spindle previously set.



Town

Line

Road

Survey marker nail
found in place.

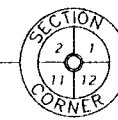

Rec. P.O.B. = at a point
150 feet east of quarter corner

Rec = East, 146.2' N 89 29'47"E 2657.79'

146.20'

2361.52'

N 89 29'47"E

145.38'

overhead powerline

driveway

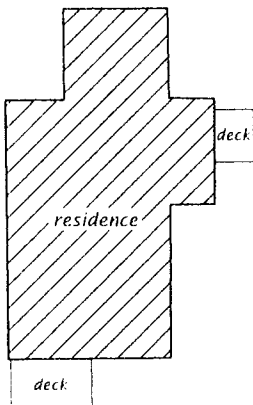

well on
lot line

septic tank
cleanout

Tait

Vol. 617, pg. 353
0.86 Acres

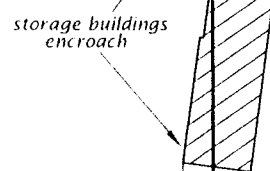
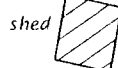

Vol. 223, pg. 585

Scale: 1" = 30'

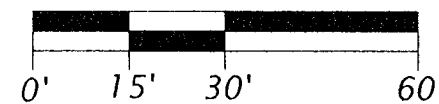

Legend

⊕ = 1.3" dia. iron pipe found in place.

⊕ = 1.0" dia. iron pipe found in place.

○ = Iron pipe set, 1.0" dia. x 24" long.

Pipe sizes are outside diameter dimension.

Other corner monuments are as noted.

Vol. 518, pg. 590

150.04'
S 89 36'25"W

136.64'

N 89 53'36"W

Rec = West parallel with section line
to a point 150 feet east of quarter section line

151.36'

N 89 58'04"E

MAP # **B5325**
DATE FILED **SEP 5 2003**
BY.....
DESCRIPTION FILED.....
ONEIDA CO. SURVEYOR'S OFFICE

WILDERNESS SURVEYING, INC.

Post Office Box 1111 - 8793 Earls Court
Minocqua, Wisconsin 54548-1111

Telephone (715) 356-5100 - www.wildernesssurveying.com

Map Number: 03-185

File Number: 2-11-396

Drafted by: M. Oestreich

Revisions:

B5325

B5325