

MAP # **B5539**  
DATE FILED **2-3-04**  
BY *JS*  
DESCRIPTION FILED  
ONEIDA CO SURVEYOR'S OFFICE

Lot -4-  
of  
Oneida County Certified Survey Map No 112  
recorded in  
Vol 1, Survey Maps on page 112  
in part of the  
**SW 1/4 of the NE 1/4  
SECTION 10, T39N, R6E**

Minocqua Township  
Oneida County, Wisconsin  
SURVEYOR'S CERTIFICATE

I James L Rein Registered Land Surveyor No S 2335 hereby certify that I have surveyed the property shown hereon that this map represents an accurate survey of said property to the best of my knowledge and belief that I have performed this survey by order of Warren Burns and that I have complied with the requirements of Wisconsin Administrative Code A E 7

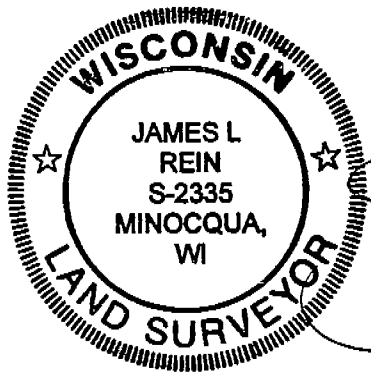

WILDERNESS  
SURVEYING,  
INC

*James L. Rein*  
Registered Land Surveyor # S 2335  
Dated this 28th day of January 2004

STATE HIGHWAY "70"

DRIVE

WESTLAKE DRIVE

BLUMSTEIN

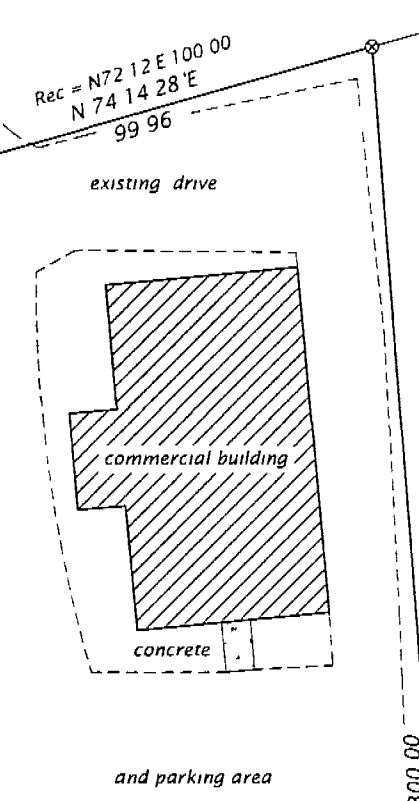

4-A  
29 780 sq ft

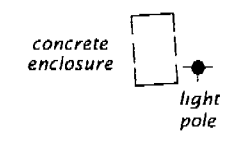

5 74 33 01 W  
102 65

4-B  
22 200 sq ft

CSM #1129

Vol. 4, S.M. Pg. 1129

Bearings Grid North  
Wisconsin Coordinate System  
North Zone based on a  
previous solar observation

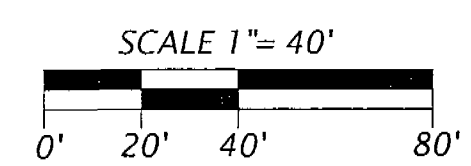

Legend

- ⊗ = 1 25" dia iron rod found in place
  - ⊗ = 1 0 dia iron rod found in place
  - ⊗ = 0 75" dia iron rod found in place
  - = Iron pipe set 1 0 dia x 24 long
- Monument sizes are outside diameter dimension

Notes  
Legal descriptions conforming to this survey  
have been provided on separate sheets  
Parcel 4-B shown hereon is intended to be  
attached to the adjoining easterly parcel of land

1 1/4 dia iron pipe  
found in place

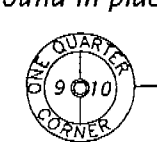

N 88 34 07 E  
2313 98

1 1/4 dia iron pipe  
found in place

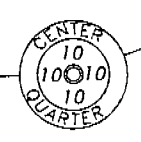

S 69 21 26 W  
1131 01

**WILDERNESS SURVEYING, INC**  
Post Office Box 1111 - 8793 Earls Court  
Minocqua Wisconsin 54548-1111  
Telephone (715) 356 5100 www.wildernesssurveying.com

Map Number 03 289 File Number 7 10 396 Drafted by M Oestreich	Revisions
---	-----------

B5539

B5539