

LOCATED IN PART OF GOV'T. LOT 2 & 3, AND THE SW 1/4  
OF THE NE 1/4, SECTION 3, T36N, R5E, TOWN OF LITTLE RICE, ONEIDA CO. WI.

N

BEARINGS REFERENCED TO THE SOUTH LINE OF THE SE 1/4 - NE 1/4,  
SECTION 3, ASSUMED TO BEAR N 81°08'06" W

BURROWS

LAKE



MAP # B5573  
DATE FILED 3-23-04  
BY jp  
DESCRIPTION FILED  
ONEIDA CO. SURVEYOR'S OFFICE

## LEGEND:

- ⊕ FOUND 2" IRON PIPE
- FOUND 1" IRON PIPE
- FOUND STEEL FENCE POST
- SET 1"X 24" IRON PIPE
- ⊗ POWER POLE
- ⊙ FOUND 1 1/4" IRON PIPE
- ( ) RECORDED AS
- △ SEPTIC TANK
- ⊙ FOUND 3/4" IRON PIPE
- FOUND 2" WCD. MONUMENT
- COMPUTED POSITION

I, RUSSELL F. BROWN, HEREBY CERTIFY THAT I HAVE SURVEYED THE ABOVE PARCEL OF LAND UNDER THE DIRECTION OF MR. JERRY WOOD AND THAT THIS MAP IS A TRUE AND CORRECT REPRESENTATION OF THE LANDS SURVEYED TO THE BEST OF MY KNOWLEDGE AND BELIEF. THAT I HAVE PROVIDED A DESCRIPTION OF THE PARCEL ON A SEPARATE SHEET, AND THAT I HAVE COMPLIED WITH THE PROVISIONS OF AE 7 OF THE WISCONSIN ADMINISTRATIVE CODE.

*Russell F. Brown* 9/22/03  
RUSSELL F. BROWN DATE

REVISED TO SHOW O.M.W.M. AND WETLAND AS LOCATED BY D.M.R. ON 9/5/03 AND ALSO TO SHOW SETBACKS 9/22/03 R.B.

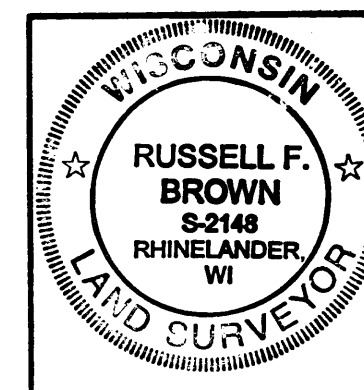

SURVEY FOR  
JERRY WOOD

SCALE 1" = 60' DATE 9/03/03 DWN. BY: R.B.  
DWG. NO. 10508 GENISOT AND ASSOCIATES, INC.  
RHINELANDER, WIS.