

The
**SW 1/4 of the SW 1/4
SECTION 11, T38N, R5E**

Minocqua Township
Oneida County, Wisconsin

SURVEYOR'S CERTIFICATE

I, James D. Rein, Registered Land Surveyor No. S-1234, hereby certify that I have surveyed the property shown hereon; that this map represents an accurate survey of said property to the best of my knowledge and belief; that I have performed this survey by order of Steve Margitan; and that I have complied with the requirements of Wisconsin Administrative Code A-E 7.

**WILDERNESS
SURVEYING,
INC.**

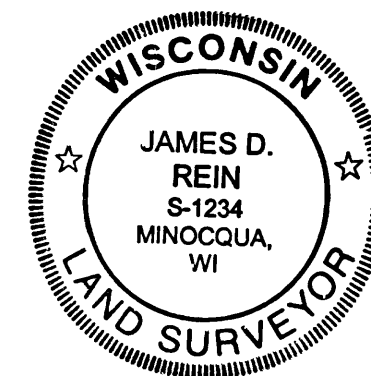

[Signature]
Registered Land Surveyor # S-1234
Dated this 2nd day of February, 2004.

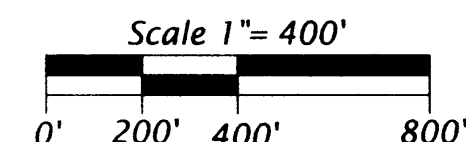

Bearings Oneida County Grid,
based on GPS survey data.

Legend

- ⊗ = Iron pipe set, 2.4" dia. x 30" long.
- ⊙ = Iron pipe set, 1.0" dia. x 60" long.
- = Iron pipe set, 1.0" dia. x 24" long.
- = Trail from digital data.

Pipe sizes are outside diameter dimension.

Other corner monuments are as noted.

NOTE:

Portions of roads, trails and creeks shown hereon are based upon Oneida County Land Information digital data obtained from photographic imagery.

MAP # **B5588**
DATE FILED **APR 16 2004**
BY *[Signature]*
DESCRIPTION FILED
ONEIDA CO. SURVEYOR'S OFFICE

WILDERNESS SURVEYING, INC.

Post Office Box 1111 - 8793 Earls Court
Minocqua, Wisconsin 54548-1111
Telephone (715) 356-5100 - www.wildernesssurveying.com

Map Number: 03-240
File Number: 16-11-385
Drafted by: M. Oestreich

Revisions:

