

LOT 10
OF
DOLHUN FIELD SUBDIVISION
PART OF THE
WEST 1/2 OF THE NORTHEAST 1/4
SECTION 33, TOWNSHIP 39 NORTH, RANGE 7 EAST
TOWN OF WOODRUFF
ONEIDA COUNTY, WISCONSIN

ASSIGNED NORTH, BASED ON THE
EASTERN LINE FROM THE NORTHEAST
CORNER OF LOT 3 TO THE SOUTHEAST
CORNER OF LOT 10 WHICH
BEARS S 0° 03' 27" N

MAP # B 5 6 4 6
DATE FILED JUL 20 2004
BY [Signature]
DESCRIPTION FILED
ONEIDA CO. SURVEYOR'S OFFICE

- LEGEND
- - 1" Iron Pipe Found
 - - 1 1/4" Iron Pipe Found
 - - 2" Iron Pipe Found
 - - Telephone / Cable Box
 - - Electric Box
 - () - Recorded as values Per Dolhun Field Subdivision Plat
 - [] - Recorded as values Per Oneida County Map # C826
- (NOTE: Iron pipe diameter is outside diameter)

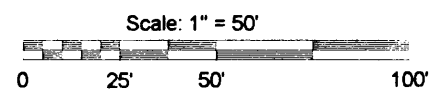

NOTE: FLAGGED PARCEL LINES WITH SURVEYOR'S RIBBON ARE ONLY A REPRESENTATION OF THE PROPERTY LINE AND SHOULD NOT BE USED AS THE ACTUAL PROPERTY LINE.

SURVEYOR'S CERTIFICATE

I, Benton A. McMullen, Wisconsin Registered Land Surveyor # S-2555, do hereby certify that I have surveyed and mapped the property shown hereon, and that I have complied with the applicable requirements of the Wisconsin Administrative Code Chapter A-E 7, and that this map represents a true and accurate survey of said property to the best of my knowledge and belief.

This survey was performed under the order of:
Kathryn Urbaszewski

This survey is made for the use of the present owners of the property, and also those who purchase, mortgage, or guarantee the title thereto within one year from date hereof.

FIELD SURVEY WORK COMPLETED
ON THE 4TH DAY OF MAY, 2004.

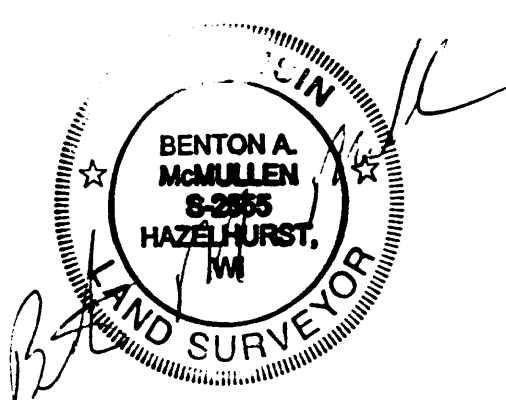

Registered Land Surveyor # S-2555

MCMULLEN & ASSOCIATES, INCORPORATED.
LAND SURVEYING AND SOIL TESTING
9832 BOLGER LAKE ROAD
MINOCQUA, WISCONSIN 54548
TELEPHONE # (715) 356-3011 FAX # (715) 356-1501

DRAFTED BY: Dwight A. Miesbauer DATE: May 24, 2004
SCALE: 1" = 50' JOB #204038