

LOT 1 OF CERTIFIED SURVEY MAP # 2162
AND
PART OF
GOVERNMENT LOT 3 & 4
SECTION 33, TOWNSHIP 39 NORTH, RANGE 7 EAST
TOWN OF WOODRUFF
ONEIDA COUNTY, WISCONSIN

LINE TABLE		
Line	Bearing	Distance
L 1	S 0°39'49" E	16.02'
L 2	N 88°52'03" E	19.95'
L 3	N 88°56'35" E	7.99'
L 4	(N 89°12'27" E)	(8.00')
	S 74°56'57" W	23.08'
	(S 75°18'49" W)	(23.14')

MAP # **B5649**
DATE FILED JUL 20 2004
BY prp
DESCRIPTION FILED
ONEIDA CO. SURVEYOR'S OFFICE

Scale: 1" = 50'

- LEGEND
- 1" Iron Pipe Found
 - 1 1/4" Capped Iron Pipe Found
 - 1 1/2" Iron Pipe Found
 - 2" Iron Pipe Found
 - 1 1/2" X 24" Iron Pipe Set
 - Weighting at least 1.13 lbs per lineal foot
 - Calculated Point (not monumented by this survey)
 - Electric Box
 - Telephone Pedestal
 - Runway Lights
 - Paved Runway
 - Grass Runway
 - Existing Structures
 - () Recorded as values
 - (NOTE: Iron pipe diameter is outside diameter)

CURVE TABLE						
Curve	Delta Angle	Radius	Arc	Tangent	Chord	Chord Bearing
C 1	63°14'58"	32.88	36.30	20.25	34.48	S 36°12'40" E
C 2	63°14'58"	12.88	14.22	7.93	13.51	N 36°12'40" W

DESCRIPTION (PARCEL A)

Part of Government Lot 3 & 4, Section 33, Township 39 North, Range 7 East, town of Woodruff, Oneida County, Wisconsin more particularly described as follows:

Commencing at the North 1/4 corner of said section marked by a 1 1/2" iron pipe found in place; thence South 1° 57' 27" East (ASSUMED), a distance of 2603.78 feet to a found 1" iron pipe on the southeasterly road right-of-way of Retreat Drive, said point being the POINT OF BEGINNING;

Thence leaving said road right-of-way North 88° 52' 03" East, a distance of 19.95 feet to a found 1 1/2" iron pipe; thence South 27° 17' 31" West, a distance of 151.75 feet to a found 1 1/2" iron pipe; thence South 0° 39' 49" East, a distance of 16.02 feet to a found 1" iron pipe; thence South 0° 42' 27" East, a distance of 61.52 feet to a found 2" iron pipe; thence South 26° 55' 03" West, a distance of 170.13 feet to a found 2" iron pipe; thence South 27° 20' 53" West, a distance of 224.66 feet to a found 2" iron pipe; thence South 27° 51' 54" West a distance of 24.87 feet to a found 2" iron pipe; thence North 81° 02' 25" West, a distance of 39.58 feet to a point on said road right-of-way; thence along said road right-of-way North 25° 46' 33" East, a distance of 642.85 feet to the POINT OF BEGINNING.

Said described tract containing 0.53 acres (22967.18 square feet), more or less.

Subject to any easements, restrictions, or rights of way of record or of use.

LOT 1 OF C.S.M. # 2894
(LOT 16)

LOT 2 OF C.S.M. # 2894

LOT 3 OF C.S.M. # 2894

LOT 1 OF C.S.M. # 2162
(LOT 15)

AREA:
3.80 ACRES
165452.63 SQ. FEET
MORE OR LESS

WHITE STRIP
MARKING LANDING
AND TAKEOFF POINT

EASEMENT 3

PAVED RUNWAY
ENCROACHES ON TO
LOT 1 OF C.S.M. # 2162
AND
LOT 1 OF C.S.M. # 2894

EASEMENT 2

NOTE: FLAGGED PARCEL LINES WITH SURVEYOR'S RIBBON
ARE ONLY A REPRESENTATION OF THE PROPERTY LINE AND
SHOULD NOT BE USED AS THE ACTUAL PROPERTY LINE.

SURVEYOR'S CERTIFICATE

I, Benton A. McMullen, Wisconsin Registered Land Surveyor # S-2555, do hereby certify that I have surveyed and mapped the property shown hereon, and that I have complied with the applicable requirements of the Wisconsin Administrative Code Chapter A-E 7, and that this map represents a true and accurate survey of said property to the best of my knowledge and belief.

This survey was performed under the order of:
Flying Cow Enterprises, Inc. (Kathryn Urbaszewski)

This survey is made for the use of the present owners of the property, and also those who purchase, mortgage, or guarantee the title thereto within one year from date hereof.

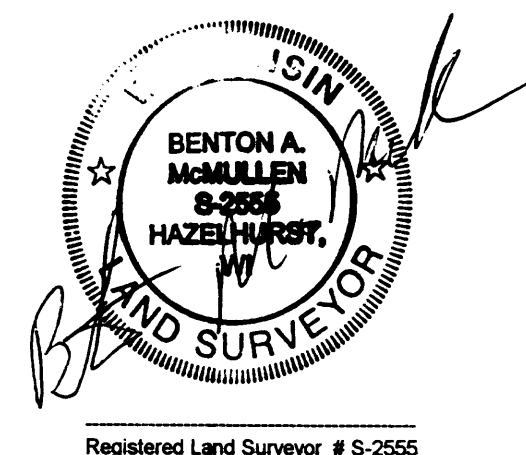

NOTE: EASEMENT DESCRIPTIONS PROVIDED
ON SEPARATE PAGES.

**MCMULLEN & ASSOCIATES,
INCORPORATED.**
LAND SURVEYING AND SOIL TESTING

9832 BOLGER LAKE ROAD
MINOCQUA, WISCONSIN 54548
TELEPHONE # (715) 356-3011 FAX # (715) 356-1501

DRAFTED BY: Dwight A. Miesbauer
SCALE: 1" = 50'

DATE: JUNE 30, 2004
JOB #204057