

Lot 1  
of  
**PEACEFUL SHORES**  
GOV'T. LOT 4  
SECTION 21, T38N, R6E  
Hazelhurst Township  
Oneida County, Wisconsin

**SURVEYOR'S CERTIFICATE**  
I, James D. Rein, Registered Land Surveyor No. S-1234, hereby certify that I have surveyed the property shown hereon; that this map represents an accurate survey of said property to the best of my knowledge and belief; that I have performed this survey by order of Doug Knight; and that I have complied with the requirements of Wisconsin Administrative Code A-E 7.

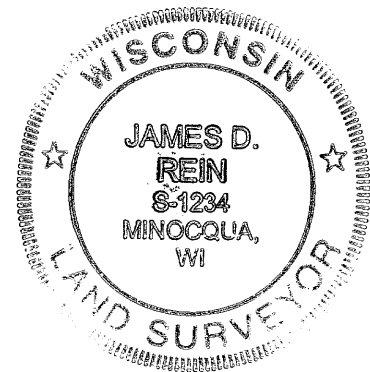

**WILDERNESS SURVEYING, INC.**

*[Signature]*  
Registered Land Surveyor # S-1234  
Dated this 16th day of September, 2005.

MAP #	<b>B5930</b>
DATE FILED	<b>SEP 26 2005</b>
BY	<i>[Signature]</i>
DESCRIPTION FILED	
ONEIDA CO. SURVEYOR'S OFFICE	

<b>WILDERNESS SURVEYING, INC.</b>	
Post Office Box 1111 - 8793 Earls Court Minocqua, Wisconsin 54548-1111 Telephone (715) 356-5100 - www.wildernesssurveying.com	
Map Number: 05-94 File Number: 13-21-386 Drafted by: Mike Schneider	Revisions:

Bearings assumed,  
referenced to the north  
line of Lot 1,  
bearing S87°21'37"E.

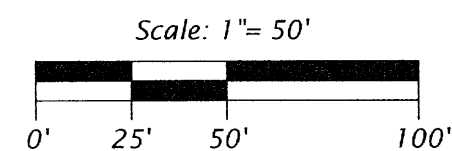

- Legend**
- = 2.4" dia. iron pipe found in place.
  - = 1.7" dia. iron pipe found in place.
  - = 1.3" dia. iron pipe found in place.
  - = Utility pole
  - ☒ = Telephone pedestal
  - - - = Edge of wetland
  - - - = Overhead power line.
- Pipe sizes are outside diameter dimension.