

north

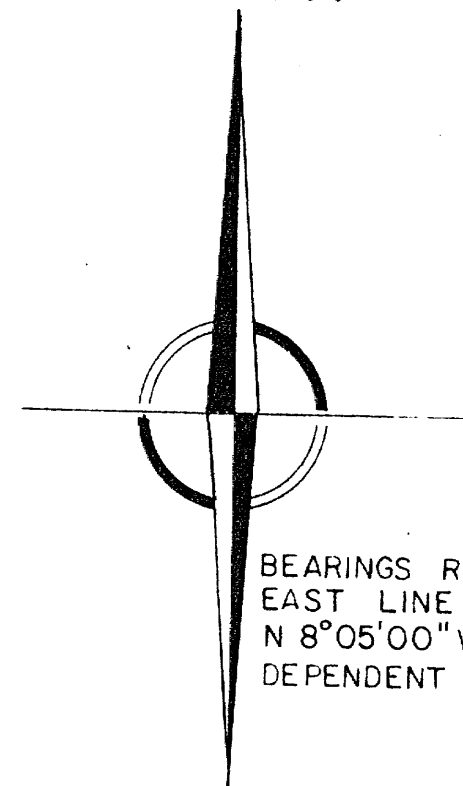

BEARINGS REFERENCED TO  
EAST LINE OF SECTION 21  
N 8°05'00"W per G.L.O. 1939  
DEPENDENT RESURVEY

detail A 1" = 50'

1/4 CORNER  
FOUND G.L.O. BRASS CAPPED  
CONCRETE MONUMENT  
S 21 S 22

EMMA

LAKE

plat of survey - part of

GOVERNMENT LOT 8, SECTION 21  
TOWNSHIP 36 NORTH, RANGE 8 EAST  
ONEIDA COUNTY, WISCONSIN

I HEREBY CERTIFY, THAT I HAVE SURVEYED THE ABOVE PARCELS  
OF LAND UNDER THE DIRECTION OF THE ABOVE OWNERS, AND  
THE ABOVE MAP IS A TRUE AND CORRECT REPRESENTATION,  
OF THE LAND SURVEYED TO THE BEST OF MY BELIEF AND  
KNOWLEDGE.

William G. Immich  
WILLIAM IMMICH R.L.S.

November 6, 1984  
date

DESCRIPTION PROVIDED ON SEPARATE SHEET

- FOUND IRON PIPE
- FOUND WOODEN HUB REPLACED WITH 1" IRON PIPE
- SET 1" x 24" IRON PIPE
- SET 2" x 30" IRON PIPE

NOTE: DISTANCES IN PARENTHESIS ARE AS RECORDED.  
AREAS INCLUDE ROAD RIGHT OF WAY.

PART OF THESE LOTS LAY IN THE ERRONEOUS MEANDERED  
EMMA LAKE, PER G.L.O. 1939 DEPENDANT RESURVEY, IT  
HAS BEEN DETERMINED BY THE WISCONSIN SUPREME COURT,  
THAT GOVERNMENT LOT 8 EXTENDS TO THE ORDINARY HIGH  
WATER MARK OF EMMA LAKE.

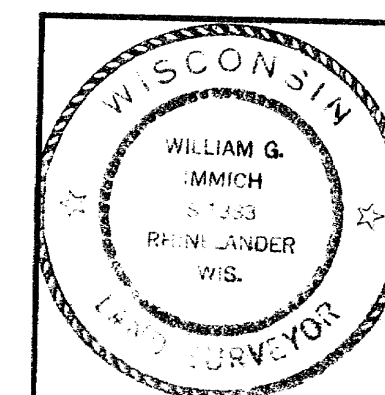

**COOK, DECKER & THIEL**  
**COOK DRIVE**  
**RHINELANDER, WISC.**

SCALE 1"=100' DATE 11/6/84 DWN. BY W.I.  
DWG. NO. 7555 GENISOT AND ASSOCIATES, INC.  
RHINELANDER, WIS.

MAP # B6346  
DATE FILED APR 21 2006  
BY [Signature]  
DESCRIPTION FILED  
ONEIDA CO. SURVEYOR'S OFFICE

detail B 1" = 50'