

Capped 2.4" dia. aluminum monument found in place.



TOWNSHIP 40 NORTH
TOWNSHIP 39 NORTH

S 89°46'41"W 2577.56'

Meander Corner
brass capped 1.9" dia.
iron pipe found in place.

SNAKE
LAKE

Lot 4
and part of
Lots 1, 2, & 3
Block 5
in the original plat

VILLAGE OF WOODRUFF

located in
GOV'T. LOT 1

and in the

NW 1/4 of the SE 1/4
SECTION 2, T39N, R6E

Woodruff Township
Oneida County, Wisconsin

SURVEYOR'S CERTIFICATE

I, James D. Rein, Registered Land Surveyor No. S-1234, hereby certify that I have surveyed the property shown hereon; that this map represents an accurate survey of said property to the best of my knowledge and belief; that I have performed this survey by order of Scott Storey; and that I have complied with the requirements of Wisconsin Administrative Code A-E 7.

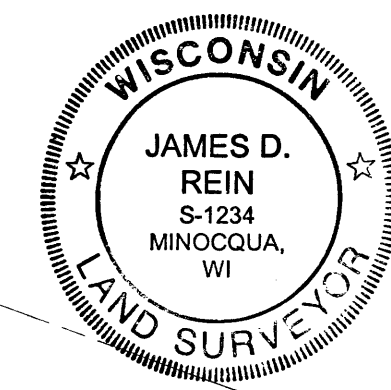

WILDERNESS
SURVEYING, INC.

[Signature]
Registered Land Surveyor # S-1234
Dated this 14th day of December, 2006

Parcel 2
Document #607849
6,988 sq. ft.
0.16 acres

Parcel 1
Document #607849
7,479 sq. ft.
0.17 acres

LEGEND

- = Set iron pipe; 1.0" dia. x 24" long.
 - ⊙ = Set masonry nail in concrete curb.
 - ⊙ = 1.0" dia. iron pipe found in place.
 - ⊙ = 1.25" dia. axle shaft found in place.
 - ⊙ = 1.5" dia. iron rod with stem, possible axle shaft, found in place.
 - ⊙ = 1.5" dia. iron rod found in place.
 - () = Bearings and distances of record as shown on survey filed in the Oneida County Surveyor's Office as Map No. C83.
- Monument sizes are outside diameter dimension.
Other corner monuments are as noted.

Bearings Oneida County Grid,
based on GPS survey data,
referenced to part of the north
line of the NE 1/4, Section 2
bearing S 89°46'41"W

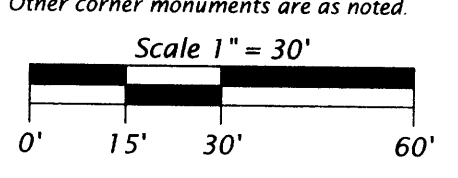

WILDERNESS SURVEYING, INC.
Post Office Box 1111 - 8793 Earls Court
Minocqua, Wisconsin 54548-1111

Telephone (715) 356-5100 - www.wildernesssurveying.com

Map Number: 06-139
File Number: 9-2-396
Drafted by: J. Dick

Revisions: