

MAP # **88803**
DATE FILED **MAY 25 2007**
BY *[Signature]*
DESCRIPTION FILED
ONEIDA CO. SURVEYOR'S OFFICE

ONEIDA
(U.S. HIGHWAY "51")
STREET

Bearing base assumed
referenced to the south line of
Lot 11 of Block 3
bearing S 81° 57' 58" W

Scale: 1" = 10'
0' 5' 10' 20'

Legend

- = Set iron pipe, 1.0" dia. x 24" long
- = 1.0" dia. iron pipe found in place
- ⊕ = Survey marker nail set
- ⊗ = Survey marker nail previously found in place
- ⊙ = P.K. nail set
- = Drill hole in concrete previously found in place
- △ = Computed position, not monumented
- ▭ = Existing building.

Monument sizes are outside diameter dimension

Note:
See W.S.I. Map No. 89-94,
96-40, and 99-86 for previous
adjoining survey information.

LOT 11
of
BLOCK 3
in the Plat of
VILLAGE OF MINOCQUA
in
GOV'T. LOT 5
SECTION 14, T39N, R6E

Minocqua Township
Oneida County, Wisconsin
SURVEYOR'S CERTIFICATE

I, James L. Rein, Registered Land Surveyor No. S-2335, hereby certify that I have surveyed the property shown hereon; that this map represents an accurate survey of said property to the best of my knowledge and belief; that I have performed this survey by order of Thomas Michaels; and that I have complied with the requirements of Wisconsin Administrative Code A-E 7.

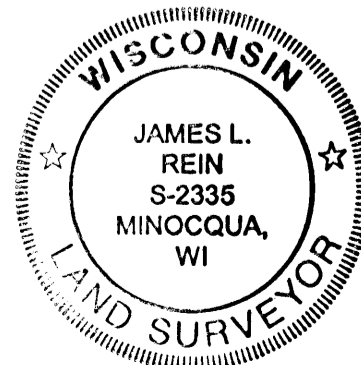

WILDERNESS
SURVEYING,
INC.

Registered Land Surveyor # S-2335
Dated this 24th day of August, 2006

WILDERNESS SURVEYING, INC.

Post Office Box 1111 - 8793 Earls Court
Minocqua, Wisconsin 54548-1111

Telephone (715) 356-5100 - www.wildernesssurveying.com

Map Number: 06-66

File Number: 14-396

Drafted by: Mike Schneider

Revisions: 5/15/07