

37058

37058

All of  
**LOT 5**  
and part of  
**LOT 4**  
of the  
**FIRST ADDITION**  
TO  
**POTTAWATTOMIE LODGE**  
Being part of  
**GOV'T. LOT 1**  
**SECTION 36, T39N, R6E**  
Town of Minocqua  
Oneida County, Wisconsin

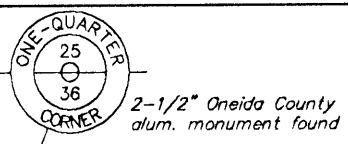
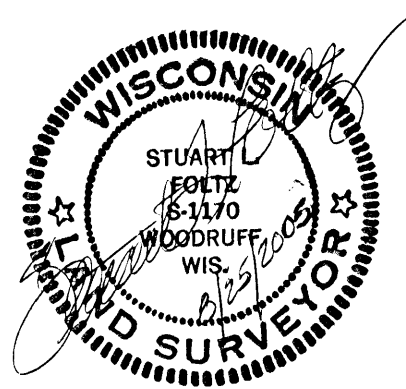

Map # 37058  
DATE FILED SEP 26 2008  
JAD  
MINOCQUA TOWNSHIP  
ONEIDA CO., WISCONSIN  
REGISTERED SURVEYOR'S OFFICE

Bearings  
Magnetic

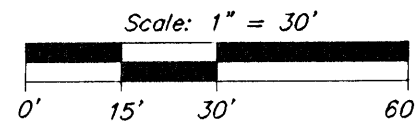

- = 1-1/4" iron rod found
- ⊙ = 1" iron pipe found
- ⊙ = P.K. nail set over 1" iron pipe found in pvm't.
- ⊙ = P.K. nail set in pvm't.
- = 1" iron pipe set
- ( ) = previously recorded

I hereby certify to the present owner(s) and/or purchaser(s) of the property included in this survey, and to those who mortgage or guarantee title for the present owner(s) or purchaser(s) within one year from the date hereof, that this survey was performed in accordance with acceptable professional standards; that the survey data shown hereon is, to the best of my knowledge, information and belief, a true and accurate representation thereof; that any legal descriptions conforming to this survey have been provided on separate sheets; and that this survey was performed by order of Tom Swaney.

POTTAWATTOMIE LODGE  
P. 534

NOTE: This survey is based on title information contained in Chicago Title Insurance Co. ALTA Commitment No. ON 32966, effective Nov. 12, 2003, issued by Oneida Title & Abstract, Inc. of Rhinelander, WI.

**Foltz and Associates, Inc.**  
Surveyors Engineers  
8512 Highway 51 North, Minocqua, Wisconsin 54548  
(715) 356-9485 fax (715) 356-1841

C. Winkler 4-36-396

37058

37058