

PART OF  
GOVERNMENT LOT 7  
SECTION 17  
AND PART OF THE  
SOUTHEAST 1/4 OF THE SOUTHEAST 1/4  
SECTION 18  
TOWNSHIP 38 NORTH, RANGE 8 EAST  
TOWN OF NEWBOLD  
ONEIDA COUNTY, WISCONSIN

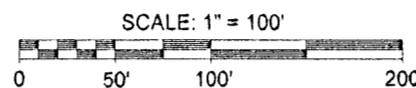

- LEGEND
- - 1" Iron Pipe Found
  - ⊙ - 1 1/4" Iron Pipe Found
  - ⦶ - 2" Iron Pipe Found
  - ⬢ - Aluminum Monument Found
  - - 1 3/4" X 18" Iron Pipe Set Weighing at least 2.72 lbs per lineal foot.
  - △ - Survey Marker Nail Set (Over Magnetic Dip)
  - + - Utility Pole
  - Above Ground Utility Lines
  - ▨ - Existing Structures (shown per eaves)
  - ( ) - Recorded as values (NOTE: Iron pipe diameter is outside diameter)

ASSUMED NORTH, BASED ON THE NORTHERLY LINE OF PARCEL A WHICH BEARS S 87°17'31" E



LINE TABLE		
Line	Bearing	Distance
L1	S 64°47'44" W	34.41'
L2	S 47°36'10" W	39.07'
L3	S 82°31'02" W	54.85'
L4	N 29°58'00" W	7.01'
L5	S 30°05'15" E	8.76'
L6	N 30°05'15" W	16.91'
L7	S 82°31'02" W	67.09'

CURVE TABLE				
Curve	Delta Angle	Radius	Arc	Chord
C1	28°57'59" (28°57'28")	125.50' (125.50')	63.45' (63.43')	62.77' (62.76')
C2	43°42'55" (43°43'00")	350.09' (350.09')	267.11' (267.12')	260.68' (260.68')
C3	16°13'19" (16°13'20")	531.89' (531.89')	150.59' (150.60')	150.09' (150.10')
C4	119°58'26" (119°58'26")	59.50' (59.50')	124.59' (124.59')	103.04' (103.04')
C5	43°42'55" (43°42'55")	284.09' (284.09')	216.75' (216.75')	211.53' (211.53')
C6	16°13'19" (16°13'19")	465.89' (465.89')	131.91' (131.91')	131.47' (131.47')
C7	74°29'19" (74°29'19")	125.50' (125.50')	163.16' (163.16')	151.91' (151.91')
C8	16°31'08" (16°31'08")	125.50' (125.50')	36.18' (36.18')	36.06' (36.06')
C9	60°16'06" (60°16'06")	62.16' (62.16')	65.38' (65.38')	62.41' (62.41')
C10	40°16'38" (40°16'38")	133.66' (133.66')	93.96' (93.96')	92.03' (92.03')

NOTE: FLAGGED PARCEL LINES WITH SURVEYOR'S RIBBON ARE ONLY A REPRESENTATION OF THE PROPERTY LINE AND SHOULD NOT BE USED FOR CONSTRUCTION PURPOSES.

NOTE: EXISTING STRUCTURES LOCATED / SHOWN PER EAVE.

DESCRIPTION (PARCEL A)

Part of Government Lot 7, Section 17 and Part of the Southeast 1/4 of the Southeast 1/4 Section 18, Township 38 North, Range 8 East, town of Newbold, Oneida County, Wisconsin shown on a survey map by McMullen & Associates, Incorporated of Minocqua, Wisconsin dated the 13th Day of December, 2006 with a job number of 206083 and more particularly described as follows:

Commencing at the Section Corner common to Sections 17, 18, 19 and 20 marked by an Aluminum Monument, said Section Corner being the POINT OF BEGINNING.

Thence North 85° 46' 17" West along the South line of Section 18 (Assumed North, based on the Northerly line of Parcel described herein which bears South 87° 17' 31" East), a distance of 400.42 feet to a 1 1/4" iron pipe; thence leaving said Section line North 0° 08' 35" West, a distance of 128.58 feet to a survey marker nail in an existing road; thence along the Southerly edge of said road a distance of 65.38 feet along the arc of a curve concaved Southerly having a radius of 62.16 feet, a delta angle of 60° 16' 06" and a long chord which bears North 89° 47' 27" West, 62.41 feet to a 1 3/4" iron pipe; thence continuing along said road edge South 64° 47' 44" West, a distance of 34.41 feet to a 1 1/4" iron pipe; thence continuing along said road edge South 47° 36' 10" West, a distance of 39.07 feet to a 1 1/4" iron pipe; thence continuing along said road edge a distance of 93.96 feet along the arc of a curve concaved Northwesterly having a radius of 133.66 feet, a delta angle of 40° 16' 38" and a long chord which bears South 65° 03' 36" West, 92.03 feet to a 1 3/4" iron pipe; thence continuing along said road edge South 82° 31' 02" West, a distance of 54.85 feet to a 1 1/4" iron pipe on the Easterly right-of-way of North Shore Drive; thence along said right-of-way a distance of 163.16 feet along the arc of a curve concaved Westerly having a radius of 125.50 feet, a delta angle of 74° 29' 19" and a long chord which bears North 7° 09' 25" East, 151.91 feet to a 1 1/4" iron pipe; thence continuing along said right-of-way North 30° 05' 15" West, a distance of 16.91 feet to a 1" iron pipe; thence leaving said right-of-way South 87° 17' 31" East, a distance of 760.13 feet to a 1" iron pipe near the Westerly shore of Two Sisters Lake; thence meandering along said lake shore South 14° 57' 09" West, a distance of 93.57 feet to a 1 1/4" iron pipe; thence continuing said meander South 13° 42' 46" West, a distance of 110.30 feet to a 1 1/4" iron pipe marking a Meander Corner between Sections 17 and Section 20; thence leaving said lake shore South 86° 51' 04" West, a distance of 59.66 feet to the POINT OF BEGINNING;

Said described tract containing 2.88 acres (125469 square feet), more or less.

Subject to any easements, restrictions, or rights of way of record or of use.

Including all those lands lying between the above described meander lines and the water's edge of Two Sisters Lake.

Subject to an easement per Volume 366 on Page 361 recorded at the Oneida County Register of Deeds Office.

DESCRIPTION (PARCEL B)

Part of the Southeast 1/4 of the Southeast 1/4, Section 18, Township 38 North, Range 8 East, town of Newbold, Oneida County, Wisconsin shown on a survey map by McMullen & Associates, Incorporated of Minocqua, Wisconsin dated the 13th Day of December, 2006 with a job number of 206083 and more particularly described as follows:

Commencing at the Section Corner common to Sections 17, 18, 19, and 20 marked by an Aluminum Monument; thence North 85° 46' 17" West along the South line of Section 18 (Assumed North, based on the Northerly line of Parcel A shown on said survey map which bears South 87° 17' 31" East), a distance of 400.42 feet to a 1 1/4" iron pipe; thence leaving said Section line North 0° 08' 35" West, a distance of 128.58 feet to a survey marker nail in an existing road; thence along said road edge a distance of 65.38 feet along the arc of a curve concaved Southerly having a radius of 62.16 feet, a delta angle of 60° 16' 06" and a long chord which bears North 89° 47' 27" West, 62.41 feet to a 1 3/4" iron pipe; thence continuing along said road edge South 64° 47' 44" West, a distance of 34.41 feet to a 1 1/4" iron pipe; thence continuing along said road edge South 47° 36' 10" West, a distance of 39.07 feet to a 1 1/4" iron pipe; thence continuing along said road edge a distance of 93.96 feet along the arc of a curve concaved Northwesterly having a radius of 133.66 feet, a delta angle of 40° 16' 38" and a long chord which bears South 65° 03' 36" West, 92.03 feet to a 1 3/4" iron pipe; thence continuing along said road edge South 82° 31' 02" West, a distance of 54.85 feet to a 1 1/4" iron pipe on the Easterly right-of-way of North Shore Drive; thence leaving said Easterly right-of-way North 72° 27' 21" West, a distance of 93.92 feet to a 1 3/4" iron pipe on the Westerly right-of-way of said road, said iron pipe being the POINT OF BEGINNING.

Thence along said right-of-way South 89° 52' 42" West, a distance of 230.05 feet to a 1 3/4" iron pipe; thence continuing along said right-of-way a distance of 216.75 feet along the arc of a curve concaved Northeasterly having a radius of 284.09 feet, a delta angle of 43° 42' 55" and a long chord which bears North 68° 15' 48" West, 211.53 feet to a 1 3/4" iron pipe; thence continuing along said right-of-way North 46° 23' 38" West, a distance of 76.53 feet to a 1 3/4" iron pipe; thence continuing along said right-of-way a distance of 131.91 feet along the arc of a curve concaved Northeasterly, having a radius of 465.89 feet, a delta angle of 16° 13' 19" and a long chord which bears North 38° 17' 48" West, 131.47 feet to a 1 3/4" iron pipe; thence continuing along said right-of-way North 29° 58' 00" West, a distance of 7.01 feet to a 1 1/4" iron pipe; thence leaving said right-of-way North 89° 59' 11" East, a distance of 474.97 feet to a 1 3/4" iron pipe on said right-of-way; thence along said right-of-way South 44° 09' 28" East, a distance of 199.45 feet to a 1 3/4" iron pipe; thence continuing along said right-of-way South 30° 05' 15" East, a distance of 8.76 feet to a 1 3/4" iron pipe; thence continuing along said right-of-way a distance 124.59 feet having a radius of 59.50 feet, a delta angle 119° 58' 26" and a long chord which bears South 29° 53' 58" West, 103.04 feet to the POINT OF BEGINNING.

Said described tract containing 2.57 acres (111970 square feet), more or less.

Subject to any easements, restrictions, or rights of way of record or of use.

SURVEYOR'S CERTIFICATE

I, Benton A. McMullen, Wisconsin Registered Land Surveyor # S-2555, do hereby certify that I have surveyed and mapped the property shown hereon, and that I have complied with the applicable requirements of the Wisconsin Administrative Code Chapter A-E 7, and that this map represents a true and accurate survey of said property to the best of my knowledge and belief.

This survey was performed under the order of:  
John Ryan

This survey is made for the use of the present owners of the property, and also those who purchase, mortgage, or guarantee the title thereto within one year from date hereof.

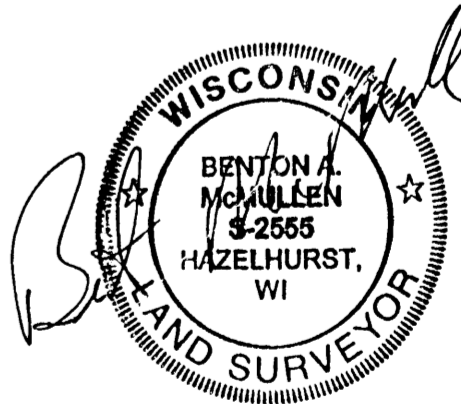

Registered Land Surveyor # S-2555  
Benton A. McMullen  
Revised the 13th Day of December, 2006:  
To Modify Parcel A.

MCMULLEN & ASSOCIATES, INCORPORATED.  
LAND SURVEYING AND SOIL TESTING  
9832 BOLGER LAKE ROAD  
MINOCQUA, WISCONSIN 54548  
TELEPHONE # (715) 356-3011 FAX # (715) 356-1501

DRAFTED BY: Dwight A. Miesbauer DATE: October 3rd, 2006  
SCALE: 1" = 100' JOB # 206083