

MAP # 87274  
 DATE FILED 2/11/10  
 BY JH  
 DESCRIPTION  
 ONEIDA CO. SURVEYOR'S OFFICE

**SWNE 1/4, SEC. 3, T. 37 N., R. 10 E.,  
 TOWN OF STELLA, ONEIDA COUNTY,  
 WI.**

**FOR  
 GILBERT SPAFFORD**

- LEGEND**
- SUBDIVISIONAL MON. FOUND
  - ⊙ SUBDIVISIONAL MON. SET
  - REFERENCE MON. SET
  - IRON SPIKE SET

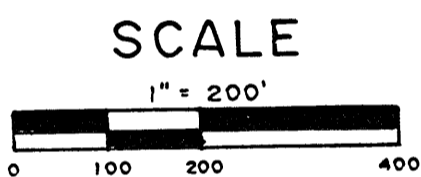

Pond, creek and woods road  
 Locations are approximate.



North is referenced to the N-S 1/4 line  
 Being an assumed bearing of N 3° 43' 09\" E.

REVISED JANUARY 20<sup>TH</sup>, 2010  
 TO PROVIDE WITNESS CORNERS  
 FOR C 1/4 LOCATION. CORNER  
 SET IN 2004 HAS BEEN WASHED  
 OUT BY SPRING FLOODING.

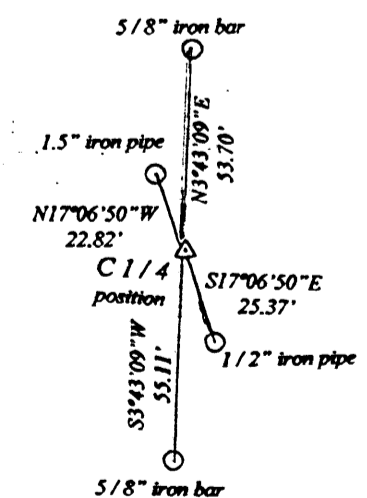

I, Todd Loftus, Registered Land Surveyor, hereby certify that I have surveyed the property shown hereon. That this map represents an accurate survey of said property to the best of my knowledge & belief. That I have performed this survey by order of *Gilbert Spafford* and that I have complied with the applicable requirements of the Wisconsin Administrative Code A.E.7.

Description required for above parcel is on separate sheet.

DATE March 25, 2004

SIGNED *Todd Loftus*

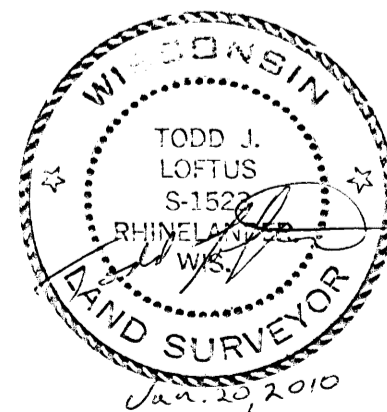

Loftus Surveying  
 860 Balsam Street  
 Rhinelander, WI.