

Oneida County Certified Survey Map No. 3341
Volume 14 CSM on page 3341

being part of

GOV'T. LOT 7
SECTION 18, T39N, R7E

Town of Woodruff,
Oneida County, Wisconsin

SURVEYOR'S CERTIFICATE

I, James D. Rein, Registered Land Surveyor No. S-1234, hereby certify that I have surveyed the property shown hereon; that this map represents an accurate survey of said property to the best of my knowledge and belief; that I have performed this survey by order of Jeremy Ceranski; and that I have complied with the requirements of Wisconsin Administrative Code A-E 7.

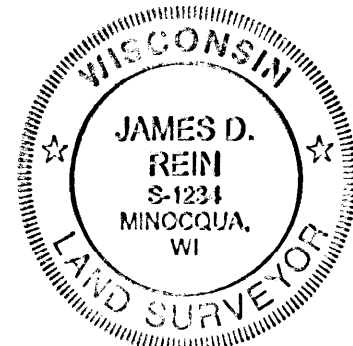

WILDERNESS SURVEYING, INC.

[Signature]

Registered Land Surveyor No. S-1234
Dated this 3rd day of May, 2011

Bearings Oneida County Grid
based on GPS survey data,
referenced to the east line of
the SE 1/4 of Section 18,
bearing S 00°08'24"E

LEGEND

- = Set iron pipe; 1.0" dia. x 48" long.
- ⊙ = 1.0" dia. iron pipe previously set by W.S.I.
- ⦿ = 1.0" dia. iron pipe previously found in place.
- △ = Computed position, not monumented.
- () = Bearing and distance of record.

Monument sizes are outside diameter dimension.
Other corner monuments are as noted.

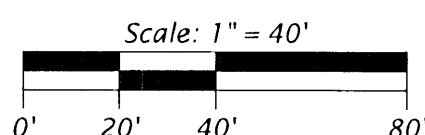

MAP #	B7431
DATE FILED	5/20/11
BY	<i>[Signature]</i>
DESCRIPTION FILED	
ONEIDA CO. SURVEYOR'S OFFICE	

FLOWAGE

AREA

MID

LAKE

**Lot -2-
CSM #3341**

±71,820 sq. ft.

±1.64 acres

(± 47,050 sq. ft. excluding flowage)

(±1.08 acres excluding flowage)

*Lot-3-
CSM #3341*

*Lot-1-
CSM #3341*

*Lot-1-
Block 1*

PLAT of

MID

LAKE

*FOREST
Lot-1-
Block 2*

LAKESHORE DRIVE
(platted road)

PROPOSED ACCESS EASEMENT (Map No. 11-08)

A strip of land, ten (10) feet in width and for the purposes of an access easement, located within Lot 2 of Oneida County Certified Survey Map No. 3341, recorded in Volume 14 CSM on page 3341, being part of Government Lot 7, Section 18, Township 39 North, Range 7 East, Oneida County, Wisconsin, being "Proposed Access Easement" shown on Map No. 11-08 by Wilderness Surveying, Inc., dated May 3, 2011, the northerly line of said strip of land being more particularly described as follows:

Commencing at the southeast corner of Section 18, marked by an iron axle shaft; thence North 89 degrees 19 minutes 36 seconds West for a distance of 1326.65 feet along the south line of Section 18 to the East Sixteenth Corner, marked by an iron axle shaft; thence North 00 degrees 08 minutes 14 seconds East for a distance of 617.41 feet along the east line of Government Lot 7 to an iron pipe at the southeasterly corner of Lot 3 of Oneida County Certified Survey Map No. 3341; thence North 78 degrees 40 minutes 17 seconds West for a distance of 249.80 feet along the southerly line of said Lot 3 to an iron pipe; thence North 01 degrees 57 minutes 24 seconds East for a distance of 52.27 feet along the westerly line of said Lot 3 to an iron pipe; thence continuing along the westerly line of said Lot 3, along a curve to the left, having a radius of 45.00 feet and an arc length of 33.70 feet, being subtended by a chord of North 45 degrees 10 minutes 42 seconds East for a distance of 32.92 feet to an iron pipe on the line common to Lots 2 and 3 of said Certified Survey Map; thence South 48 degrees 58 minutes 28 seconds East for a distance of 28.07 feet along the line common to said Lots 2 and 3 to an iron pipe; thence South 78 degrees 40 minutes 34 seconds East for a distance of 119.74 feet along the line common to said Lots 2 and 3 to an iron pipe; thence North 16 degrees 07 minutes 41 seconds West for a distance of 227.42 feet along the line common to said Lots 2 and 3 to an iron pipe; thence North 45 degrees 59 minutes 59 seconds West for a distance of 23.82 feet along the line common to said Lots 2 and 3 to the place of beginning of the northerly line of said strip of land.

Thence South 59 degrees 07 minutes 51 seconds West for a distance of 27.44 feet; thence South 65 degrees 02 minutes 05 seconds West for a distance of 55.38 feet; thence North 86 degrees 36 minutes 45 seconds West for a distance of 52.35 feet; thence South 59 degrees 16 minutes 44 seconds West for a distance of 45.71 feet; thence North 85 degrees 35 minutes 09 seconds West for a distance of 43.47 feet; thence North 50 degrees 30 minutes 55 seconds West for a distance of 43.66 feet; thence North 53 degrees 18 minutes 54 seconds West for a distance of 78.51 feet to the line common to said Lots 2 and 3 and there terminating.

The southerly line of the above described strip of land lengthens or shortens to begin and to terminate on the line common to Lots 2 and 3 of Oneida County Certified Survey Map No. 3341.

Brass capped 2.0" dia.
iron pipe previously
found in place.



SE 1/16 Corner
1.0" dia. iron
pipe previously
set by W.S.I.

748.68'

1366.09'

S 00°08'24"E

2669.94'

E 1/16 Corner
1.0" dia. iron axle
shaft previously
found in place.

N 89°19'36"W
1326.65'

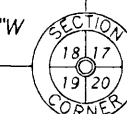

1.0" dia. iron axle
shaft previously
found in place.

WILDERNESS SURVEYING, INC.

Post Office Box 1111 - 8793 Earls Court
Minocqua, Wisconsin 54548-1111

Telephone (715) 356-5100 - www.wildernesssurveying.com

Map Number: 11-08
File Number: 15-18-397
Drafted by: J. Dick

Revisions: