

"Topographic Survey"
 Lot -2- of
 Certified Survey Map No. 1795
 being located in
 Part of Government Lot 3
 Section 36, Township 39 North, Range 6 East
 Town of Minocqua
 Oneida County, Wisconsin

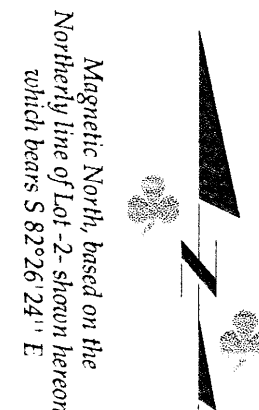
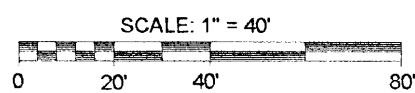

Low Wet Area
 (Subject to Flowage Rights)
 Per Map No. C 2455
 recorded at the
 Oneida County Land Information Office

Parcel No. M1 - 2525 - 3
 Document No. 636855

Wet Land

This wet land was determined to be part of
 Tomahawk Lake per C.S.M. #1795.

- LEGEND**
- - 1.050" Iron Pipe Found
 - ▲ - Calculated Point (not monumented per this survey)
 - ⊙ - Elevation Point
 - W - Well
 - ST - Septic Tank
 - SV - Septic Vent
 - IGLP - In Ground L.P. Tank
 - UP - Utility Pole
 - TP - Telephone Pedestal
 - ES - Existing Structure (shown per exterior walls)
 - ED - Existing Driveway / Paths
 - ELHE - Existing Limited Highway Easement Per C.S.M. No. 1795
 - 80' - Contours
 - B.M. -1- - Bench Mark -1-, Top of Well with an Elevation of 88.9'
 - B.M. -2- - Bench Mark -2-, Magnetic Nail in a 12" Red Pine with an Elevation of 81.0'
 - () - Recorded as values
 (NOTE: Iron pipe diameter is outside diameter)

Curve Data

Curve	Delta Angle	Radius	Tangent	Chord	Chord Bearing
C1	35°48'30"	103.00'	33.28'	63.33'	N 4°53'41" E
	(35°50'59")	(103.00')	(33.32')	(63.40')	(N 2°23'02" W)
C2	43°00'02"	229.00'	90.21'	167.86'	N 19°31'04" W
	(43°00'00")	(229.00')	(90.21')	(167.86')	(N 26°46'48" W)
C3	5°43'13"	120.92'	6.04'	12.07'	N 38°16'35" W
	(5°42'58")	(120.92')	(6.04')	(12.06')	(N 45°25'19" W)

Note: Lot lines were not flagged / marked per this survey.

Note: It is not the intent of this survey to show all easements.

Note: Tomahawk Lake is part of a Flowage System.

Note: No recorded easement was found for the "Above Ground Utility Lines". Wisconsin Public Service has rights to maintain these lines.

The field work pertaining to this survey was completed on the 7th Day of December, 2010.
 Field survey work for the revision was completed on the 22nd day of September, 2011.

SURVEYOR'S CERTIFICATE

I, Benton A. McMullen, Wisconsin Registered Land Surveyor # S-2555, do hereby certify that I have surveyed and mapped the property shown hereon, and that I have complied with the applicable requirements of the Wisconsin Administrative Code Chapter A-E 7, and that this map represents a true and accurate survey of said property to the best of my knowledge and belief.

This survey was performed under the order of:
 John T. and Kate F. Fitzgerald

This survey is made for the use of the present owners of the property, and also those who purchase, mortgage, or guarantee the title thereto within one year from date hereof.

Registered Land Surveyor # S-2555
 Benton A. McMullen

REVISED - 9/29/2011 - Added the contour lines on the north side of the lot. Drafted by Benton A. McMullen. Job #211041

MCMULLEN & ASSOCIATES, INCORPORATED.
 "YOUR TRUE NORTH SURVEYORS AND SOIL TESTERS"
 9729 WHISPERING OAK COURT
 MINOCQUA, WISCONSIN 54548
 TELEPHONE # (715) 356-3011 FAX # (715) 356-1501

"Fitzgerald Topographic Survey"
 Lot -2- of Certified Survey Map No. 1795
 being located in Part of Government Lot 3
 Section 36, Township 39 North, Range 6 East
 Town of Minocqua, Oneida County, Wisconsin

DRAFTED BY: Dwight A. Miesbauer DATE: December 10th, 2010
 SCALE: 1" = 40' JOB No. 211003

MAP # 37521
 DATE FILED 2/13/12
 BY 24
 DESCRIPTION FILED
 ONEIDA CO. SURVEYOR'S OFFICE