



2-1/2" Oneida County alum.
monument found

(S89°31'00"E, 1317.85')
S89°31'00"E
1317.80'

SW-NW
NW-SW

C-W1/16 Corner
1-1/4" iron rod found

SE-NW
NE-SW
S89°31'14"E
901.90'



2" iron pipe found

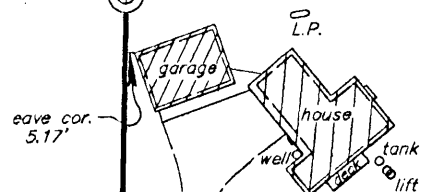

DOC.

4.58 acres

#483476

464.88'
S64°45'54"W

Part of the
NE1/4 of the SW1/4
SECTION 22, T38N, R6E
Town of Hazelhurst
Oneida County, Wisconsin

-3-

460.37'
S64°29'32"W
(S64°30'00"W, 460.00')

County

-16-

(N171°3'E, 1321.64')

N170°35'E
874.04'

Bearings Magnetic,
based on the
N. Line of the NW-SW
bearing S89°31'00"E.

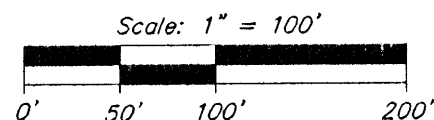

SW1/16 Corner
1-1/4" iron rod found

- ① = 1-1/4" iron rod found
- = 1" iron pipe set
- () = previously recorded

PARCEL DESCRIPTION

A parcel of land in the NE1/4 of the SW1/4, Section 22, Township 38 North, Range 6 East, in the Town of Hazelhurst, Oneida County, Wisconsin, more particularly described as follows:

Commencing at the Quarter Corner to Sections 21 and 22, marked by a 2-1/2" Oneida County aluminum monument; thence S89°31'00"E, 1317.80 feet to the place of beginning at the northwest corner of the NE1/4 of the SW1/4, the Center-West 1/16th Corner of Section 22, marked by a 1/4" iron rod.

Thence S89°31'14"E, 901.90 feet coincident with the north line of the NE1/4 of the SW1/4 to a 1" iron pipe on the north right-of-way line of County Highway "Y"; thence coincident with said right-of-way line: S64°45'54"W, 464.88 feet to a 1" iron pipe; and S63°48'44"W, 546.64 feet to a 1/4" iron rod on the west line of the NE1/4 of the SW1/4; thence leaving said right-of-way line N1°10'35"E, 447.07 feet coincident with the west line of the NE1/4 of the SW1/4 to the place of beginning.

Said parcel of land has an area of 4.58 acres.

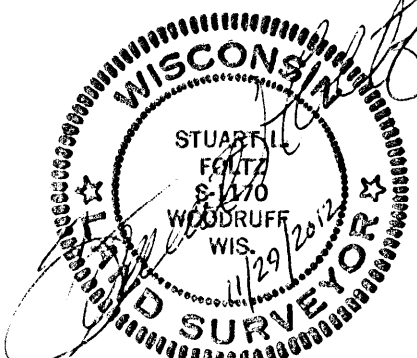

I have surveyed the property described hereon, and this map is a true representation thereof and shows the size and location of the property, its exterior boundaries, the location and dimensions of all structures thereon, fences, apparent easements and roadways and visible encroachments, if any. This survey is made for the exclusive use of the present owners of the property, and also those who purchase, mortgage, or insure the title thereto within one (1) year from date hereof; and as to them I warrant the accuracy of said survey map. This survey was done by order of John Winger.

MAP # 37588
DATE FILED 12-17-12
BY JB
DESCRIPTION FILED
ONEIDA CO. SURVEYOR'S OFFICE

Foltz and Associates, Inc.

Surveyors Engineers
8612 Highway 51 North, Minocqua, Wisconsin 54548
(715) 356-9485 fax (715) 356-1841