

37750
Squirrel
Lake

Lake

NE 1/4 of the NW 1/4 SECTION 16, T39N, R5E

Town of Minocqua
Oneida County, Wisconsin

SURVEYOR'S CERTIFICATE

I, James L. Rein, Professional Land Surveyor No. S-2335, hereby certify that I have surveyed the property shown hereon; that this map represents an accurate survey of said property to the best of my knowledge and belief; that I have performed this survey by order of Kandace L. Lynn; and that I have complied with the requirements of Wisconsin Administrative Code A-E 7.

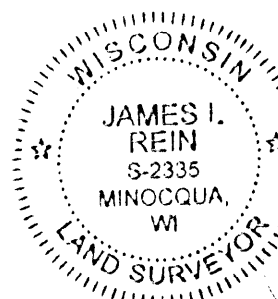

WILDERNESS SURVEYING, INC.
Professional Land Surveyor # S-2335
Dated this 1st day of August, 2014
Revised: January 7, 2015

PARCEL -A- REVISED (MAP NO. 14-84REV)

A parcel of land in the Northeast Quarter of the Northwest Quarter, Section 16, Township 39 North, Range 5 East, Town of Minocqua, Oneida County, Wisconsin, being parcel "A- Revised" shown on Map Number 14-84rev by Wilderness Surveying, Inc., dated January 7, 2015, more particularly described as follows:

Commencing at the Quarter Corner common to Sections 9 and 16, marked by a capped iron rebar; thence South 03 degrees 02 minutes 18 seconds East for a distance of 1318.21 feet along the east line of the Northeast Quarter of the Northwest Quarter to the southeast corner thereof, being the North Sixteenth Corner, marked by an iron pipe; thence South 88 degrees 28 minutes 24 seconds West for a distance of 1319.22 feet along the south line of the Northeast Quarter of the Northwest Quarter to the southwest corner thereof, being the Northwest Sixteenth Corner, marked by an iron pipe; thence North 03 degrees 42 minutes 43 seconds West for a distance of 611.13 feet along the west line of the Northeast Quarter of the Northwest Quarter to the place of beginning, marked by an iron pipe.

Thence continuing North 03 degrees 42 minutes 43 seconds West for a distance of 700.07 feet along the west line of the Northeast Quarter of the Northwest Quarter to the northwest corner thereof, being the West Sixteenth Corner, marked by an iron pipe; thence North 88 degrees 06 minutes 24 seconds East for a distance of 186.16 feet along the north line of the Northeast Quarter of the Northwest Quarter to the Meander Corner where the north line of the Northeast Quarter of the Northwest Quarter intersects the southwesterly shore of Inkpot Lake; thence meandering along the lake, South 45 degrees 03 minutes 51 seconds East for a distance of 137.36 feet; and South 69 degrees 44 minutes 58 seconds East for a distance of 125.14 feet to an iron pipe on the westerly line of that parcel of land described in Document Number 608580; thence South 03 degrees 22 minutes 33 seconds East for a distance of 354.73 feet along the westerly line of that parcel of land described in Document Number 608580 to an iron pipe on the westerly line of that parcel of land described in Document Number 661260; thence along the westerly and northerly lines of that parcel of land described in Document Number 661260, South 03 degrees 22 minutes 33 seconds East for a distance of 200.10 feet to an iron pipe; and South 88 degrees 26 minutes 34 seconds West for a distance of 108.00 feet to an iron pipe at the northeast corner of that parcel of land described in Document Number 655081, marked by an iron pipe; thence continuing South 88 degrees 26 minutes 34 seconds West for a distance of 230.18 feet along the north line of that parcel of land described in Document Number 655081 to the northwest corner thereof; thence continuing South 88 degrees 26 minutes 34 seconds West for a distance of 50.02 feet to the place of beginning.

The above described lateral lot lines extend to the southwesterly shore of Inkpot Lake; and includes all those lands lying between the meander line and the ordinary high water mark.

Together with and subject to covenants, easements, and restrictions of record.

Said property contains 5.92 acres, more or less.

PARCEL -C- REVISED (MAP NO. 14-84REV)

A parcel of land in the Northeast Quarter of the Northwest Quarter, Section 16, Township 39 North, Range 5 East, Town of Minocqua, Oneida County, Wisconsin, being parcel "C- Revised" shown on Map Number 14-84rev by Wilderness Surveying, Inc., dated January 7, 2015, more particularly described as follows:

Commencing at the Quarter Corner common to Sections 9 and 16, marked by a capped iron rebar; thence South 03 degrees 02 minutes 18 seconds East for a distance of 1318.21 feet along the east line of the Northeast Quarter of the Northwest Quarter to the southeast corner thereof, being the North Sixteenth Corner, marked by an iron pipe; thence South 88 degrees 28 minutes 24 seconds West for a distance of 1034.10 feet along the south line of the Northeast Quarter of the Northwest Quarter to the place of beginning, at the southwesterly corner of that parcel of land described in Document Number 661260, within the right of way of Schroeder Road;

Thence continuing South 88 degrees 28 minutes 24 seconds West for a distance of 285.12 feet along the south line of the Northeast Quarter of the Northwest Quarter to the southwest corner thereof, being the Northwest Sixteenth Corner, marked by an iron pipe; thence North 03 degrees 42 minutes 43 seconds West for a distance of 36.01 feet along the west line of the Northeast Quarter of the Northwest Quarter to an iron pipe on the northerly right of way line of Schroeder Road; thence continuing North 03 degrees 42 minutes 43 seconds West for a distance of 575.12 feet along the west line of the Northeast Quarter of the Northwest Quarter to an iron pipe; thence North 88 degrees 26 minutes 34 seconds East for a distance of 50.02 feet to an iron pipe on the southerly line of that parcel of land described in Volume 883 Records, page 819; thence continuing North 88 degrees 26 minutes 34 seconds East for a distance of 230.18 feet along the southerly line of that parcel of land described in Volume 883 Records, page 819 to an iron pipe at the northwesterly corner of that parcel of land described in Document Number 661260; thence South 04 degrees 10 minutes 20 seconds East for a distance of 575.31 feet along the westerly line of that parcel of land described in Document Number 661260 to an iron pipe on the northerly right of way line of Schroeder Road; thence continuing South 04 degrees 10 minutes 20 seconds East for a distance of 36.17 feet along the westerly line of that parcel of land described in Document Number 661260 to the place of beginning.

Subject to the rights of the public for that portion of the above described parcel located within the right of way of Schroeder Road.

Together with and subject to covenants, easements, and restrictions of record.

Said property contains 3.96 acres.

MI 1695-2

-A- Revised
±5.92 acres

MI 1786-2

Doc.

MI 1786-3

Plat of

p. 819



Doc.

Doc.

-C- Revised
3.96 acres
(3.73 acres excluding road r/w)

MI 1786-4

MI 1786-1

#608580

#661260

#655081

All improvements have not been shown.

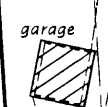

Schroeder

Road

Road

Northwest 1/16 Corner
(Northwoods Surveyors, Inc.)
1.9" dia. iron pipe previously found in place.

Squirrel Lake

MAP # 37750
DATE FILED 1-27-15
BY JB
DESCRIPTION FILED
ONEIDA CO. SURVEYOR'S OFFICE

Bearings Grid North,
Wisconsin Coordinate System
North Zone based on previous
solar observation by
Wilderness Surveying, Inc.

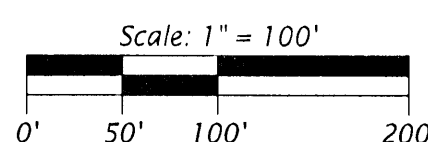

LEGEND

- = 2.5" dia. iron pipe found in place
- = 1.0" dia. iron pipe previously set by W.S.I.
- = iron pipe set at record location, 1.0" dia. x 24" long
- ⊖ = iron pipe set, 1.0" dia. x 24" long (1/7/2015 revision)
- △ = computed position, not monumented
- () = previously recorded bearing and distance
- ▣ = electric pedestal
- ⊠ = telephone pedestal

Monument sizes are outside diameter dimensions.
Other corner monuments are as noted.

NOTE:

See Map No. 98-26 by Wilderness Surveying, Inc., dated June 16th, 1998, and Map No. 01-212, by Wilderness Surveying, Inc., dated Dec. 5th, 2001, for previous survey data.

Center-north 1/16 Corner
(E.F. Kowalke)
2.1" dia. iron pipe previously found in place.

WILDERNESS SURVEYING, INC.
Post Office Box 1111 - 8793 Earls Court
Minocqua, Wisconsin 54548-1111
Telephone (715) 356-5100 - www.wildernesssurveying.com

Map Number: 14 - 84rev File Number: 3 - 16 - 395 Drafted by: C. Winkler	Revisions: 1/7/2015
---	---------------------

37750

37750