

Part of Lot 1 and All of Lots 2 and 8
of the Plat of Tower Ranch Heights

Located in
Gov't. Lot 5, Section 6
T 38 N, R 10 E
Town of Sugar Camp
Oneida County, Wisconsin

Scale: 1" = 40'

-Surveyor's Certificate-

"I HEREBY CERTIFY, THAT I HAVE SURVEYED AND MAPPED THE LANDS SHOWN HEREON AND THAT, TO THE BEST OF MY KNOWLEDGE AND BELIEF, THIS SURVEY AND MAP IS A TRUE AND CORRECT REPRESENTATION THEREOF, AND THAT I HAVE COMPLIED WITH THE APPLICABLE REQUIREMENTS OF CHAPTER A-E 7 OF THE WISCONSIN ADMINISTRATIVE CODE'S MINIMUM STANDARDS FOR PROPERTY SURVEYS."

DATED THIS 2nd DAY OF SEPTEMBER, 2016.

THOMAS A. BOETTCHER, P.L.S. 1763

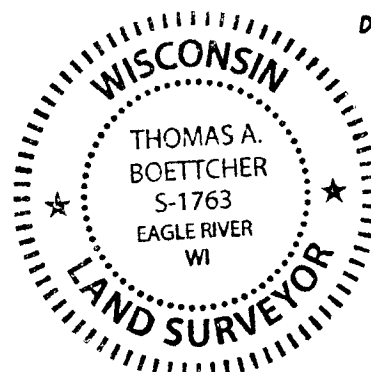

BEARINGS ARE BASED ON THE
EASTERLY LINE OF LOT 2 OF
TOWERING RANCH HEIGHTS, WITH
A RECORD TRUE BEARING OF
S 3°33'47"W.

NOTE: LEGAL DESCRIPTION IS
PROVIDED ON A SEPARATE SHEET.

Indian
Lake

-1-

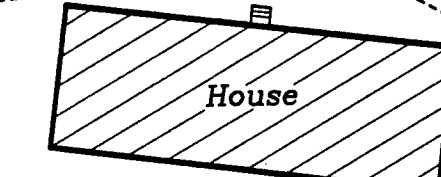

44,150± Sq. Ft.
1.01± Acres

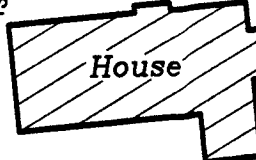

-2-

Indian Lake Road

Private Road

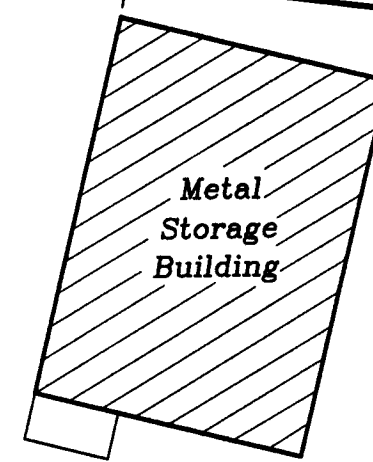

-8-
76,367 Sq. Ft.
1.75 Acres

-7-

-Legend-

- ⊙ 2" IRON PIPE FOUND IN PLACE
- 1" IRON PIPE FOUND IN PLACE
- () BEARING & DISTANCE OF RECORD

Survey For
Carolyn Siebens
ON801 Friendship Way, Unit 1100
Geneva, IL 60134

SCALE: 1" = 40' DATE: 9/2/2016 DWN. BY: TAB
Drawing No. **E4084** Eagle Landmark Surveying Inc.
5035 Hwy. 70 West, Eagle River, WI 54521
P&F (715) 479-9810 eaglelandmark@frontier.com