

MAP #	B8455	✓
DATE FILED:	6-19-2023	
BY:	CH	
DESCRIPTION FILED:		
ONEIDA CO. SURVEYOR'S OFFICE		

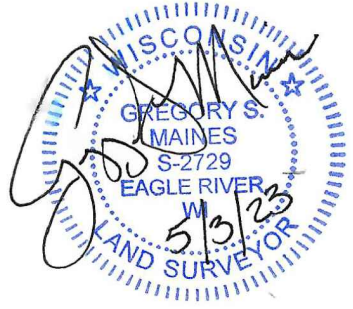

Surveyors Certificate

I hereby certify that I have surveyed the property shown hereon; that this map represents an accurate survey of said property to the best of my knowledge and belief; and that I have complied with the applicable requirements of the Wisconsin Administrative Code Section A-E 7.

Notes:

1. This survey was done without the benefit of a title commitment, there may or may not be easements of record that benefit or burden the subject property.
2. There was significant snow cover during the time of this survey, there may have been improvements that could not be seen and therefore are not shown.
3. Fieldwork was completed on March 22, 2023.

SHEET 1 OF 1

MAP #: 2023056
DRAWN BY: CJH
DATE: 05/03/2023

Lot 33 of Arbutus Heights Subdivision
Being a part of the
NW 1/4 of the NE 1/4
Section 7, T 39 N, R 7 E
Town of Woodruff
Oneida County, Wisconsin

PREPARED FOR:

Mary Pilcher



Arbor Vitae, WI 54568
Phone 715.356.9485

Eagle River, WI 54521
Phone 715.479.2570

www.mainesandassociates.com