

MAP # **B8466**

DATE FILED: **8-28-2023**

BY: **CH**

DESCRIPTION FILED: \_\_\_\_\_

ONEIDA CO. SURVEYOR'S OFFICE

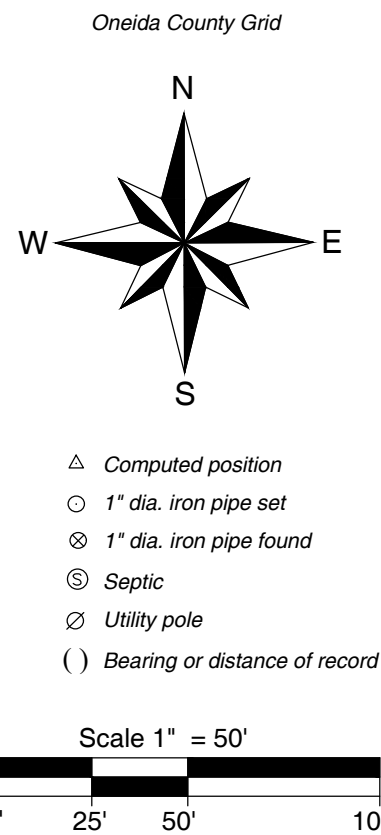

I hereby certify that I have surveyed the property shown hereon; that this map represents an accurate survey of said property to the best of my knowledge and belief; and that I have complied with the applicable requirements of the Wisconsin Administrative Code Section A-E 7.

**Part of**  
**NW 1/4 of the SE 1/4**  
**Section 32, T 37 N, R 7 E**  
**Town of Cassian**  
**Oneida County, Wisconsin**

PREPARED FOR:

Chris & Kathleen  
Lotspeich  
&  
Jakeoreo, LLC

**MAINES & ASSOCIATES**  
Land Surveyors

Arbor Vitae, WI 54568  
Phone 715.356.9485

Eagle River, WI 54521  
Phone 715.479.2570

www.mainesandassociates.com

MAP #: 2022009

DRAWN BY: LMV

DATE: 01/12/2022

SHEET 1 OF 1