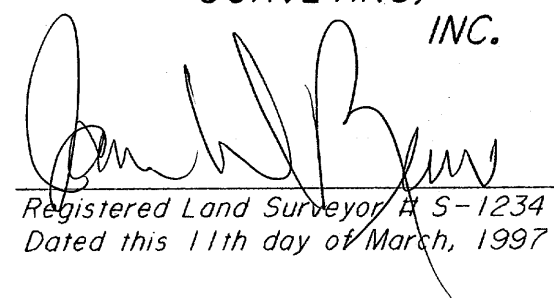

MAP # **C1370**
DATE FILED **JUN 18 1997**
BY **JB**
DESCRIPTION FILED
ONEIDA CO. SURVEYOR'S OFFICE

Part of the
SW 1/4 of the NW 1/4
SECTION 26, T37N, R8E
Newbold Township
Oneida County, Wisconsin

SURVEYOR'S CERTIFICATE
I, James D. Rein, Registered Land Surveyor No. S-1234, hereby certify that I have surveyed the property shown hereon; that this map represents an accurate survey of said property to the best of my knowledge and belief; that I have performed this survey by order of James Rappley; and that I have complied with the requirements of Wisconsin Administrative Code A-E 7.

WILDERNESS SURVEYING, INC.

Registered Land Surveyor A-S-1234
Dated this 11th day of March, 1997



RAPPLEY PARCEL

A parcel of land in the Southwest Quarter of the Northwest Quarter, Section 26, Township 37 North, Range 8 East, Newbold Township, Oneida County, Wisconsin, being the "RAPPLEY" parcel shown on Map No. 97-22 by Wilderness Surveying, Inc., dated March 11th, 1997, more particularly described as follows:

Commencing at the southwest corner of the Southwest Quarter of the Northwest Quarter, being the quarter corner common to Section 26 and Section 27, marked by a rail road spike in the pavement of Forest Lane; thence North 03 degrees 59 minutes 11 seconds East for a distance of 1388.53 feet to northwest corner of the Southwest Quarter of the Northwest Quarter, being the North Sixteenth Corner; thence North 86 degrees 46 minutes 10 seconds East for a distance of 33.27 feet along the north line of the Northwest Quarter of the Southwest Quarter to the place of beginning, marked by an iron pipe on the easterly right of way line of Forest Lane.

Thence continuing North 86 degrees 46 minutes 10 seconds East for a distance of 304.92 feet along the north line of the Southwest Quarter of the Northwest Quarter to an iron pipe; thence South 00 degrees 57 minutes 28 seconds West for a distance of 303.75 feet to an iron pipe; thence North 71 degrees 22 minutes 53 seconds West for a distance of 329.23 feet to an iron pipe on the easterly right of way line of Forest Lane; thence along said right of way line North 03 degrees 59 minutes 11 seconds East for a distance of 181.85 feet to the place of beginning.

Together with and subject to covenants, easements, and restrictions of record.

Said property contains 1.73 acres.

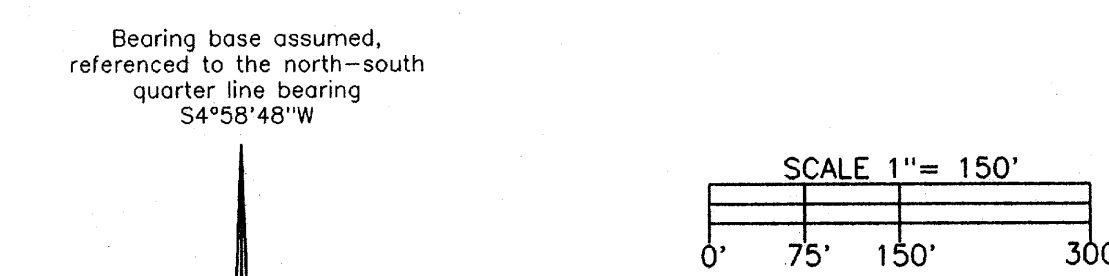

- LEGEND**
- = Corner position not monumented by this survey.
 - = Iron pipe set, 3/4" dia. x 24" long.
 - Other corner monuments are as noted.

WILDERNESS SURVEYING, INC.
Post Office Box 1111 - 8588 U.S. Highway 51
Minocqua, Wisconsin 54548-1111
Telephone (715) 356-5100

Map Number: 97-22
File Number: 5-26-378
Drafted by: M. Oestreich

Revisions: