

Based on West Line of NE 1/4 of Section 33

NORTH

MAG.

(Recorded As)

- (1) N 25° 53' 26" E 631.00'
 (2) S 80° 49' 00" E 170.19'
 (3) N 27° 24' 18" E 170.19'
 (4) N 01° 30' 35" W 77.90'
 (5) N 27° 22' 40" E 152.26'
 (6) N 89° 11' 52" E

SCALE: 1" = 30'

LEGEND

- = 1" x 48" Iron Pipe (set)
 □ = 1-3/4" Rebar (found)
 ○ = 1" Iron Pipe (found)
 ⊙ = 1-1/2" Iron Pipe (found)
 ⊕ = 1-3/4" Iron Pipe (found)
 ⊗ = 2" Iron Pipe (found)

Certified Survey Map Recorded in Volume 2 of maps Pages 551 & 551-A
 N 25° 43' 03" E 630.82'

RETREAT ROAD
 N 25° 43' 03" E

Contains 0.53 acres

224.59'

S 27° 15' 59" W

LOT "1" CSM Vol. 8, Page 2162

N 80° 57' 07" E 39.58'

108.47'

S 27° 52' 37" W 24.74'

S 00° 52' 20" E 2603.43'

N 1/4 Cor. 33

(6) N 88° 54' 09" E 72.05'

LOT #12 Dolhun Field Subdivision

Govt. Lot 4

Govt. Lot 3

LOT #13 Dolhun Field Subdivision

(4) S 00° 46' 37" E 77.49'

61.43'

16.00'

S 27° 13' 36" W 151.80'

33'

33'

ROW

S 26° 53' 03" W 170.20'

LOT #14 Dolhun Field Subdivision

ATTACHMENT PARCEL

Located in

Government Lots 3 & 4, Section 33

Township 39 North, Range 7 East

Town of Woodruff, Oneida Co. Wi.

Attachment Parcel Description

A parcel of land to be attached to lot # 1 of that Oneida county Certified Survey map recorded in Volume # 8 of maps, Shown on Page 2162, and described on page 2162-A. And recorded in Deeds, Volume 908, Page 626. Said parcel located in Government Lot's 3 & 4 of Section 33, Township 39 North, Range 7 East, Town of Woodruff, Oneida County Wisconsin; more particularly described as follows:

Commencing at the North One Quarter Corner of said Section 33, thence South 00 degrees 52 minutes 20 seconds East a distance of 2603.43 feet to a 2 inch iron pipe marking the center of said Section 33; thence North 88 degrees 54 minutes 09 seconds East a distance of 72.05 feet to a 1-3/4 inch iron pipe the point of beginning of said attachment parcel; thence South 27 degrees 13 minutes 36 seconds West a distance of 151.80 feet to a 1-1/2 inch iron pipe; thence South 00 degrees 46 minutes 37 seconds East a distance of 77.49 feet to a 2 inch iron pipe; thence South 26 degrees 53 minutes 03 seconds West a distance of 170.20 feet to a 2 inch iron pipe; thence South 27 degrees 15 minutes 59 seconds West a distance of 224.59 feet to a 2 inch iron pipe; thence South 27 degrees 52 minutes 37 seconds West a distance of 24.74 feet to a 1 inch X 48 inch iron pipe; thence North 25 degrees 43 minutes 03 seconds East a distance of 642.85 feet to a 1 inch X 48 inch iron pipe; thence North 88 degrees 54 minutes 09 seconds East a distance of 19.95 feet to a 1-3/4 inch iron pipe the point of beginning.

Said parcel containing 0.53 acres more or less.

CERTIFICATE

I Norbert L. Vissers R.L.S. 1821 certify that at the direction of Mr. Dennis Wanke I have surveyed, monumented, mapped and described the parcel shown hereon. That this survey was performed to facilitate the attachment of this parcel to a parcel lying adjacent to and currently owned by Mr. Wanke. I also certify that this map is an accurate representation of the area surveyed to the best of my knowledge and belief.

I make no warranty as to the current owner or owners of said parcel

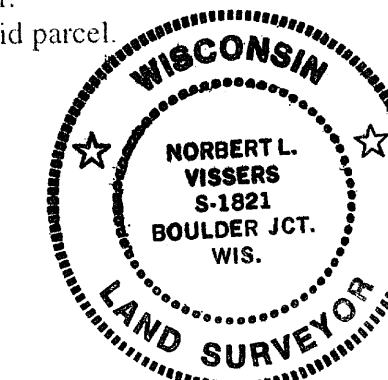

Norbert L. Vissers
 Norbert L. Vissers R.L.S. 1821

Dec. 3, 99
 December 3, 1999

MAP #	C 16 27
DATE FILED	DEC 17 1999
BY	MAK
DESCRIPTION FILED	
ONEIDA CO. SURVEYOR'S OFFICE	

Drawn by N.L. Vissers 12/03/99