

(S87° 58' 17"E)
S87° 45' 58"W
33.07'
(33.07)

(S87° 58' 17"E)
S87° 19' 12"E

(S38° 45')
S38° 66'

(S81° 50' 24"E)
S79° 11' 19"E

(232.3)
232.4'

(S33° 42')
S33° 42'

(S33° 42')
S33° 42'

(N76° 09' 09"W)
N76° 30' 04"W

(N76° 09' 09"W)
N76° 30' 04"W

(N76° 09' 09"W)
N76° 30' 04"W

(N76° 09' 09"W)
N76° 30' 04"W

(N76° 09' 09"W)
N76° 30' 04"W

(N76° 09' 09"W)
N76° 30' 04"W

(N76° 09' 09"W)
N76° 30' 04"W

(N76° 09' 09"W)
N76° 30' 04"W

(N76° 09' 09"W)
N76° 30' 04"W

(N76° 09' 09"W)
N76° 30' 04"W

(N76° 09' 09"W)
N76° 30' 04"W

(N76° 09' 09"W)
N76° 30' 04"W

(N76° 09' 09"W)
N76° 30' 04"W

(N76° 09' 09"W)
N76° 30' 04"W

(N76° 09' 09"W)
N76° 30' 04"W

(N76° 09' 09"W)
N76° 30' 04"W

(N76° 09' 09"W)
N76° 30' 04"W

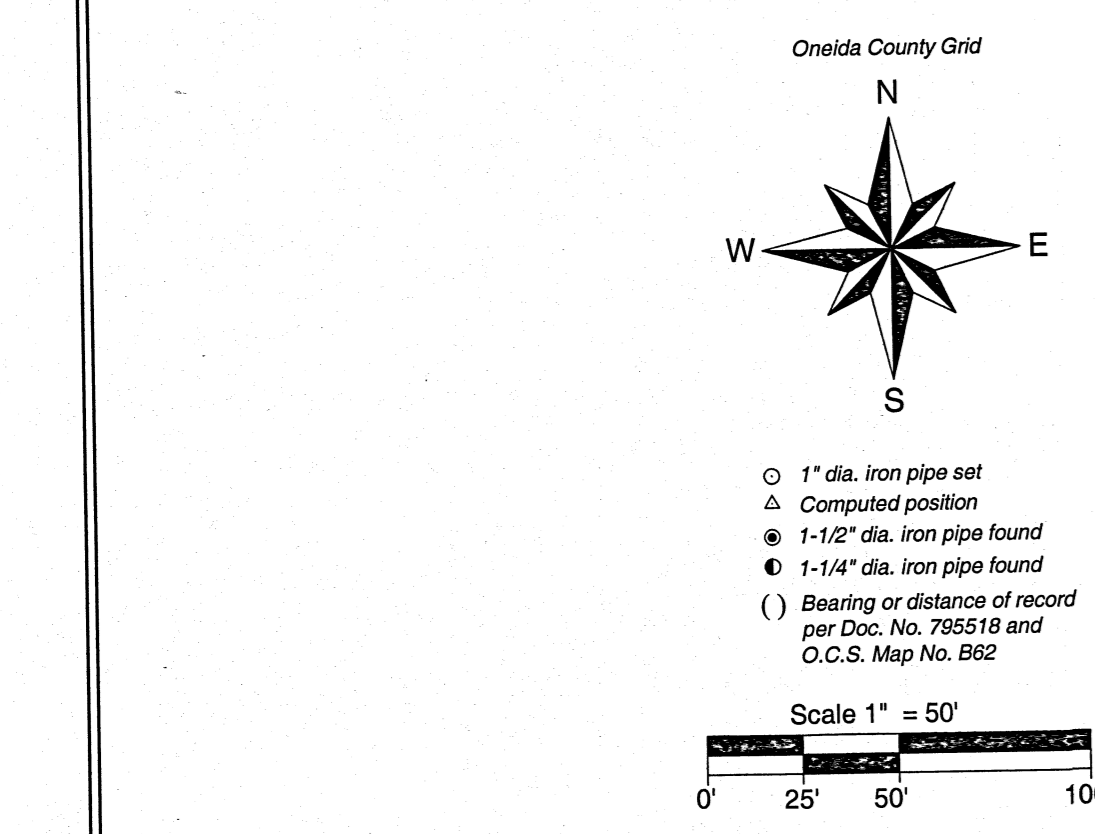

MAP # C3012 ✓
DATE FILED 6-17-2021
BY JAP
DESCRIPTION FILED
ONEIDA CO. SURVEYOR'S OFFICE

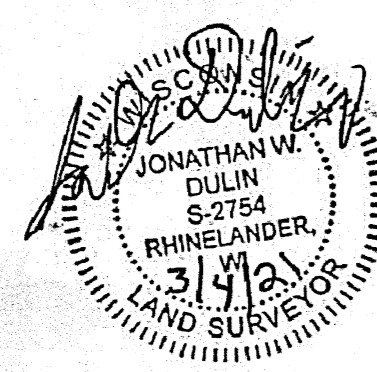

I hereby certify that I have surveyed the property shown hereon; that this map represents an accurate survey of said property to the best of my knowledge and belief; and that I have complied with the applicable requirements of the Wisconsin Administrative Code Section A.E.7.

Notes:

- This survey was done without the benefit of a title commitment, there may or may not be easements of record that benefit or burden the subject property.
- There was significant snow cover during the time of this survey, there may have been improvements that could not be seen and therefore are not shown.
- Fieldwork was completed December 31, 2021.

Legal Description

A parcel of land being part of the SW 1/4 of the SW 1/4 and the SE 1/4 of the SW 1/4 of Section 3, Township 37 North, Range 10 East, Town of Stella, Oneida County, Wisconsin, previously described in Document No. 795518, shown on Maines and Associates Map No. 2020362, dated March 4, 2021, and being more particularly described as follows:

Commencing at the South 1/4 Corner of said Section 3 marked by an Oneida County aluminum monument; thence N60°31'10"W for a distance of 1700.94 feet to an iron pipe, the PLACE OF BEGINNING. Thence N19°17'55"W for a distance of 301.97 feet to an iron pipe on the southerly right-of-way line of Spafford Road; thence along said southerly right-of-way line as follows: S76°30'04"E for a distance of 394.80 feet; thence S81°08'04"E for a distance of 160.00 feet to a point near the westerly bank of the Gudagast Creek; thence S72°16'00"W meandering along said westerly bank as follows: S31°33'27"E for a distance of 250.00 feet; thence S72°16'00"W for a distance of 125.00 feet; thence S58°33'22"W for a distance of 40.00 feet to an iron pipe; thence leaving said westerly bank, N77°10'55"W for a distance of 446.00 feet to the PLACE OF BEGINNING, the sidelines of the above-described parcel extend to the thread of the Gudagast Creek to include the lands lying between the meander line and said thread.

Together with and subject to any easements, restrictions, and reservations of record or of use.

O.C.S. Map No. B5641
O.C.S. Map No. B62

Spafford

Doc. No. 694713

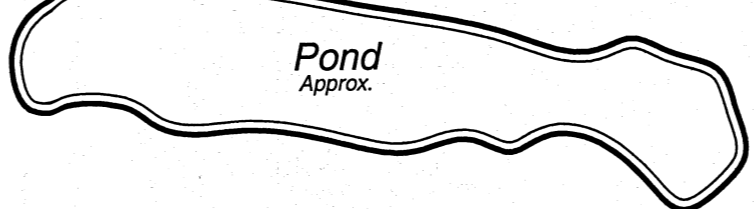

Drainage Ditch

Doc. No. 694713

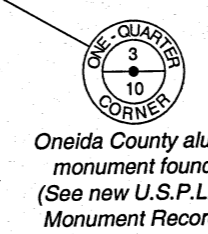

NE 1/4 - SW 1/4

NE 1/4 - SW 1/4
SE 1/4 - SW 1/4

SE 1/4 - SW 1/4

Doc. No. 795518

Parcel No. ST 37-6
Area is to the thread of
the Gudagast Creek
3.71 acres ±

Doc. No. 694713

Doc. No. 694713

PREPARED FOR:

Bryan Anderson

Part of the
SW 1/4 of the SW 1/4 and the
SE 1/4 of the SW 1/4
Section 3, T 37 N, R 10 E
Town of Stella
Oneida County, Wisconsin

REVISIONS:

#	BY	DATE

JOB #: 2020362

DRAWN BY: JWD

DATE: 03/04/2021

SHEET 1 OF 1



Ahor Vitaa, WI 54568
Phone 715.356.9485
Eagle River, WI 54521
Phone 715.479.2570
www.mainesandassociates.com