

BEARINGS REFERENCED TO THE
EAST R/W LINE OF STEVENS STREET
ASSUMED TO BEAR NORTH

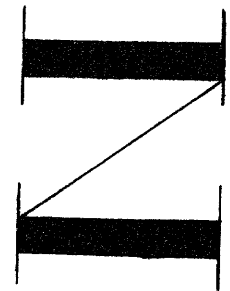
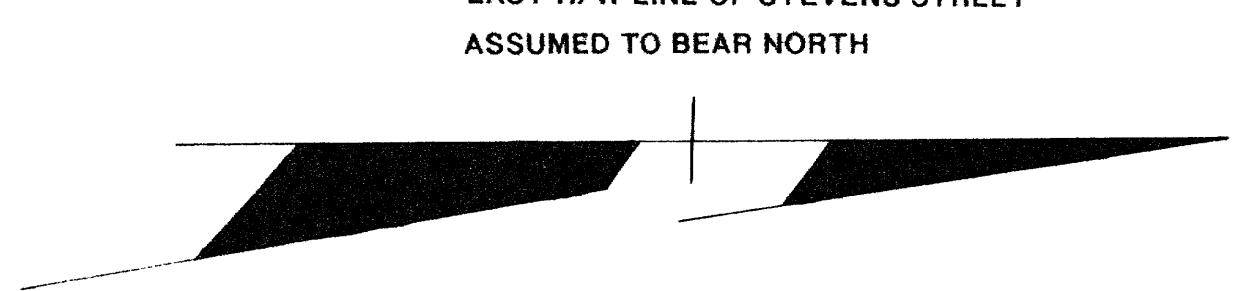

**LOTS 4, 5, 6, 9, & S 1/2 OF LOT 8, BLOCK B
S.H. ALBANS ADDITION TO THE CITY OF
RHINELANDER, ONEIDA COUNTY, WI**

RECEIVED & FILED #.....
Oneida County Surveyor's Office
Date: ... AUG - 27 - 1990
By: ... [Signature]
OCS Area #.....

C/L STEVENS STREET

NORTH

150.71'

60'

99.99'

LOT 1

LOT 2

LOT 3

LOT 4

LOT 5

LOT 6

EXISTING FENCE

N 89°-48'-15" E

120.11'

N 89°-46'-05" E

10.09'

S 00°-00'-15" E

100.61'

S 00°-00'-15" E

50.30'

20' EASEMENT

240.13'

120.03'

8

LOT 7

LOT 9

LOT

S 89°-54'-25" W

120.03'

S 00°-00'-30" E

100.76'

50.38'

20' WIDE EASEMENT

C/L PEARL STREET

60'

C/L PELHAM STREET

60'

LEGEND

- FOUND 1" IRON PIPE
- SET 1" X 24" IRON PIPE
- △ SET R/R SPIKE
- FOUND P K NAIL

I WILLIAM E. BANDOW HEREBY CERTIFY THAT I HAVE SURVEYED THE ABOVE PARCEL OF LAND UNDER THE DIRECTION OF MR. BILL BROWNE AND THAT THE ABOVE MAP IS A TRUE AND CORRECT REPRESENTATION OF THE LANDS SURVEYED TO THE BEST OF MY KNOWLEDGE AND BELIEF THAT I HAVE COMPLIED WITH THE PROVISIONS OF AE 7 OF THE WISCONSIN ADMINISTRATIVE CODE

William E. Bandow 8-1-90
WILLIAM E. BANDOW DATE



**GATEWAY CHEVROLET
BUICK, INC.
RHINELANDER, WI**

SCALE 1"=20' DATE 8/01/90 DWN BY: R.B.
DWG. NO. 9033 GENISOT AND ASSOCIATES, INC.
RHINELANDER, WIS.