

UNITED STATES
DEPARTMENT OF THE INTERIOR
~~GENERAL LAND OFFICE~~
BUREAU OF LAND MANAGEMENT
DUPLICATE

FIELD NOTES

OF THE

DEPENDENT RESURVEY

OF

SECTION BOUNDARIES

AND

SURVEY OF OMITTED LANDS,

SEC. 31,

T. 39 N., R. 11 E.,

Of the Fourth Principal Meridian,

In the State of Wisconsin

EXECUTED BY

Hugh B. Crawford, Cadastral Engineer

Under special instructions dated June 10, 1952, which provided
Supplemental special instructions July 30, 1952

for the surveys included under Group No. 92, bearing the approval of the

Commissioner of the General Land Office under date of

Supplemental assignment instructions July 30, 1952
and assignment instructions dated June 30, 1952

Survey commenced September 11, 1952

Survey completed October 29, 1952

RECEIVED & FILED	MAILED
U. S. LAND SURVEYOR'S OFFICE	1952
MAY 1 1952	
MAY 1 1952	

L1039

L1039

Dependent Resurvey of Sec. Boundaries and Survey of Lands
Omitted from the Original Survey in Sec. 31, T. 39 N.,
R. 11 E., 4th Prin. Mer., Wisconsin.

The west and south boundaries of T. 39 N., R. 11 E., were surveyed by H. C. Fellows, Deputy Surveyor, in 1859, and the township was subdivided by William E. Daugherty, Deputy Surveyor, in the same year; the official survey is represented on the township plat approved February 4, 1860. The east half of the township was resurveyed by Hugh B. Crawford, Cadastral Engineer, in 1941, as represented on the plat approved November 8, 1943.

The survey is initiated as an administrative measure as the result of correspondence with the Federal Power Commission regarding power development projects of the Wisconsin Valley Improvement Company and the showing on their maps of excess lands adjoining certain lakes within their projects.

Preliminary to the resurvey the lines of the original survey are retraced, and diligent search made for all corner posts, bearing trees and other calls of the original field note record. When duly identified the corner positions are remonumented and new bearing trees marked. Direct control is found for all lines of the resurvey. The true lines, thus adjusted to the identified original evidence, are then duly run and marked through the timber.

The original meander line of Planting Ground Lake is retraced, and the closing error adjusted. This line is established as a fixed boundary from the inlet to the lake to angle point No. 8, which covers the area surveyed as omitted land. The original meander line of Range Line Lake is retraced, and the closing error adjusted. This line is established as a fixed boundary from where it departs from the lake shore on the first course.

The survey to include the lands omitted from the original survey is made in accordance with the provisions of Chapter 3 of the Manual. Planting Ground Lake is accurately meandered in front of the public land area involved; Range Line Lake is accurately meandered in front of the public land area involved.









The survey is executed with a solar transit made by Buff and Buff, serial No. 17997, constructed in accordance with the standard specifications of the Bureau of Land Management. The horizontal circle has a diameter of 4½ inches, with two double opposite verniers reading to single minutes; the vertical circle has a diameter of 4 inches, with one double vernier reading to single minutes. The instrument is equipped with the improved Smith solar attachment, radius of latitude arc 3 inches, and of declination arc 3½ inches, each with verniers reading to single minutes. The instrument was in good condition and was placed in satisfactory adjustment prior to the beginning of the survey.

The directions of all lines herein reported are determined with the solar transit, and verified by a meridian established by an altitude observation of the sun. The measurements are made with a steel tape, 5 chains in length, graduated every link for the first 100 links and the remainder at intervals of 10 links. The tape is tested by comparison with a standard tape and found correct.

11039

Dependent Resurvey of Sec. Boundaries and Survey of Lands
Omitted from the Original Survey in Sec. 31, T. 39 N.,
R. 11 E., 4th Prin. Mer., Wisconsin.

September 11, 1952, at the witness meander cor. bet. secs. 6 and 31, Ts. 38 and 39 N., R. 11 E., on the west shore of Town Line Lake, in approximate latitude 45° 48' 30" N. and longitude 89° 10' 10" W., I make a series of three altitude observations of the sun, each with the telescope in direct and reversed position, observing opposite limbs of the sun, by sighting at a flag erected at the meander cor. of secs. 6 and 31, on the east shore of the lake, and reading the horizontal deflection angles south to the sun.

Observation	Telescope	Sun	Apparent time p.m.	Vertical angle	Horizontal angle
1st	Direct			31° 55' 00"	31° 48' 00"
1st	Reversed			32 19 00	32 06 00
	Mean			32° 07' 00"	31° 57' 00"
2nd	Reversed			31° 39' 00"	31° 16' 30"
2nd	Direct		3 ^h 0 ^m 0 ^s	31 54 00	31 32 00
	Mean			31° 46' 30"	31° 24' 15"
3rd	Direct			31° 16' 00"	30° 45' 30"
3rd	Reversed			31 41 00	31 07 00
	Mean		3 ^h 0 ^m 0 ^s	31° 28' 30"	30° 56' 15"

By 1st observation flag bears S. 89° 11' 55" E.
By 2nd observation flag bears S. 89° 12' 31" E.
By 3rd observation flag bears S. 89° 12' 29" E.
Mean true bearing of flag S. 89° 12' 18" E.

The declination of the sun for the mean of the three observations is 4° 19' 44" N.

Dependent Resurvey of the South Boundary of Sec. 31,
T. 39 N., R. 11 E., 4th Prin. Mer., Wisconsin.

Reestablishment of a Portion of the Survey Executed by
H. C. Fellows, Deputy Surveyor, in 1859.

The point for the cor. of secs. 5, 6, 31 and 32, Ts. 38 and 39 N., R. 11 E., is determined by measuring 14 ft. south and 33 ft. east from the SE. corner of a fence owned by the town of Three Lakes, Wisconsin; point falls in line with a fence north and near the intersection of improved roads bearing E., W. and S.

At the corner point

Set an iron post, 30 ins. long, 2¹/₂ ins. diam., 36 ins. in the ground, with brass cap mkd.

T 39 N R 11 E
S 31 S 32
S 6 S 5
T 38 N
1952

from which

A birch, 10 ins. diam., bears N. 63¹/₂° E., 128 lks. dist.,
mkd. T39N R11E S32 DT.

An oak, 8 ins. diam., bears S. 38¹/₂° W., 109¹/₂ lks. dist.,
mkd. T38N R11E S6 DT.

11039

3
Dependent Resurvey of the South Boundary of Sec. 31,
T. 39 N., R. 11 E.

Chains

A birch, 7 ins. diam., bears N. $77\frac{1}{2}^{\circ}$ W., 98 lks. dist.,
mkd. T39N R11E S31 BT.

An iron post, 30 ins. long, $2\frac{1}{2}$ ins. diam., set 26 ins. in the
ground, for a reference monument, with brass cap mkd. with an
arrow pointing to the cor. and T39N R11E S32 RM 1952, bears
N. 50° E., 65 lks. dist.

An iron post, 30 ins. long, $2\frac{1}{2}$ ins. diam., set 24 ins. in the
ground, for a reference monument, with brass cap mkd. with an
arrow pointing to the cor. and T38N R11E S6 RM 1952, bears
S. 50° W., 65 lks. dist.

S. $89^{\circ} 49'$ W., bet. secs. 6 and 31, marking and blazing the true
line.

Over gently rolling land, along an improved road, with timber and
undergrowth north and south.

5.20 Road, curves SW.; enter timber and undergrowth.

10.34 Main house of Sunset Bay Resort, bears South, 25 lks. dist.

13.40 Cabin on line.

13.90 Enter swamp, bears N. and SW.

19.90 Leave swamp, bears N. and SE.

21.80 Road, bears NW. and SE.; thence along south side of clearing.

27.28 The point for the meander cor. of secs. 6 and 31, on east shore of
Town Line Lake, is marked with an iron well pipe, $1\frac{1}{2}$ ins. diam.,
protruding 16 ins. above the ground. This point is said to be
the preserved original meander cor. point.

At the corner point

Set an iron post, 30 ins. long, $2\frac{1}{2}$ ins. diam., 26 ins. in the
ground, with brass cap mkd.

	T 39 N	
	S 31	
M C	<hr/>	R11E
	S 6	
	T 38 N	
	1952	

from which

A white pine, 6 ins. diam., bears N. $71\frac{1}{2}^{\circ}$ E., 14 lks. dist.,
mkd. T39N R11E S31 MC BT.

A Norway pine, 10 ins. diam., bears S. $22\frac{1}{2}^{\circ}$ E., 35 $\frac{1}{2}$ lks. dist.,
mkd. T38N R11E S6 MC BT.

N. $89^{\circ} 12'$ W., beginning new measurement.

In order to determine the distance over Town Line Lake, I leave a
flag at this meander cor. and proceed to the point for the witness
meander cor., on the west shore, where I lay a base S. $6^{\circ} 12'$ W.,
6.032 chs. dist.; from end of base flag on east shore, bears
N. $81^{\circ} 54'$ E.

L1039

Dependent Resurvey of the South Boundary of Sec. 31,
T. 39 N., R. 11 E.

Chains

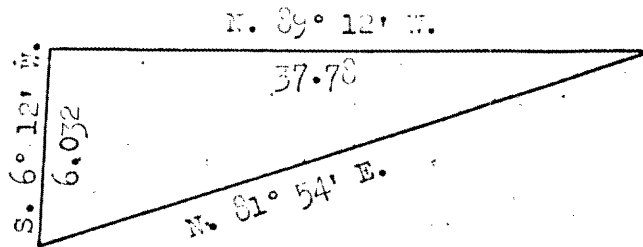

Distance over lake = 37.78 chs.

37.42

The point for the meander cor. of secs. 6 and 31, on west shore of Town Line Lake, falls in edge of lake. Point determined at record distance east of the Township corner; the adjoining land owner states that several feet of the bank has washed away due to the raising of the water level of the lake. Impracticable to establish a monument.

37.78

Point selected for the witness meander cor. of secs. 6 and 31, on west shore of Town Line Lake.

Set an iron post, 30 ins. long, 2½ ins. diam., 27 ins. in the ground, with brass cap mkd.

W C
T 39 N
S 31
R11E ——— M C
S 6
T 38 N
1952

from which

An oak, 4 ins. diam., bears N. E., 32 lks. dist.,
mkd. X BT.

A white pine, 9 ins. diam., bears S. 34½° W., 16½ lks. dist.,
mkd. X BT.

N. 87° 56' W., beginning new measurement.

Over rolling land, through resort yard.

0.97

Leave yard, enter improved road, curving N. from W.

21.46

The point for the cor. of Ts. 38 and 39 N., Rs. 10 and 11 E. is determined from an original bearing tree.

from which

An original bearing tree:

A white pine, 12 ins. diam., bears N. 84° E., 30 lks. dist., with old upper and lower blazes chopped out, fragments of scribe marks visible. Point falls near intersection of roads bearing E., W. and S.

At the corner point

Set an iron post, 30 ins. long, 2½ ins. diam., 36 ins. in the ground, with brass cap mkd.

11039

5
Dependent Resurvey of the South Boundary of Sec. 31,
T. 39 N., R. 11 E.

Chains

T 39 N
R 10 E | R 11 E
S 36 | S 31

S 1 | S 6
T 38 N
1952

from which

A Norway pine, 20 ins. diam., bears N. $32\frac{1}{2}^{\circ}$ E., 41 lks. dist., mkd. BT; these marks are approximately 1 year old, and I did not add to them as the tree is in a resort yard.

A maple 16 ins. diam., bears S. 19° E., 135 lks. dist., mkd. T38N R11E S6 BT.

A Norway pine, 8 ins. diam., bears S. 87° W., 134 $\frac{1}{2}$ lks. dist., mkd. T38N R10E S1 BT.

A white pine, 4 ins. diam., bears N. $23\frac{1}{2}^{\circ}$ W., 107 lks. dist., mkd. BT.

An iron post, 30 ins. long, 2 $\frac{1}{2}$ ins. diam., set 29 ins. in the ground, for a reference monument, with brass cap mkd. with an arrow pointing to the cor. and T39N R11E S31 RM 1952, bears N. 45° E., 50 lks. dist.

An iron post, 30 ins. long, 2 $\frac{1}{2}$ ins. diam., set 24 ins. in the ground, for a reference monument, with brass cap mkd. with an arrow pointing to the cor. and T38N R10E S1 RM 1952, bears S. 45° W., 50 lks. dist.

Land, gently rolling and rolling.

Soil, sandy loam.

Timber, poplar, birch, maple, oak, ash, balsam and pine; undergrowth, young timber.

Dependent Resurvey of the West Boundary of Sec. 31,
T. 39 N., R. 11 E., 4th Prin. Mer., Wisconsin.

Reestablishment of a Portion of the Survey Executed by
H. C. Fellows, Deputy Surveyor, in 1859.

From the cor. of Ts. 38 and 39 N., Rs. 10 and 11 E.

N. $3^{\circ} 27'$ W., bet. Rs. 10 and 11 E., bet. secs. 31 and 36, marking and blazing the true line.

Over rolling land, through timber and undergrowth.

6.43

The point for the meander cor. of secs. 31 and 36, on south shore of Range Line Lake, is located at a short distance north and immediately west of a row of pine and cedar trees, which were set east of line several years ago; point falls on the shore of Range Line Lake.

At the corner point

Set an iron post, 30 ins. long, 2 $\frac{1}{2}$ ins. diam., 26 ins. in the ground, with brass cap mkd.

M C
S 36 | S 31
R 10 E | R 11 E
T 39 N
1952

11039

Dependent Recurvey of the West Boundary of Sec. 31,
T. 39 N., R. 11 E.

Chains

from which

A white pine, 16 ins. diam., bears S. $36\frac{1}{2}^{\circ}$ E., 22 lks. dist.,
not marked.

A Norway pine, 14 ins. diam., bears S. 75° W., 68 lks. dist.,
not marked.

These trees are in lake front property owners yards and I did
not scar them.

N. $1^{\circ} 16'$ E., beginning new measurement.

In order to determine the distance over Range Line Lake, I reduce
the latitudes and departures of the adjusted meander traverse and
check with the actual meanders.

49.94 The point for the meander cor. of secs. 31 and 36, on the north
shore of Range Line Lake, is determined on the lake shore and
in the same relation to a fence line projected north as the cor.
of secs. 25, 30, 31 and 36, which is 3 lks. dist. west of the
north and south fence line.

At the corner point

Set an iron post, 30 ins. long, $2\frac{1}{2}$ ins. diam., 25 ins. in the
ground, with brass cap mkd.

T 39 N
R 10 E | R 11 E
S 36 | S 31

M C
1952

from which

A maple, 4 ins. diam., bears N. 88° E., $16\frac{1}{2}$ lks. dist.,
mkd. T39N R11E S31 MC BT.

A white pine, 12 ins. diam., bears N. $4\frac{1}{2}^{\circ}$ W., 71 lks. dist.,
mkd. T39N R11E S36 MC BT.

N. $1^{\circ} 23'$ W., beginning new measurement.

Over point of land.

0.97 Right bank of outlet creek from Range Line Lake, 40 lks. wide,
course N. 60° E.

1.37 Left bank of creek: thence over rolling land through timber and
undergrowth.

4.30 Improved road, bears N. $76\frac{1}{2}^{\circ}$ W. and S. $83\frac{1}{2}^{\circ}$ E.

4.65 SE. corner of a fence, bears East, 3 lks. dist.; thence line
follows near fence.

16.30 Thence along east edge of a field.

18.50 NE. corner of field.

23.62 The point for the cor. of secs. 25, 30, 31 and 36 is marked with
an iron pipe, 3 ins. diam., protruding 6 ins. above the ground.

7
Dependent Resurvey of the West Boundary of Sec. 31,
T. 39 N., R. 11 E.

Chains

At the corner point

Set an iron post, 30 ins. long, 2½ ins. diam., 24 ins. in the ground, with brass cap mkd.

T 39 N	
R 10 E	R 11 E
S 25	S 30
<hr/>	
S 36	S 31
1952	

from which

A birch, 5 ins. diam., bears N. 37½° E., 46 lks. dist.,
mkd. T39N R11E S30 BT.

An oak, 8 ins. diam., bears S. 22° E., 53 lks. dist.,
mkd. T39N R11E S31 BT.

An oak, 5 ins. diam., bears S. 50° W., 20 lks. dist.,
mkd. T39N R10E S36 BT.

A birch, 8 ins. diam., bears N. 37° W., 36 lks. dist.,
mkd. T39N R10E S25 BT.

Land, rolling.

Soil, sandy loam.

Timber, poplar, birch, oak and pine; undergrowth, young timber and hazel.

Dependent Resurvey of the East and North Boundaries of
Sec. 31, T. 39 N., R. 11 E., 4th Prin. Mer., Wisconsin.

Reestablishment of a Portion of the Survey Executed by
William E. Daugherty, Deputy Surveyor, in 1859.

From the cor. of secs. 5, 6, 31 and 32, on the south boundary of
the township.

N. 2° 13' W., bet. secs. 31 and 32.

Over nearly level land, along a fence line, with timber and under-
growth west and field east.

- | | |
|-------|--|
| 19.73 | An iron pipe, 2 ins. diam., protruding 8 ins. above the ground,
set by the NE. corner of a fence, bears East, 13 lks. dist.;
thence over cleared land. |
| 24.90 | Partly improved road, bears N. 82½° W. and S. 82½° E. |
| 29.80 | Partly improved road, bears N. 21° W. and S. 21° E.; enter timber
and undergrowth. |
| 33.48 | House, bears East, 18 lks. dist.; on shore of Planting Ground Lake. |
| 34.30 | Shore of Planting Ground Lake, bears NW. and SE. |
| 38.45 | Leave Planting Ground Lake, bears NE. and SW. |
| 39.22 | The point for the ¼ sec. cor. of secs. 31 and 32 is marked with an
iron well pipe, 2 ins. diam., protruding 8 ins. above the ground. |
| | At the corner point |

11039

Dependent Resurvey of the East and North Boundaries of
Sec. 31, T. 39 N., R. 11 E.

Chains

Set an iron post, 30 ins. long, 2½ ins. diam., 26 ins. in the ground, with brass cap mkd.

S 31 S 32

1952

from which

A white pine, 9 ins. diam., bears N. 14° E., 19 lks. dist., mkd. ½ S32 BT.

A white pine, 9 ins. diam., bears N. 70° W., 28 lks. dist., mkd. ½ S31 BT.

Rreset the well pipe east and alongside the post.

Continue bearing and distance.

40.41

Point selected for the witness meander cor. of secs. 31 and 32, on shore of Planting Ground Lake.

Set an iron post, 30 ins. long, 2½ ins. diam., 22 ins. in the ground, with brass cap mkd.

W C
M C
S 31 S 32
T 39 N R 11 E
1952

from which

A Norway pine, 9 ins. diam., bears S. 15½° E., 30 lks. dist., mkd. X BT.

A white pine, 12 ins. diam., bears S. 48° W., 1 lks. dist., mkd. X BT.

40.52

Point for the meander cor. of secs. 31 and 32, at record distance from the ¼ sec. cor., falls in edge of lake; impracticable to establish a monument.

Land, nearly level and rolling.

Soil, sandy loam.

Timber, poplar, birch, oak and pine; undergrowth, young timber.

From the cor. of secs. 25, 30, 31 and 36, on W. bdy. of Tp.

S. 89° 14' E., bet. secs. 30 and 31.

Over rolling land, through timber and undergrowth, along an old fence line.

2.70

End of old fence, at foot of hill; thence over gently rolling land.

3.46

Improved road, bears N. 11° E. and S. 2° W.

7.30

South end of an alder swamp.

12.40

Point selected for a witness point, on shore of flowage area.

Set an iron post, 30 ins. long, 2½ ins. diam., 26 ins. in the ground, with brass cap mkd.

9
Dependent Resurvey of the East and North Boundaries of
Sec. 31, T. 39 N., R. 11 E.

Chains

W P
S 30
S 31
1952

from which

A tamarack, 6 ins. diam., bears N. 44° E., 34½ lks. dist.,
mkd. WP S30 BT.

A tamarack, 5 ins. diam., bears S. 25° W., 36 lks. dist.,
mkd. WP S31 BT.

Thence over flowage area.

12.58 An iron pipe, 3 ins. diam., protruding 6 ins. above the ground;
this pipe is used for alinement.

29.47 Point for the meander cor. of secs. 30 and 31, at record distance,
falls near the normal shore of Planting Ground Lake and near mouth
of the inlet from Range Line Lake.

Land, rolling and gently rolling.

Soil, sandy loam and muck.

Timber, poplar, birch, oak, maple and pine; undergrowth, young
timber, alder and hazel.

Survey of Lands Omitted from the Original Survey
in Sec. 31, T. 39 N., R. 11 E., 4th Prin. Mer.,
Wisconsin.

Retracement of the Meander Line of Planting Ground Lake
through Sec. 31 as Recorded by William E. Daugherty,
Deputy Surveyor, in 1859; and Reestablishment of the
Portion of this Line effecting the Public Land.

Beginning at the true point for the meander cor. of secs. 31 and
32, T. 39 N., R. 11 E., on SW. shore of Planting Ground Lake.

Thence with the adjusted meanders in sec. 31.

Over rolling land, through timber and undergrowth, and cabin sites.

N. 38° 36' W., 3.96 chs.

3.96 Adjusted position for angle point No. 1, not monumented.

N. 67° 31' W., 17.49 chs.

2.00 Shore of Planting Ground Lake; thence over lake, near the south
shore.

1.00 Point on west bank of inlet from Range Line Lake, where omitted area
begins; point falls in flowage, impracticable to establish a
monument. Thence over flowage.

10.87 Point selected for the witness auxiliary meander corner, on west
edge of flowage.

Set an iron post, 30 ins. long, 2½ ins. diam., 24 ins. in the
ground, with brass cap mkd.

63079

Survey of Lands Omitted from the Original Survey
in Sec. 31, T. 39 N., R. 11 E.

Chains

W C
A M C
T 39 N R 11 E
S 31
1952

from which

A birch, 9 ins. diam., bears N. $50\frac{1}{2}^{\circ}$ E., 53 lks. dist.,
mkd. X BT.

An oak, 12 ins. diam., bears N. $52\frac{1}{2}^{\circ}$ W., 41 lks. dist.,
mkd. X BT.

Thence over rolling land, through timber and undergrowth.

15.86 New road, bears N. $21\frac{1}{2}^{\circ}$ E. and S. $21\frac{1}{2}^{\circ}$ W., a short distance to end.

17.49 Adjusted position for angle point No. 2.

Set an iron post, 30 ins. long, $2\frac{1}{2}$ ins. diam., 24 ins. in the
ground, with brass cap mkd.

A P
2
T 39 N
R 11 E
S 31
1952

from which

An oak, 5 ins. diam., bears N. $70\frac{1}{2}^{\circ}$ E., $28\frac{1}{2}$ lks. dist.,
mkd. AP2 S31 BT.

A maple, 4 ins. diam., bears S. 38° E., $3\frac{1}{2}$ lks. dist.,
mkd. AP2 S31 BT.

N. $87^{\circ} 05'$ W., 3.38 chs.

3.38 Adjusted position for angle point No. 3.

Set an iron post, 30 ins. long, $2\frac{1}{2}$ ins. diam., 24 ins. in the
ground, with brass cap mkd.

A P
3
T 39 N R 11 E
S 31
1952

An oak, 4 ins. diam., bears N. $22\frac{1}{2}^{\circ}$ W., $38\frac{1}{2}$ lks. dist.,
mkd. AP3 S31 BT.

A maple, 6 ins. diam., bears S. 42° E., $20\frac{1}{2}$ lks. dist.,
mkd. AP3 S31 BT.

S. $74^{\circ} 12'$ W., 3.85 chs.

3.85 Adjusted position for angle point No. 4.

Set an iron post, 30 ins. long, $2\frac{1}{2}$ ins. diam., 25 ins. in the
ground, with brass cap mkd.

Survey of Lands Omitted from the Original Survey
in Sec. 31, T. 39 N., R. 11 E.

Chains

A P

4

T 39 N

R 11 E

S 31

1952

from which

A Norway pine, 24 ins. diam., bears N. 9° E., 32 lks. dist.,
mkd. AP4 S31 BT.

A Norway pine, 22 ins. diam., bears S. 62° E., $46\frac{1}{2}$ lks. dist.,
mkd. AP4 S31 BT.

S. $50^{\circ} 16'$ W., 12.03 chs.

12.03

Adjusted position for angle point No. 5.

Set an iron post, 30 ins. long, $2\frac{1}{2}$ ins. diam., 25 ins. in the
ground, with brass cap mkd.

A P

5

T 39 N R 11 E

S 31

1952

from which

A birch, 4 ins. diam., bears N. 84° E., 9 lks. dist.,
mkd. AP5 S31 BT.

A maple, 4 ins. diam., bears N. $38\frac{1}{2}^{\circ}$ W., 37 lks. dist.,
mkd. AP5 S31 BT.

N. $89^{\circ} 10'$ W., 2.89 chs.

2.89

Adjusted position for angle point No. 6.

Set an iron post, 30 ins. long, $2\frac{1}{2}$ ins. diam., 24 ins. in the
ground, with brass cap mkd.

A P

6

T 39 N R 11 E

S 31

1952

from which

A birch, 9 ins. diam., bears N. $38\frac{1}{2}^{\circ}$ E., $20\frac{1}{2}$ lks. dist.,
mkd. AP6 S31 BT.

A Norway pine, 12 ins. diam., bears S. $82\frac{1}{2}^{\circ}$ W., 67 lks. dist.,
mkd. AP6 S31 BT.

A wooden post, 4 ins. sq., protruding 36 ins. above the ground,
bears S. $46^{\circ} 05'$ W., 1.57 chs. dist.; this is the local center
 $\frac{1}{4}$ sec. cor. of sec. 31.

Survey of Lands Omitted from the Original Survey
in Sec. 31, T. 39 N., R. 11 E.

Chains

N. 15° 45' W., 6.02 chs.

0.55 Partly improved road, bears N. 18° E. and S. 6° W.

6.02 Adjusted position for angle point No. 7.

Set an iron post, 30 ins. long, 2½ ins. diam., 24 ins. in the ground, with brass cap mkd.

T 39 N
R 11 E
S 31
A P
7
1952

from which

A maple 4 ins. diam., bears N. 40° E., 35½ lks. dist.,
mkd. AP7 S31 BT.

A maple, 4 ins. diam., bears N. 39½° W., 34 lks. dist.,
mkd. AP7 S31 BT.

N. 2° 52' W., 11.63 chs.

4.94 An iron pipe, 2 ins. diam., protruding 2 ins. above the ground,
bears East, 32.7 lks. dist.; this pipe marks the cor. of a local
tract, along the N. - S. center line of the sec.

5.10 Leave rolling land, enter swamp, bears N. 60° E. and S. 60° W.

11.63 Adjusted position for angle point No. 8.

Set an iron post, 30 ins. long, 2½ ins. diam., 26 ins. in the ground, with brass cap mkd.

T 39 N
R 11 E
S 31
A P
8
1952

from which

A spruce, 3 ins. diam., bears S. 61½° E., 21 lks. dist.,
mkd. AP8 S31 BT.

A spruce, 5 ins. diam., bears S. 48½° W., 26½ lks. dist.,
mkd. AP8 S31 BT.

A wooden post, set in center of a cluster of stakes, bears
N. 18° 56' E., 1.25 chs. dist.; this post marks the posi-
tion of the local CN 1/16 sec. cor. of sec. 31 and is mkd.
1/8 S.

The omitted land survey ends at angle point No. 8; however the re-
tracement is continued to complete the record bet. meander cors.

N. 59° 15' W., 2.92 chs.

0.30 Enter a pond, bears NE. and SW.

1.60 Leave pond.

2.92 Adjusted position for angle point No. 9, not monumented.

Survey of Lands Omitted from the Original Survey
in Sec. 31, T. 39 N., R. 11 E.

Chains

- S. $86^{\circ} 40'$ W., 3.86 chs.
- 2.50 Leave swamp, bears N. and S.
- 3.86 Adjusted position for angle point No. 10, not monumented.
N. $48^{\circ} 01'$ W., 7.36 chs.
- 0.93 Power line, bears N. $86\frac{1}{2}^{\circ}$ E. and S. $86\frac{1}{2}^{\circ}$ W.
- 7.36 Adjusted position for angle point No. 11, not monumented.
N. $12^{\circ} 12'$ W., 15.87 chs.
- 1.36 Partly improved road, bears E. and W.; enter chicken yard north of road.
- 5.90 Private road, bears E. and W.; leave chicken yard south of road.
- 6.00 House, bears East, 1.50 chs. dist.
- 7.75 Fence line, bears N. 60° E. and S. 60° W.
- 11.35 Enter flowage area, bears E. and W.
- 15.87 The point for the meander cor. of secs. 30 and 31.

Land, Rolling.

Soil, sandy loam.

Timber, poplar, birch, oak, maple, pine and spruce; undergrowth, young timber, hazel brush and alder.

Reestablishment of the Meander Line of Range Line Lake
through Sec. 31 as Recorded by William E. Daugherty,
Deputy Surveyor, in 1859.

Beginning at the meander cor. of secs. 31 and 36, on the W. bdy. of the Tp. and south side of Range Line Lake.

Thence with the adjusted meanders in sec. 31.

Over level land, along the shore of Range Line Lake, through timber and undergrowth.

N. $85^{\circ} 15'$ E., 17.74 chs.

- 2.10 Point for an auxiliary meander cor., at intersection of the lake shore with the adjusted meander line.

Set an iron post, 30 ins. long, $2\frac{1}{2}$ ins. diam., 29 ins. in the ground, with brass cap mkd.

A M C

T 39 N R 11 E

S 31

1952

from which

A white pine, 16 ins. diam., bears S. $40\frac{1}{2}^{\circ}$ E., 49 lks. dist., not mkd.

A white pine, 20 ins. diam., bears S. 40° W., $27\frac{1}{2}$ lks. dist., not mkd.

These trees stand on well kept lake front property and I did not saw them.

680114

Survey of Lands Omitted From the Original Survey
in Sec. 31, T. 39 N., R. 11 E.

Chains

Thence with the survey of the omitted land fronting on Range Line Lake; over rolling land.

8.15 A housekeeping cottage, left 27 lks. dist.

17.74 Adjusted position for angle point No. 12.

Set an iron post, 30 ins. long, $2\frac{1}{2}$ ins. diam., 21 ins. in the ground, with brass cap mkd.

A P
12

T 39 N R 11 E
S 31
1952

from which

A Norway pine, 14 ins. diam., bears N. 1° E., $28\frac{1}{2}$ lks. dist., mkd. AP12 S31 BT.

A white pine, 13 ins. diam., bears S. 27° E., 38 lks. dist., mkd. AP12 S31 BT.

N. $49^{\circ} 51'$ E., 4.59 chs.; over gently rolling land.

4.59 Adjusted position for angle point No. 13.

Set an iron post, 30 ins. long, $2\frac{1}{2}$ ins. diam., 25 ins. in the ground, with brass cap mkd.

A P
13

T 39 N
R 11 E
S 31

1952

from which

A white pine, 12 ins. diam., bears N. $11\frac{1}{2}^{\circ}$ E., 46 lks. dist., mkd. AP13 S31 BT.

A white pine, 8 ins. diam., bears N. 38° W., 25 lks. dist., mkd. AP13 S31 BT.

N. $3^{\circ} 15'$ W., 35.97 chs.

3.85 East end of a swamp.

4.35 Unimproved road; bears NW. and SE.

5.00 Enter swamp, bears NW. and SE.

16.30 Leave swamp, enter rolling land, bears NW. and SE.

29.35 Fence line, bears E. and W.; leave timber and undergrowth, enter clearing.

35.97 Adjusted position for angle point No. 14.

Set an iron post, 30 ins. long, $2\frac{1}{2}$ ins. diam., 26 ins. in the ground, with brass cap mkd.

A P
14

T 39 N
R 11 E
S 31

1952

15
Survey of Lands Omitted From the Original Survey
in Sec. 31, T. 39 N., R. 11 E.

Chains

from which

The farthest north post of a baseball backstop, bears
S. $87\frac{1}{2}^{\circ}$ W., 314 lks. dist.

raise a mound of stone, $2\frac{1}{2}$ ft. base, $1\frac{1}{2}$ ft. high, N. of cor.
N. $51^{\circ} 56'$ W., 8.29 chs.

3.75 Unimproved road, bears NE. and SW.

8.23 Adjusted position for angle point No. 15.

Set an iron post, 30 ins. long, $2\frac{1}{2}$ ins. diam., 24 ins. in the
ground, with brass cap mkd.

T 39 N R 11 E
S 31

A P
15

1952

from which

A pine stump, 12 ins. diam., bears N. $34\frac{1}{2}^{\circ}$ W., 46 lks. dist.,
mkd. BS.

A pine stump, 14 ins. diam., bears S. 37° W., 48 lks. dist.,
mkd. BS.

N. $68^{\circ} 48'$ W., 12.36 chs.

4.80 Private drive to cottages, bears N. 30° E. and S. 30° W.; thence
through yard of Evangelic Lutheran Synod resort.

12.36 The meander cor. of secs. 31 and 36, on north shore of Range Line
Lake.

Land, rolling, gently rolling and level.

Soil, sandy loam.

Timber, poplar, birch, pine, oak, maple, spruce and tamarack;
undergrowth, young timber, hazel brush and alder.

Line to Mark the West Boundary of the Public Land Survey
from Angle Point No. 8 to Planting Ground Lake.

From Angle Point No. 8 of the adjusted meanders of sec. 31.

N. $0^{\circ} 46'$ W., 6.99 chs.

Over level swamp land, through timber and undergrowth.

4.99 Leave swamp, enter rolling land, bears NW. and SE.

2.92 Partly improved road, bears N. $14\frac{1}{2}^{\circ}$ W. and S. $49\frac{1}{2}^{\circ}$ E.

3.99 Garage on line.

6.09 Enter east end of a swamp.

6.99 An iron pipe, $1\frac{1}{2}$ ins. diam., protruding 3 ins. above the ground;
this pipe is set on the south shore of Planting Ground Lake and
was pointed out to me by Mr. Ray Giles as being the NW. corner of
his lot. However the record does not bear this out, which was
found after establishing this corner.

68039

Survey of Lands Omitted from the Original Survey
in Sec. 31, T. 39 N., R. 11 E.

Chains

At the corner point

Set an iron post, 30 ins. long, 2½ ins. diam., 26 ins. in the ground, with brass cap mkd.

A M C
T 39 N R 11 E
S 31
1952

from which

17.16'
A Norway pine, 8 ins. diam., bears S. 5° E., 26 lks. dist.,
mkd. S31 AMC BT.

9.24'
A Norway pine, 10 ins. diam., bears S. 86° W., 14 lks. dist.,
mkd. S31 AMC BT.

Land, level and rolling.

Soil, sandy loam and muck.

Timber, spruce, poplar and pine; undergrowth, young timber and alder.

Meanders of Planting Ground Lake.

From the true point for the auxiliary meander cor. on the adjusted meander line and on the left bank of the inlet from Town Line Lake, at angle point No. 1 plus 7.87 chs.

519.42'

With the meanders of Planting Ground Lake in sec. 31 and in front of the public land area.

Along a well defined bank 2 to 6 ft. in height at foot of bluff, through timber and undergrowth.

52.8' 33.0'
N. 5° 39' E., 0.80 chs. At 0.50 chs., leave flowage area.

92.4'
N. 25° 15' W., 1.40 chs.

204.6'
N. 3° 15' E., 3.10 chs.

112.2'
N. 2° 30' W., 1.70 chs.

178.2'
N. 21° 15' E., 2.70 chs.

145.2'
N. 2° 30' E., 2.20 chs.

72.6'
N. 2° 45' W., 1.10 chs.

178.2'
N. 27° 30' W., 2.70 chs.

92.4'
N. 39° 45' E., 1.40 chs.

105.6'
N. 44° 00' W., 1.60 chs.

68.64'
N. 51° 45' W., 1.04 chs.

257.4'
N. 69° 15' W., 3.90 chs.

250.8'
N. 81° 45' W., 3.80 chs.

105.6'
N. 68° 15' W., 1.60 chs.

At end of course, an iron pipe, 2 ins. diam., protruding 18 ins. above the ground, bears S. 1° 30' E., 18 lks. dist.; this pipe is set on the local East 1/16 line of sec. 31.

11039

Survey of Lands Omitted from the Original Survey
in Sec. 31, T. 39 N., R. 11 E.

N. 69° 00' W., 2.10 chs. ^{138.6}
N. 85° 30' W., 1.80 chs. ^{118.8}
S. 81° 00' W., 1.60 chs. ^{105.6}
S. 73° 15' W., 1.50 chs. ^{99.0}
S. 14° 45' W., 2.40 chs. ^{158.4} At end of course, enter gently rolling land.
N. 74° 30' W., 1.70 chs. ^{112.2} At 0.80 chs., boat house, left 10 lks. ^{52.8} ^{6.6} dist.
N. 83° 00' W., 2.64 chs. ^{174.24} At end of course, an iron pipe.
N. 89° 15' W., 0.758 chs. ^{50.83} At end of course, an iron pipe; NW. Farnum and NE. Cole.
S. 86° 30' W., 0.758 chs. ^{50.83} At end of course, an iron pipe; NW. Cole and NE. Loucks.
S. 83° 58' W., 1.38 chs. ^{91.08}
S. 29° 30' W., 0.252 chs. ^{16.43} At end of course, an iron pipe; NW. Loucks and NE. Almgren.
S. 86° 40' W., 2.394 chs. ^{158.00} At end of course, an iron pipe; NW. Almgren and NE. Anderson.
N. 75° 22' W., 1.42 chs. ^{93.72} At end of course, NW. Anderson and NE. Giles; mkd. with iron pipe.
N. 70° 00' W., 1.218 chs. ^{80.39} At end of course, an iron pipe; NW. Giles and NE. Pfitzer.
N. 59° 00' W., 0.351 chs. ^{23.17} At end of course, the auxiliary meander cor. at the NW. cor. of the public land survey.

Land, rolling and gently rolling.

Soil, sandy loam.

Timber, poplar, birch, oak, maple and pine; undergrowth, young timber, hazel and alder.

Meanders of Range Line Lake.

From the meander cor. of secs. 31 and 36, on W. bdy. of Tp. and north shore of Range Line Lake.

With the meanders of Range Line Lake in sec. 31.

Along a well defined bank 2 to 4 ft. in height, through the yard of Evangelic Lutheran Synod resort.

S. 54° 30' E., 4.98 chs. ^{328.68}
S. 29° 30' E., 3.60 chs. ^{237.6} At 1.70 chs., cabin left, 60 lks. dist.; ^{112.2} ^{39.6} 330' at 2.35 chs., cabin left, 50 lks. dist.; ^{155.1} at end of course, cabin, bears N. 47½° E., 30 lks. dist.
S. 14° 15' E., 3.00 chs. ^{198.00} At end of course, cabin left, 40 lks. ^{19.8} ^{26.4} dist.
S. 2° 30' E., 3.30 chs. ^{217.8} At 1.70 chs., cabin left, 90 lks. dist.; ^{112.2} ^{39.6} at 2.63 chs., cabin left, 60 lks. dist. ^{173.53} ^{33.6}

Survey of Lands Omitted from the Original Survey
in Sec. 31, T. 39 N., R. 11 E.

S. 18° 00' W., 2.67 chs.	At 0.30 chs., cabin left, 50 lks. dist.
S. 1° 00' W., 2.60 chs.	At 1.13 chs., fence, bears East; enter timber and undergrowth.
S. 8° 45' E., 3.80 chs.	
S. 10° 15' E., 1.90 chs.	
S. 24° 15' E., 1.40 chs.	
S. 33° 30' E., 3.00 chs.	
S. 27° 00' E., 2.30 chs.	
S. 33° 30' E., 2.70 chs.	
S. 45° 00' E., 2.30 chs.	
S. 37° 15' E., 2.55 chs.	At 1.70 chs., enter swamp. thence along a
N. 59° 00' E., 1.50 chs.	
S. 55° 30' E., 1.25 chs.	
S. 19° 00' W., 2.60 chs.	At 1.00 ch., leave swamp; thence along a beach.
S. 28° 00' W., 1.40 chs.	
S. 34° 45' W., 1.90 chs.	
S. 38° 15' W., 2.00 chs.	
S. 43° 30' W., 4.07 chs.	
S. 52° 30' W., 1.60 chs.	
S. 55° 15' W., 2.00 chs.	
S. 58° 00' W., 2.70 chs.	
S. 66° 15' W., 2.50 chs.	
S. 68° 45' W., 2.06 chs.	The auxiliary meander cor., on the south shore of Range Line Lake and on the adjusted meander line, at 2.10 chs. dist. on the first course.

Land, rolling.

Soil, sandy loam.

Timber, poplar, birch, maple, oak and pine; undergrowth, young timber, hazel and alder.

19
Survey of Lands Omitted from the Original Survey
in Sec. 31, T. 39 N., R. 11 E.

General Description.

The land omitted from the original survey and included in this survey, opposite Planting Ground Lake, is mostly high rolling upland, with some level swampland; the upland reaches approximately 60 ft. above the water level of Planting Ground Lake. The soil is a sandy loam, with some gravel and stone.

The upland supports a coverage crop of poplar, birch, maple, oak, Norway pine and white pine, ranging in size from 4 to 24 ins. diam. The swamp area has a fair stand of spruce, with some tamarack; a small pond lies in this area. Some of the larger pine timber was removed during early logging operations.

A partly improved road crosses the area, and a new road was under construction at the time of this survey. The area has been subdivided into tracts of varying sizes, with several small lots fronting on Planting Ground Lake; the lake front lots have houses on them.

The land omitted from the original survey and included in this survey, opposite Range Line Lake, is mostly high rolling and gently rolling upland, with two areas of level swampland; the upland reaches approximately 40 ft. above the water level of Range Line Lake. The soil is a sandy loam, with some gravel and stone.

The northern part of the area has been cleared for farming but is now grass land; the southern part of the area has a coverage crop of poplar, birch, maple, oak, Norway and white pine on the upland, and the swamp areas have some spruce and tamarack. The timber ranges in size from 4 to 20 ins. diam. Some of the older timber was removed during early logging operations.

The Evangelic Lutheran Synod has a resort in the northern part of the area, opposite lot 2, with six good housekeeping cabins and a private road leading to them. Mrs. Reiter has a resort in lot 4, and a good housekeeping cabin on the area opposite her other cabins. There is an unimproved road leading across the area to the east shore of Range Line Lake.

The formation of the two bodies of land omitted from the original survey and included in this survey is similar in every respect to the adjacent surveyed land. Some of the older stumps on the areas indicate that the trees were well over 100 years old at the time they were cut many years ago.

On the evidence developed, it is concluded that the unsurveyed areas were in existence in 1848, when Wisconsin was admitted into the Union, in 1859, when the township was subdivided, and at all subsequent dates, and therefore have the status of public land.

There are no surface indications of mineral deposits; however the areas are relatively near the iron ore region of upper Michigan.

Each of the subdivisions of public land included in this survey, namely lots 10, 11, 12, 13, and 14, sec. 31, is more than 50% upland in character.

3011

CERTIFICATE OF CADASTRAL ENGINEER

I, Hugh B. Crawford, HEREBY CERTIFY upon honor that, in
pursuance of special instructions bearing date of the 10th day of June, 1952,
Supplemental special instructions 30th July 1952
I have ~~surveyed~~ made the dependent resurvey of section boundaries and survey of
omitted lands in sec. 31, T. 39 N., R. 11 E.,

of the Fourth Principal Meridian, in the State of Wisconsin, which are
represented in the foregoing field notes as having been executed by me and under my direction; and that
said survey has been made in strict conformity with said instructions, the Manual of Instructions for the
Survey of the Public Lands of the United States, and in the specific manner described in the foregoing
field notes.

Denver, Colorado,

March 27, 1953.

Hugh B. Crawford

Cadastral Engineer

CERTIFICATE OF APPROVAL

BUREAU OF LAND MANAGEMENT,

Washington, D. C., NOV 16 1953, 19

The foregoing field notes of the ~~survey of~~ dependent resurvey of section boundaries and
survey of omitted lands in sec. 31, T. 39 N., R. 11 E., 4th Prin. Mer., Wisconsin

executed by Hugh B. Crawford

having been critically examined and found correct, are hereby approved.

(SGD) Donald B. Clement

~~Assistant~~ Chief, Division of Cadastral Engineering.

CERTIFICATE OF TRANSCRIPT

I CERTIFY that the foregoing transcript of the field notes of the above-described surveys in

Wisconsin, is a true copy of the original field notes.

Donald B. Clement

~~Assistant~~ Chief, Division of Cadastral Engineering.