

MAP # **L1532**
 DATE FILED **FEB 04 1998**
 BY
 DESCRIPTION FILED
 ONEIDA CO. SURVEYOR'S OFFICE

DAVEDED SHORES
 Part of
GOV'T. LOT 1
SECTION 28, T38N, R8E

Lot 22
 in the Plat of
DAVEDED SHORES
 Part of
GOV'T. LOT 1
Newbold Township
Oneida County, Wisconsin
 SURVEYOR'S CERTIFICATE

WILDERNESS
SURVEYING, INC.

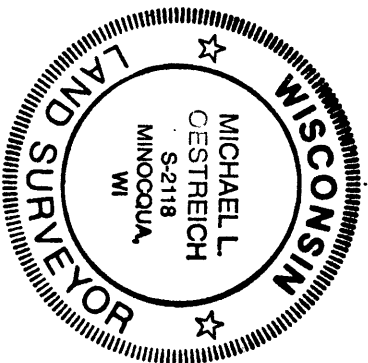

Michael L. Oestreich
 Registered Land Surveyor H S-2118
 Dated this 27th day of September, 1997

LEGEND

- = 2" dia. iron pipe found in place.
- ⊗ = 1 1/4" dia. iron pipe found in place.
- ⊕ = 1" dia. iron pipe found in place.
- = Iron pipe set, 3/4" dia. 24" long.

Map No. 2-28-388
 Drafted by M. Oestreich