

L 2021

SURVEY LANDMARK PRESERVATION RECORD

L 2021

It is the primary purpose of this record to preserve the location of any survey landmark subject to disturbance, removal or to be rendered inaccessible, as provided by Section 59.74(2), Perpetuation of landmarks, Wisconsin revised statutes.

County: ONEIDA	City, Village, Town PELICAN	Section 36	Town T36N	Range R9E
--------------------------	---------------------------------------	----------------------	---------------------	---------------------

Describe survey landmark found or reset and origin if known, such as being a 1/16th corner, called for in a deed or shown on a record land survey map or plat; also note location by gov't. lot 1/4 1/4 section or other PLSS subdivisional tract.

FOUND NOTHING AT THIS LOCATION. SE 1/4 - SE 1/4

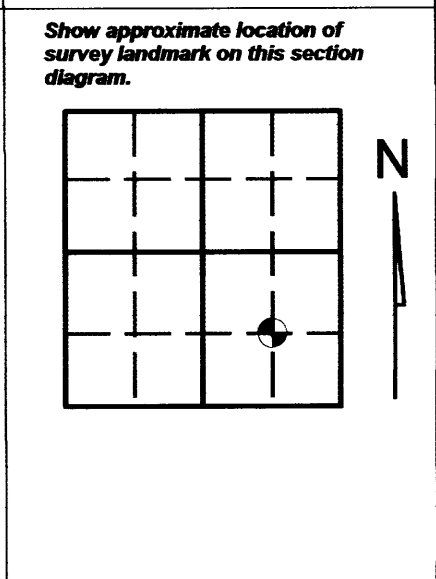

Plan view map of survey landmark location with bearing and distance ties to a minimum of four (4) described witness or reference monuments of concrete, natural stone, metal, live bearing trees or equivalent material and/or by described GPS method and precision.

SCALE: 1"=40'

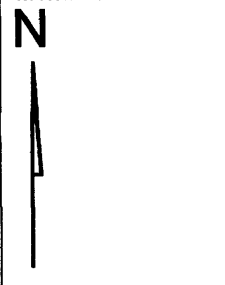

MAP # **L 2021**
 DATE FILED.....**JUL 20 2004**..
 BY...*[Signature]*.....
 DESCRIPTION FILED.....
 ONEIDA CO. SURVEYOR'S OFFICE

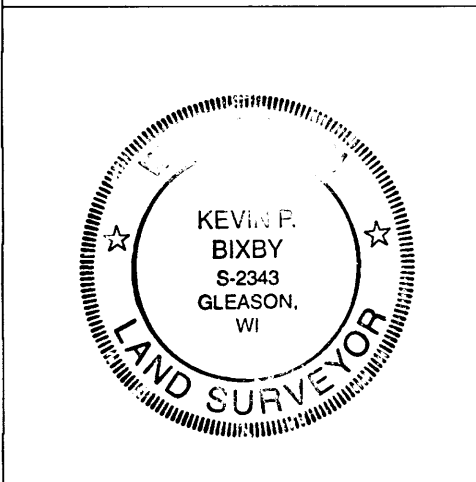

PROFESSIONAL LAND SURVEYOR CERTIFICATE

This survey landmark is being referenced for the express purpose of location preservation and is not intended as an attestation of the legal significance and/or positional accuracy thereof.

Thereof, this survey land mark location should be further evaluated and verified for any future land surveying or related usage purposes.

I, Kevin P. Bixby hereby certify that I am duly licensed as a Professional Land Surveyor in the State of Wisconsin; that the location of this survey landmark was referenced by me or under my direct supervision and/or control; and that the information shown is true and correct to the best of my knowledge and belief.

SIGNED *Kevin P. Bixby* DATE **07/11/04**

REVISED 10/10/02

L 2021

3609 361010 L 2021